

REMONUMENTATION

DEC 12 1997

COMMISSION

LAND CORNER RECORDATION CERTIFICATE
Filing Requirement of Act 74, Mich. P.A. 1970

FILED

Copy

97 AUG 12 AM 11:25

LINDA M. TWITCHELL
REGISTER OF DEEDS
EATON COUNTY, MICH.

LIBER 3 PAGE 78A

Register of Deeds Stamp & File Number

For corners in

EATON Located In: Corner Code #
(County)
KALAMOO TOWNSHIP
1. Public Land Survey T 2N R 6W B-11
T _____ R _____
T _____ R _____
T _____ R _____
2. Property Controlling S _____ T _____ R _____
in Section S _____ T _____ R _____
3. Miscellaneous S _____ T _____ R _____
Property in Sec. S _____ T _____ R _____

4. Lot No. _____, Recorded Plat _____
5. Private Claims _____

I, DAVID R. LOHR, in a field survey on JUNE 5, 19 97 do hereby state that under requirements of P.A. 74, Michigan P.A. of 1970, the corner points mentioned in lines 1 and 2 above were in conformance with regulations and rules therefore as required in the current manual of survey instructions of the United States Department of the Interior, Bureau of Land Management or by a decree of a Court of Law and/or that the corner points mentioned in lines 3, 4 and 5 above were in conformance with the rules of the Michigan Board of Land Surveyors or by a Decree of a Court of Law, established, re-established, monumented, recovered, found as expressed below:

NOTE: Not more than 2 corners, all in the same town and range, may be recorded on this certificate.

A	B	C	D	E	F	G	H	I	J	K	L	M
1												
2	6	5	4	3	2	1						
3												
4	7	8	9	10	11	12						
5												
6	18	17	16	15	14	13						
7												
8	19	20	21	22	23	24						
9												
10	30	29	28	27	26	25						
11	●											
12	31	32	33	34	35	36						
13												

A. Description of original monument and accessories and/or subsequent restoration:

B-11: 1. POST SET BY MUSGROVE EVANS, U.S. DEP. SURVEYOR IN 1826.
WITNESSED BY: TAM 9" N 30 E 12 LKS. (7.92')
" 9" S 33 W 16 LKS. (10.56')
NOTES SHOW DISTANCE EAST OF 40.00 CH. (2640.00')
NOTES SHOW DISTANCE WEST OF 40.51 CH. (2673.66')

CONTINUED ON BACK

B. Description of corner evidence found and/or method applied in restoring or reestablishing corner:

B-11: SEARCHED AT APPARANT LOCATION OF CORNER AND FOUND 1 3/4" PIPE ON FENCE TO NORTH, ALONG WEST BANK OF SMALL OPEN DITCH RUNNING NORTH-SOUTH. LOCATED REMNANTS OF EAST-WEST FENCE ABOUT 200 FEET EAST OF THIS LOCATION AND PROJECTED LINE TO PIPE. THIS IS THE SAME FENCE WHICH LIES ON THE SOUTH SIDE OF THE OLD "WILDT ROAD" ROADBED WHICH ENDS ABOUT 1000 FEET EAST OF THIS LOCATION. PROBED AREA AND FOUND CIRCLE OF STONES WITH REMAINS OF ANCIENT POST 1 FT. SOUTH AND 3 FT. WEST OF PIPE LOCATION.
CONTINUED ON BACK

C. Description of monument for corner and accessories established to perpetuate locating the position of the corner:

B-11: SET 3/4" X 24" STANDARD REMON. BAR AND PA 345 CAP #30090 IN REMAINS OF ANCIENT POST. WITNESSED BY:
SET N/T #30090, E/S 8" MAPLE, N 35 E, 5.15'
SET N/T #30090, S/S 12' ASH, N 84 E, 9.04'
SET N/T #30090, W/S 12" MAPLE, S 06 W, 26.32'
SET N/T #30090, NW/S 12" MAPLE, S 30 W, 32.15'

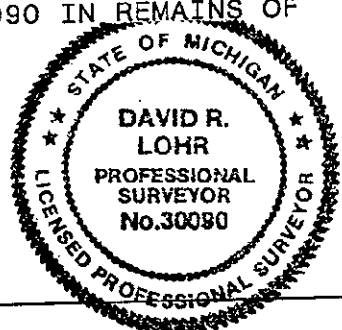

Signed by David R. Lohr
Surveyor's Michigan License No. 30090

Date 7-23-97

LINER 3 11/17 1885

B-11: KALAMO TOWNSHIP - PART A: CONTINUED

2. CORNER REFERENCED IN SURVEY BY OSCAR CHURCH, COUNTY SURVEYOR. DATED SEPT. 26, 1876 AND RECORDED IN VOL. 2 PG. 37, AS "STAKE, IN STONEPILE ?, F.O.S." NO WITNESSES GIVEN. SURVEY SHOWS DISTANCE NORTH OF 41.07 CH. (2710.62') AND DISTANCE WEST OF 45.10 CH. (2976.60')

NOTE: IT APPEARS UNLIKELY THAT EVANS ACTUALLY RAN THE LINE WEST TO A-11 BASED ON THE DIFFERENCE BETWEEN HIS CALLS AND THAT OF CHURCH. EVANS SHOWS 40.51 CH. TO A-11 VS. CHURCH SHOWING 45.10 CH. EVANS SHOWS A CALL OF 24 CH. (1584.0 FT.) ENTERING THE TAM. SWAMP FROM C-11. THIS MATCHES THE EXISTING CONDITIONS, HOWEVER, HIS CALL OF 56.00 CH. (3696.0 FT.) LEAVING THE SWAMP IS ABOUT 300 FT. TO FAR WEST.

3. NO OTHER REFERENCES FOUND.

B-11: KALAMO TOWNSHIP - PART B: CONTINUED

ACCEPTED CIRCLE OF STONES AND POST AS LOCATION OF CORNER AS DESCRIBED BY CHURCH IN 1876. SET 3/4" X 24" STANDARD REMON. BAR AND PA #345 CAP #30090 IN CENTER OF POST REMAINS. TRAVERSED ENTIRE SECTION AND FOUND MEASURED WEST 2976.10 FT. TO A-11 AND EAST 2675.46 FT. TO C-11. MEASURED SOUTH 5271.37 FT. TO B-13.