

DEC 17 1998

FILED

Copy

98 OCT 16 AM 10:26

SECTION

LAND CORNER RECORDATION CERTIFICATE
Filing Requirement of Act 74, Mich. P.A. 1970

For corners in

Eaton	Located In:	Corner Code #
(County)		
Kalamo Township		
1. Public Land Survey	T <u>2N</u> R <u>6W</u>	<u>B-12</u>
	T _____ R _____	_____
	T _____ R _____	_____
	T _____ R _____	_____
2. Property Controlling in Section	S _____ T _____ R _____	_____
	S _____ T _____ R _____	_____
3. Miscellaneous Property in Sec.	S _____ T _____ R _____	_____
	S _____ T _____ R _____	_____

LINDA M. TWITCHELL
REGISTER OF DEEDS
EATON COUNTY, MICH.

LIBER 3 PAGE 953

Register of Deeds Stamp & File Number

4. Lot No. _____, Recorded Plat _____
5. Private Claims _____

I, David R. Lohr, in a field survey on 4/20, 1998 do hereby state that under requirements of P.A. 74, Michigan P.A. of 1970, the corner points mentioned in lines 1 and 2 above were in conformance with regulations and rules therefore as required in the current manual of survey instructions of the United States Department of the Interior, Bureau of Land Management or by a decree of a Court of Law and /or that the corner points mentioned in lines 3, 4 and 5 above were in conformance with the rules of the Michigan Board of Land Surveyors or by a Decree of a Court of Law; established, re-established, monumented, recovered, found as expressed below:

NOTE: Not more than 2 corners, all in the same town and range, may be recorded on this certificate.

	A	B	C	D	E	F	G	H	I	J	K	L	M
1													
2		6		5		4		3		2		1	
3													
4		7		8		9		10		11		12	
5													
6		18		17		16		15		14		13	
7													
8		19		20		21		22		23		24	
9													
10		30		29		28		27		26		25	
11													
12		31		32		33		34		35		36	
13													

A. Description of original monument and accessories and/or subsequent restoration:

- B-12: 1. POST NOT SET IN ORIGINAL GOVERNMENT SURVEY.
- 2. NO OTHER REFERENCES FOUND.

B. Description of corner evidence found and/or method applied in restoring or reestablishing corner:

B-12: TRAVERSED ENTIRE SECTION AND SET CORNER AT INTERSECTION OF QUARTER LINES. CORNER FALLS 5 FT. NORTH OF EAST-WEST FENCELINE, NO OCCUPATION NORTH-SOUTH. MEASURED NORTH 2640.93 FT., EAST 2649.82 FT., SOUTH 2630.44 FT. AND WEST 2970.68 FT. SET 3/4" X 24" STANDARD RE-MON. BAR AND PA 345 CAP STAMPED 30090. NO EXCAVATION PERFORMED, AREA HAS BEEN PLOWED.

C. Description of monument for corner and accessories established to perpetuate locating the position of the corner:

B-12: SET 3/4" X 24" STANDARD REMON. BAR AND PA 345 CAP STAMPED #30090 AT INTERSECTION OF QUARTER LINES, 5 FT. NORTH OF FENCELINE. WITNESSED BY:
SET N/T #30090, S/S 15" ELM, AZ. 100 DEG. 41.10'
SET N/T #30090, SW/S FENCE POST, AZ. 160 DEG. 5.73'
SET N/T #30090, S/S 15" ELM, AZ. 235 DEG., 9.18'
SET N/T #30090, N/S TW. 8" THORN. AZ. 265 DEG. 60.30'

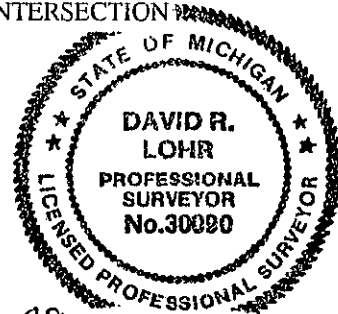

Signed by David R. Lohr
Surveyor's Michigan License No. 30090

Date 9-18-98