

NOV 10 1993

FILED

COMMISSION

LAND CORNER RECORDATION CERTIFICATE

Filing Requirement of Act 74, Mich. P.A. 1970

93 OCT 27 AM 9: 58

For corners in

<u>Eaton</u> (County)	Located in:	Corner Code #
1. Public Land Survey	T <u>3N</u> R <u>3W</u>	<u>G-9</u>
	T _____ R _____	_____
	T _____ R _____	_____
	T _____ R _____	_____
2. Property Controlling in Section	S _____ T _____ R _____	_____
	S _____ T _____ R _____	_____
3. Miscellaneous Property in Sec.	S _____ T _____ R _____	_____
	S _____ T _____ R _____	_____
4. Lot No. _____, Recorded Plat _____		
5. Private Claims _____		

LINDA M. TWITCHELL
REGISTER OF DEEDS
EATON COUNTY, MICH.

Liber 3 Page 311

Register of Deeds Stamp & File Number

I, Larry A. Bryan, in a field survey on August 28, 19 93, do hereby certify that under requirements of P.A. 74, Michigan P.A. of 1970, the corner points mentioned in lines 1 and 2 above were in conformance with regulations and rules therefore as required in the current manual of survey instructions of the United States Department of the Interior, Bureau of Land Management or by a decree of a Court of Law and/or that the corner points mentioned in lines 3, 4 and 5 above were in conformance with the rules of the Michigan Board of Land Surveyors or by a Decree of a Court of Law; established, re-established, monumented, re-monumented, recovered, found as expressed below:

NOTE: Not more than 4 corners, all in the same town and range, may be recorded on this certificate.

A	B	C	D	E	F	G	H	I	J	K	L	M
2	6	5	4	3	2	1						
3												
4	7	8	9	10	11	12						
5												
6	16	17	16	15	14	13						
7												
8	19	20	21	22	23	24						
9												
10	30	29	28	27	26	25						
11												
12	31	32	33	34	35	36						
13												

A. Description of original monument and accessories and/or subsequent restoration:
G-9,

- In 1827, Musgrove Evans, U.S. Deputy Surveyor, Set post cor Secs. 21, 22, 27 & 28
W. Ash 22 N88E 39
Beech 14 S40W 17

(Continued on Back)

B. Description of corner evidence found and/or method applied in restoring or reestablishing corner:

G-9, Investigation at this corner location revealed a 1/2" bar in a monument box 2' South of centerline Vermontville Highway, 2' East centerline Canal Road. The bar checks closely with all the witnesses listed above except one utility pole which appears to have been moved from ±66.5' to ±62.7' distant, it was therefore accepted as the perpetuated location of G-9.

C. Description of monument for corner and accessories established to perpetuate locating the position of the corner:

- G-9, T3N-R3W
Found 1/2" bar in a monument box as noted above
Found nail & tag #11370 Northwest side utility pole, N45°E, 41.59'
Northwest corner house #9026 foundation, S60°E, 131.10'
Set nail & tag #25832 West side 30" Maple, S45°E, 85.65'
Southeast corner house #8951 foundation, N70°W, 261.15'
Found nail and tag Southeast side guy pole, N50°W 62.74'

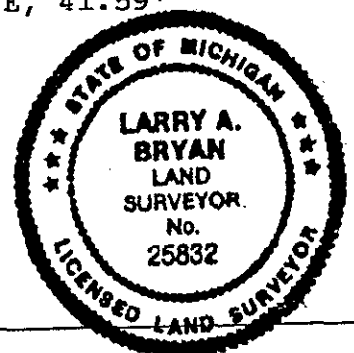

Signed by Larry A. Bryan
Surveyor's Michigan License No. 25832

Date 10-13-93

P.A. 345 EATON COUNTY
PEER APPROVED 9/29/93

PART "A" CONTINUED

2. M.H. Bailey, County Surveyor, recorded corner on March 18th, 1879 (Vol.2 P.78 of County Surveyor Records), as an oak stake with the following witness:
Elm 12 in. S1°W 90.5L

3. James E. Stephens, LS #16053, recorded corner on 10/07/76 in Liber 2 of Corners, Page 365, and on 10/25/76 in Liber 2 of Surveys, Page 187, and on 11/04/76 in Liber 2 of Surveys, Page 197, as having found a 5/8 inch iron rod in a monument box in the centerline of Canal Road and Vermontville Highway with the following witnesses:
R.L.S. 11370 tag on NW side utility pole, N37°34'E 41.70 feet
R.L.S. 11370 tag on SW side of a 22" Maple tree, S41°36'E 85.65 feet
R.L.S. 16053 tag on NE side utility pole, N57°36'W 66.49 feet

4. Richard W. Steadman, LS #11370, recorded corner on 10/15/81 in Liber 2 of Corners, Page 756, as having found a large pointed stone with plow point alongside, and broken brick and tile around, in a field survey in September 1973. Steadman cites an undated marginal note on Page 92 of the Eaton County Road Commission Copy of the Public Land Survey Field Notes which gives Bailey's calls, and also calls for "stone-plow point: 40" Elm S1-1/2°E 76.5 ft., 15" Elm S43°E 47.25 ft., and 12" Elm S55°E 50.75 ft." The found monumentation was raised with a 1/2" iron pipe and cap. On 07/29/81 the County Road Commission placed a 1/2" iron rod and monument box over pipe. Steadman's witnesses taken in 1981 are as follows:
Nail and tag in power pole N40°E 41.75 ft.
Nail and tag in telephone pole N55°W 62.71 ft.
Nail and tag in 24" Maple S41°E 85.60 ft.

5. James E. Stephens, LS #16053, recorded corner on 01/12/87 in Liber 4 of Surveys, Page 226, and on 04/21/89 in Liber 4 of Surveys, Pages 629-630, as having found a 1/2" iron rod in monument box with the following witnesses:
Nail and tag in power pole N40°E 41.75 feet
Nail and tag in telephone pole N55°W 62.71 feet
Nail and tag in 24" Maple S41°E 85.60 feet

6. Larry A. Bryan, LS #25832, recorded corner on 06/27/90 in Liber 5 of Surveys, Pages 28-29, as having found a 1/2" bar in a monument box with the following witnesses:
Found nail & tag #11370 Northwest side power pole, N45°E, 41.61'
Found nail & tag #11370 Southwest side 24" Maple, S45°E, 85.65'
Found nail & tag Southeast side guy pole, N55°W, 62.75'

