

**SURVEY &  
REMONUMENTATION**

APR 27 1995

**COMMISSION**

**LAND CORNER RECORDATION CERTIFICATE  
Filing Requirement of Act 74, Mich. P.A. 1970**

94 NOV 29 AM 8:50

FILED  
Copy

For corners in Benton Twp.

<u>Eaton</u> <small>(County)</small>	Located In:	Corner Code: <u>77</u>
1. Public Land Survey	T <u>3N</u> R <u>4W</u>	K-13
	T _____ R _____	_____
	T _____ R _____	_____
	T _____ R _____	_____
2. Property Controlling in Section	S _____ T _____ R _____	_____
	S _____ T _____ R _____	_____
3. Miscellaneous Property in Sec.	S _____ T _____ R _____	_____
	S _____ T _____ R _____	_____
4. Lot No. _____, Recorded Plat _____		
5. Private Claims _____		

LINDA M. TWITCHELL  
REGISTER OF DEEDS  
EATON COUNTY, MICH.

WBER 3 Pg 519  
Register of Deeds Stamp & File Number

	A	B	C	D	E	F	G	H	I	J	K	L	M
2	6	5	4	3	2	1							
3													
4	7	8	9	10	11	12							
5													
6	18	17	16	15	14	13							
7													
8	19	20	21	22	23	24							
9													
10	30	29	28	27	26	25							
11													
12	31	32	33	34	35	36							
13													

I, Larry A. Bryan in a field survey on September 29, 19 94, do hereby certify that under requirements of P.A. 74, Michigan P.A. of 1970, the corner points mentioned in lines 1 and 2 above were in conformance with regulations and rules therefore as required in the current manual of survey instructions of the United States Department of the Interior, Bureau of Land Management or by a decree of a Court of Law and/or that the corner points mentioned in lines 3, 4 and 5 above were in conformance with the rules of the Michigan Board of Land Surveyors or by a Decree of a Court of Law; established, re-established, monumented, re-monumented, recovered, found as expressed below:

NOTE: Not more than 4 corners, all in the same town and range, may be recorded on this certificate.

A. Description of original monument and accessories and/or subsequent restoration:  
K-13,

1. Post set in Original Government Survey by J. Mullett, Deputy Surveyor, on May 24, 1826, Beech 18 N62°W 34, Beech 18 N80°E 27.

2. Corner identified in a survey by J.H. Gibbons, County Surveyor, no date given (vol. 1, page 1 County Surveyor Records) and identified as a stone with cross, crockery and iron, no witnesses given.

(Continued on Back)

B. Description of corner evidence found and/or method applied in restoring or reestablishing corner:

K-13, Investigation at this corner revealed a 1/2" bar in monument box in centerline of Kinsel Highway ±9.0' West of Centerline of Hartel Road and 5.95' West of K-1 Eaton Rapids Township. Found 36" Maple Southeast 74.95' and Northeast corner school house Southwest 109.43' that agree closely with witnesses listed in item #4 and #5, and power poles Northeast 69.37' and Southwest 49.27' from item #5. This area excavated by Richard W. Steadman on January 22, 1974 as noted in item #5 and no further excavation was done. Accepted position of 1/2" bar in monument box as the perpetuated location of K-13 and placed cap stamped P.A. 345 #25832 over 1/2" bar.

C. Description of monument for corner and accessories established to perpetuate locating the position of the corner:

K-13, T3N-R4W  
Found 1/2" bar in monument box and placed cap stamped P.A. 345 #25832 over bar.  
Found nail & tag #11370 in Southwest side 36" Maple, S70°E, 74.95'.  
Found nail & tag #11370 in Northeast side power pole, N40°E, 69.37'.  
Found nail & tag #11370 in East side power pole, S45°W, 49.27'.  
Northeast corner school house, S45°W, 109.43'.  
Found 1/2" bar, K-1, T2N, R4W, Eaton Township, East 5.94'.

Signed by Larry A. Bryan  
Surveyor's Michigan License No. 25832

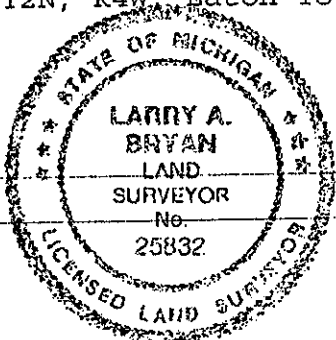

28-94

FORM APPROVED BY MICHIGAN STATE BOARD OF LAND SURVEYORS, JAN. 28, 1971  
REVISED MAY 14, 1975  
REVISED JAN., 1983  
P.A. 345 EATON COUNTY  
REGISTER APPROVED 10/20/94

PART "A" CONTINUED

LIBER 3

3. Corner identified in a survey by O.G. Church, County Surveyor, in 1876 (vol. 2, page 24 and 25 County Surveyor Records) and identified as a stone with no witnesses given.

4. Corner identified in a marginal note in the Eaton County Road Commissions copy of the Original Government Survey notes by H.A. Williams in 1917 as "stone, Anc. Post N44°W 36', NE. Cor. School S42°W 109', S. Maple S64°E 76'".

5. Richard W. Steadman, P.S. #11370, recorded corner on 01/22/74 in Liber 1 of Corners, Page 366, as "Dug in interseciton of Hartel Rd. and Kinsel Hwy. and found large flat top stone with cross on it, a 6" square piece of metal below, and broken crockery around it".

Witnessed by:

Nail & tag in 30" Maple S.E. 76.14 ft.

N.E. corner of school S.W. 109.43 ft.

Nail & tag in power pole N.E. 69.39 ft.

Nail & tag in power pole S.W. 49.29 ft.

6. Corner shown on a survey by Ronnie M. Lester P.S. #18998 dated April 24, 1980, and recorded in Liber 3 of Surveys, Page 161 and 162, as having found 3/4" bar in monument box 5.94 feet West of K-1, Northwest corner Section 1, T2 R4W, Eaton Township, Eaton County, Michigan, no witnesses given.

7. Corner referred to by Kay Don Fluke P.S. #18988 on May 30, 1990 and recorded in Liber 3 of Corners, Page 191, Eaton County Records as having found 1/2" bar 5.94 feet West of K-1, Northwest corner Section 1, T2N, R4W, Eaton Township, Eaton County, Michigan, no witnesses given.