

**SURVEY & REMONUMENTATION**

DEC 16 1996

COMMISSION

**LAND CORNER RECORDATION CERTIFICATE**  
Filing Requirement of Act 74, Mich. P.A. 1970

96 DEC -6 AM 8:35

Benton Township  
For corners in  
Eaton

	Located In:	Corner Code #
1. Public Land Survey	T <u>3N</u> R <u>4W</u>	<u>L-11</u>
	T _____ R _____	_____
	T _____ R _____	_____
	T _____ R _____	_____
2. Property Controlling in Section	S _____ T _____ R _____	_____
	S _____ T _____ R _____	_____
3. Miscellaneous Property in Sec.	S _____ T _____ R _____	_____
	S _____ T _____ R _____	_____

LINDA M. TWITCHELL  
REGISTER OF DEEDS  
EATON COUNTY, MICH.

LIBER 3 Pg 765

Register of Deeds Stamp & File Number

4. Lot No. \_\_\_\_\_, Recorded Plat \_\_\_\_\_  
5. Private Claims \_\_\_\_\_

I, Larry A. Bryan, in a field survey on October 5, 19 96 do hereby state that under requirements of P.A. 74, Michigan P.A. of 1970, the corner points mentioned in lines 1 and 2 above were in conformance with regulations and rules therefore as required in the current manual of survey instructions of the United States Department of the Interior, Bureau of Land Management or by a decree of a Court of Law and/or that the corner points mentioned in lines 3, 4 and 5 above were in conformance with the rules of the Michigan Board of Land Surveyors or by a Decree of a Court of Law; established, re-established, monumented, recovered, found as expressed below:

NOTE: Not more than 2 corners, all in the same town and range, may be recorded on this certificate.

	A	B	C	D	E	F	G	H	I	J	K	L	M
1													
2	6		5		4		3		2		1		
3													
4	7		8		9		10		11		12		
5													
6	18		17		16		15		14		13		
7													
8	19		20		21		22		23		24		
9													
10	30		29		28		27		26		25		
11													
12	31		32		33		34		35		36		
13													

A. Description of original monument and accessories and/or subsequent restoration:

L-11, T3N, R4W

1. Post set at ave. dist. on true line in Original Government Survey by Orange Risdon, Deputy Surveyor, in March 1827, B. Ash 12 N33°W 07, B. Ash 14, S71°E 20.

2. Corner identified in a survey by O.G. Church, County Surveyor, on March 23, 1876 (vol. 2, page 24 and 25 County Surveyor Records) as a "stake from original survey and roots of witness tree", with no new witnesses given.

3. Corner identified in a survey by O.G. Church, County Surveyor, on March 27, 1876 (vol. 2, page 26 and 27 County Surveyor Records) referencing item #2.

B. Description of corner evidence found and/or method applied in restoring or reestablishing corner:

L-11, Investigation at this corner revealed an anchor post with fence running North, South and East and a boat spike 4 feet West and 6.6 feet North of the anchor post. Excavated area 3 feet by 3 feet around anchor post and boat spike but found no definite monumentation for corner. Set 3/4" X 24" bar with cap stamped P.A. 354 #25832 at base of anchor post. A traverse was completed around the the South 1/2 of Section 25 with the following results:

	West 1/2	East 1/2
G.L.O.	2625.48'	2625.48'
County Surveyor	2627.46'	2628.12'
Meas.	2629.86'	2627.57' to 3/4" x 24" bar with cap P.A. 354 #25832

Accepted anchor post as the best location for L-11, T3N, R4W and left 3/4" x 24" bar with cap at base for corner.

C. Description of monument for corner and accessories established to perpetuate locating the position of the corner:

L-11, T3N-R4W

Set 3/4" X 24" bar with cap stamped P.A. 354 #25832 at base of anchor post.

Found boat spike, N40°W, 8.65'.

Found nail & tag #25832 in Southeast side 8" Ash, N25°E, 14.62'.

Found nail & tag #25832 in East side 14" Cherry, South 1.98'.

Found nail & tag #25832 in North side 4" Ash, N45°W, 12.96'.

Set nail & tag #25832 South side 6" Ash, S80°E, 36.24'.

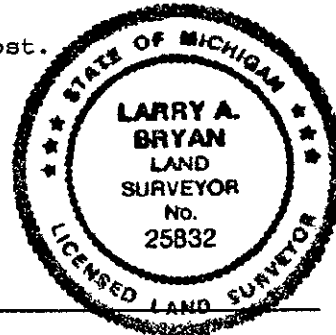

Signed by Larry A. Bryan  
Surveyor's Michigan License No. 25832

Date 10-16-96