

FEB 22 1996

FILED

copy

95 DEC -4 PM 4: 11

LAND CORNER RECORDATION CERTIFICATE
Filing Requirement of Act 74, Mich. P.A. 1970

of corners in Benton Twp.

LINDA M. TWITCHELL
REGISTER OF DEEDS
EATON COUNTY, MICH.

<u>Eaton</u> (County)	Located In:	Corner Code #:
Public Land Survey	T <u>3N</u> R <u>4W</u>	<u>L-13</u>
	T _____ R _____	
	T _____ R _____	
	T _____ R _____	
Property Controlling in Section	S _____ T _____ R _____	
Miscellaneous Property in Sec.	S _____ T _____ R _____	

Register of Deeds Stamp & File Number

FILE 9-13

Lot No. _____, Recorded Plat _____
Private Claims _____

A	B	C	D	E	F	G	H	I	J	K	L	M
2	6	5	4	3	2	1						
3												
4	7	8	9	10	11	12						
5												
6	18	17	16	15	14	13						
7												
8	19	20	21	22	23	24						
9												
10	30	29	28	27	26	25						
11												
12	31	32	33	34	35	36						
13												

Larry A. Bryan, in a field survey on October 9, 19 95,
do hereby certify that under requirements of P.A. 74, Michigan P.A. of 1970, the corner points mentioned
in lines 1 and 2 above were in conformance with regulations and rules therefore as required in the
current manual of survey instructions of the United States Department of the Interior, Bureau of Land
Management or by a decree of a Court of Law and/or that the corner points mentioned in lines 3, 4 and 5
above were in conformance with the rules of the Michigan Board of Land Surveyors or by a Decree of a
Court of Law; established, re-established, monumented, re-monumented, recovered, found as
expressed below:

NOTE: Not more than 4 corners, all in the same town and range, may be recorded
on this certificate.

Description of original monument and accessories and/or subsequent restoration:
L-13,

1. Post set in Original Government Survey by J. Mullett, Deputy Surveyor, on May 24, 1826, Beech 18 N59°W 06, Beech 18 N51°E 46.
2. Corner identified in a survey by O.G. Church, County Surveyor, in 1876 (vol. 2, page 24 and 25 County Surveyor Records) and identified as a stone with no witnesses given.

(Continued on Back)

Description of corner evidence found and/or method applied in restoring or reestablishing corner:
L-13, Investigation at this corner revealed a 1/2" bar 3.0 feet South of the centerline of Kinsel Highway on fence line South. Found nail & tag #25832 in 22" Walnut, South, 20.50' and in 22" Walnut, S40°W, 44.40 feet from item #5, which matches two of the witnesses listed in item #3. Recorded distances between L-13 and M-13 from item #2 meas. 2640.00 feet, from item #4 meas. 2647.13 feet and from item #5 meas. 2646.02 feet. This area was excavated by Marvin F. Fouty in 1974 and no further excavation was done. On 10-9-95 excavated area 2.0' x 5.0' along centerline of Kinsel Highway, on Section line and in a location proportional for L-13 from item #2.

Continued on back.

Description of monument for corner and accessories established to perpetuate locating the position of the corner:

- L-13, T3N-R4W
Set 3/4" bar and cap stamped P.A. 345 #25832 6 inches below gravel surface.
Found nail & tag #25832 in West side 22" Walnut, South 20.35'.
Found nail & tag #25832 in North side 22" Walnut, S40°W, 48.85'.
Set nail & tag #25832 in West side 8" Twin Elm, N05°E, 28.75'.
Set nail & tag #25832 in North side power pole, S80°E, 129.92'.

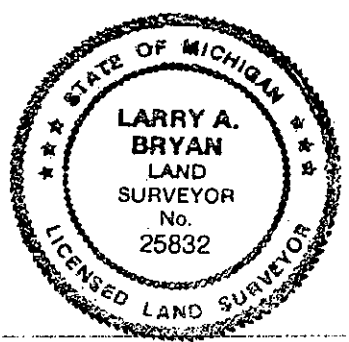

Signed by Larry A. Bryan Date 11-7-95
Surveyor's Michigan License No. 25832

P.A. 345 EATON COUNTY
PEER APPROVED 11/7/95 M

PART "A" CONTINUED

3. Marvin F. Fouty, P.S. #18989, recorded corner on 02/10/74 in Liber 2 of Corners, Page 99, stating Found 5/8" pinched pipe at corner. Excavated large area looking for stone noted in item #2, but found nothing. Replaced pinch pipe and accepted as corner. Witnessed by:
Found P.K. nail West side 18" Black Walnut, South 20.80'
Found P.K. nail West side 18" Black Walnut, SSW 44.47'
Found P.K. nail West side P.P., NW 77.14'

4. Corner shown on a survey by Marvin F. Fouty P.S. #18989, dated October 8, 1973, and recorded in Liber 1 of Surveys, Page 620 and 621 Eaton County Records, with the same monument and witnesses listed in item #3.

5. Corner shown on a survey by Larry A. Bryan P.S. #25832, dated September 14, 1983, and recorded in Liber 5 of Surveys, Page 181 and 182 Eaton County Records, as having found 1/2" bar in centerline Kinsel Hwy. Witnessed by:
Set nail and tag in West side 20" Walnut, South, 20.80 feet.
Set nail and tag in West side 20" Walnut, S40°W, 44.47 feet.
Set nail and tag in Power pole, N45°W, 77.14 feet.

PART "B" CONTINUED

Found 0.5' diameter pointed black stone inside circle of stones all embedded in black clay ±1.0 below road surface. Distances West to K-13 meas. 2647.14 feet, County Surveyor 2641.32 feet proportional 2646.16 and East to M-13 meas. 2643.86 feet, County Surveyor 2640.00 feet proportional 2644.84. Accepted position of stone as the monument set in the location of L-13 Benton Township set by O.G. Church from item #2, and replaced with 3/4" bar and cap stamped P.A. 345 #25832 6 inches below gravel surface. Corner falls 1.0' South of Section line between K-13 and M-13 and 2.0' North and 1.6' East of 1/2" bar noted in items #3, #4 and #5.