

FILED  
copy

APR 27 1995

**COMMISSION**

**LAND CORNER RECORDATION CERTIFICATE**  
Filing Requirement of Act 74, Mich. P.A. 1970  
**CHESTER TOWNSHIP**

94 DEC -1 AM 9:40

For corners in

| <u>EATON</u><br>(County)           | Located In: | Corner Code # |
|------------------------------------|-------------|---------------|
| 1. Public Land Survey              | T 3N R 5W   | E-2           |
|                                    | T R         |               |
|                                    | T R         |               |
|                                    | T R         |               |
| 2. Property Controlling in Section | S T R       |               |
|                                    | S T R       |               |
| 3. Miscellaneous Property in Sec.  | S T R       |               |
|                                    | S T R       |               |

LINDA M. TWITCHELL  
REGISTER OF DEEDS  
EATON COUNTY, MICH.

LIBER 3 Pg 550

Register of Deeds Stamp & File Number

4. Lot No. \_\_\_\_\_, Recorded Plat \_\_\_\_\_  
5. Private Claims \_\_\_\_\_

|    | A  | B | C | D  | E  | F | G  | H | I | J  | K | L | I  |
|----|----|---|---|----|----|---|----|---|---|----|---|---|----|
| 2  | 6  |   |   | 5  | 4  |   | 3  |   |   | 2  |   |   |    |
| 3  |    |   |   |    |    |   |    |   |   |    |   |   |    |
| 4  | 7  |   |   | 8  | 9  |   | 10 |   |   | 11 |   |   | 12 |
| 5  |    |   |   |    |    |   |    |   |   |    |   |   |    |
| 6  | 18 |   |   | 17 | 16 |   | 15 |   |   | 14 |   |   | 13 |
| 7  |    |   |   |    |    |   |    |   |   |    |   |   |    |
| 8  | 19 |   |   | 20 | 21 |   | 22 |   |   | 23 |   |   | 24 |
| 9  |    |   |   |    |    |   |    |   |   |    |   |   |    |
| 10 | 30 |   |   | 29 | 28 |   | 27 |   |   | 26 |   |   | 25 |
| 11 |    |   |   |    |    |   |    |   |   |    |   |   |    |
| 12 | 31 |   |   | 32 | 33 |   | 34 |   |   | 35 |   |   | 36 |
| 13 |    |   |   |    |    |   |    |   |   |    |   |   |    |

I, Maurice H. Mahieu, in a field survey on October 4, 1994, do hereby certify that under requirements of P.A. 74, Michigan P.A. of 1970, the corner points mentioned in lines 1 and 2 above were in conformance with regulations and rules therefore as required in the current manual of survey instructions of the United States Department of the Interior, Bureau of Land Management or by a decree of a Court of Law and/or that the corner points mentioned in lines 3, 4 and 5 above were in conformance with the rules of the Michigan Board of Land Surveyors or by a Decree of a Court of Law; established, re-established, monumented, re-monumented, recovered, found as expressed below:

**NOTE: Not more than 4 corners, all in the same town and range, may be recorded on this certificate.**

**A. Description of original monument and accessories and/or subsequent restoration:**

- Original GLO survey by Orange Risdon in March 1827 indicates 1/4 section post set at a distance of 40.00 chains from E-3. Witnessed by: 14" Beech S35E 6 links  
20" Beech N26W 36 links
- Side note on GLO notes, assumed to be County surveyor notes, states long stone witnessed by:  
B. Walnut N 56 1/2 deg. E 11'

(Over)

**B. Description of corner evidence found and/or method applied in restoring or reestablishing corner:**

Found 1/2" iron rod with cap #25832 (L. Bryan) in North-South fenceline; also found Nail & Tag #25832 North Side 24" Bitternut (noted as 15" Ash in A-3 and A-4) East 22.90 feet. Found 12" Walnut N 10 deg. E 12 feet ± and 12" Walnut S 15 deg. E 16' ± (noted as both being Ash Trees). Found 2' diameter rotten stump to the E.N.E. Assumed to be B. Walnut of A-2. Measured W.S.W. 11' and excavated 3' dia. hole. Found long circular stone surrounded by smaller stones 4" below grade. Center of stone measures 11 feet to face of rotten stump. Removed stone and set 3/4" x 24" standard iron rod w/cap #28414 PA 345. Rod falls 1'± West of North-South fenceline. This surveyor feels that the stone is the stone set by the county surveyor and the iron that replaced the stone is the perpetuation of the corner. Performed traverse and measured North 2,191.54 feet to E-1, East 2,641.11 feet to F-2 and South 2,644.97 feet to E-3.

**C. Description of monument for corner and accessories established to perpetuate locating the position of the corner:**

Set 3/4" x 24" iron rod with cap #28414 PA 345, witnessed by:  
Set Nail and Tag #28414 South side of 24" Bitternut, East 23.97 feet  
Set Nail and Tag #28414 West side 12" Walnut, S 10 deg. E 14.69 feet  
Set Nail and Tag #28414 West side Wood Post, N 10 deg. E 5.44 feet  
Set Nail and Tag #28414 West side Triple Sycamore, S 25 deg. E 44.50 feet  
1/2" Iron Rod with Cap #25832, N 15 deg. E 2.00 feet

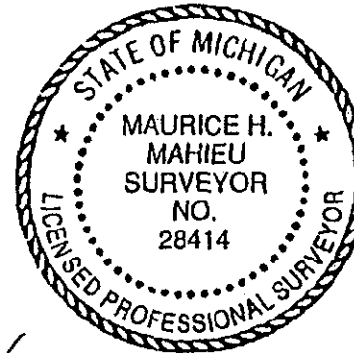

Signed by Maurice H. Mahieu Date 11-29-94  
#28414  
Surveyor's Michigan License No. \_\_\_\_\_

(Continued)

3. LCRC was recorded on March 12, 1985 by Larry Bryan, Land Surveyor #25832 (L-2, P-351). Set 1/2" bar and cap using single proportionate measurement in North and South fence line in close accord with County Surveyor and GLO measurements. Witnessed by:  
Nail and Tag East side 6" Ash, N 10 deg. E 11.90 feet  
Nail and Tag North side 15" Ash, East 22.90 feet  
Nail and Tag West side 6" Ash, S 15 deg. E 16.30 feet
  
4. Corner referred to in an Act 132 survey done by Bryan Land Surveys (L-5, P-222). May 4, 82  
Set 1/2" bar and cap in North-South fence line.  
Nail and Tag East side 6" Ash, N 10 deg. E 11.90 feet  
Nail and Tag North side 15" Ash, East 22.90'