

**SURVEY &
REMONUMENTATION**

APR 27 1995

LAND CORNER RECORDATION CERTIFICATE
Filing Requirement of Act 74, Mich. P.A. 1970
CHESTER TOWNSHIP

For corners in **COMMISSION**

FILED

copy

94 DEC -1 AM 9:41

<u>EATON</u> (County)	Located In:	Corner Code =#
1. Public Land Survey	T 3N R 5W	E-1
	T _____ R _____	_____
	T _____ R _____	_____
	T _____ R _____	_____
2. Property Controlling in Section	S _____ T _____ R _____	_____
	S _____ T _____ R _____	_____
3. Miscellaneous Property in Sec.	S _____ T _____ R _____	_____
	S _____ T _____ R _____	_____
4. Lot No. _____, Recorded Plat _____		
5. Private Claims _____		

LINDA M. TWITCHELL
REGISTER OF DEEDS
EATON COUNTY, MICH.

LIBER 3 Pg 557

Register of Deeds Stamp & File Number

I, Maurice H. Mahieu, in a field survey on October 28, 1994, do hereby certify that under requirements of P.A. 74, Michigan P.A. of 1970, the corner points mentioned in lines 1 and 2 above were in conformance with regulations and rules therefore as required in the current manual of survey instructions of the United States Department of the Interior, Bureau of Land Management or by a decree of a Court of Law and/or that the corner points mentioned in lines 3, 4 and 5 above were in conformance with the rules of the Michigan Board of Land Surveyors or by a Decree of a Court of Law; established, re-established, monumented, re-monumented, recovered, found as expressed below:

	A	B	C	D	E	F	G	H	I	J	K	L
2	6		5		4		3		2			
3												
4	7		8		9		10		11		12	
5												
6	18		17		16		15		14		13	
7												
8	19		20		21		22		23		24	
9												
10	30		29		28		27		26		25	
11												
12	31		32		33		34		35		36	
13												

NOTE: Not more than 4 corners, all in the same town and range, may be recorded on this certificate.

A. Description of original monument and accessories and/or subsequent restoration:
1. Corner was not set in original government survey.

2. Recorded in LCRC January 15, 1974 by James Stephens, PS #16053 (L-2, P-72). A "T" bar was set in centerline of Needmore Highway and midway between Northeast and Northwest Corners of Section 4, and on a line between S 1/4 Corner and SE 1/4 Corner of Section 33, T4N, R5W, Roxand Township. Witnessed by:
Tag South side 38" Cherry, N 61 deg. 06' W 60.97'
Tag North side 20" Maple, S 75 deg. 13' W 95.21'
Survey tag of Fred Whites NE side 30" Oak, S 82 deg. 05' W 184.38' (Over)

B. Description of corner evidence found and/or method applied in restoring or reestablishing corner:

Found 1/2" iron rod 4" below gravel road surface. Found J. Stephens P.S. #16053 tag in South side 38" Cherry (actually twin 24" Cherry), N 61 deg. W 60.70 feet. 20" Maple tree no longer standing. Found 30" Oak Fred White witnessed, at S 82 deg. W 184.5'±. Excavated 4' x 4' hole at an average depth of 18" to hard dark grey clay. Found no other evidence. Replaced 1/2" iron rod with standard 3/4" x 24" iron rod with cap #28414 PA 345. This surveyor accepts the position of the 1/2" iron rod and subsequent 3/4" rod based on the method of setting the 1/2" rod by Stephens. Performed traverse and measured West 2,645.26 feet to E-1 and East 2,645.57 feet to G-1.

C. Description of monument for corner and accessories established to perpetuate locating the position of the corner:

Set 3/4" x 24" iron rod with cap #28414 PA 345, witnessed by:
Set Nail and Tag #28414 South side 12" Maple, N 60 deg. E 47.88 feet
Set Nail and Tag #28414 East side 32" Cherry, N 23 deg. W 30.62 feet
Set Nail and Tag #28414 South side Triple 10" Maple, N 59 deg. W 40.65 feet
Set Nail and Tag #28414 South side Twin 24" Cherry, N 61 deg. W 60.78 feet
West 131.53 feet to South 1/4 Corner of Section 33, Roxand

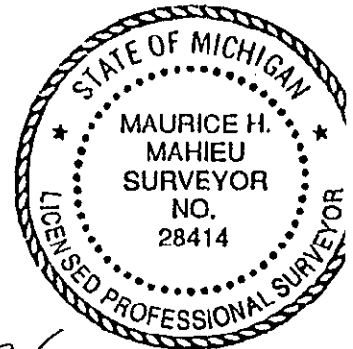

Signed by Maurice H. Mahieu Date 11-29-94
Surveyor's Michigan License No. #28414

FORM APPROVED BY MICHIGAN STATE BOARD OF LAND SURVEYORS, JAN. 20, REVISED MAY 14, REVISED JAN.,
P.A. 345 EATON COUNTY
PEER APPROVED 11/23/94 M

LIBER 3. Pg 558

(Continued)

3. Corner referred to in Act 132 survey done by Bryan Land Surveys (L-5, P-222). Set 1/2" bar in centerline of road from Liber 2, Page 72. Witnessed by:
Found Stephens Nail and Tag North side 24" Maple, S 80 deg. W 94.94'
Found Stephens Nail and Tag South side 15" Wild Cherry, N 70 deg. W 60.70'
4. Corner referred to in a survey done in October 1982 by Fred White, PS #12034 (L-3, P-497). No mention of monumentation or witnesses.