

SURVEY & REMONUMENTATION

FILED

copy

APR 27 1995

LAND CORNER RECORDATION CERTIFICATE
 Filing Requirement of Act 74, Mich. P.A. 1970
 CHESTER TOWNSHIP

94 DEC -1 AM 9:43

For corners in **COMMISSION**
EATON
 (County)

Located In:	Corner Code =#
1. Public Land Survey T 3N-- R 5W--	--- G-2 ---
T --- R ---	_____
T --- R ---	_____
T --- R ---	_____
2. Property Controlling S --- T --- R ---	_____
in Section S --- T --- R ---	_____
3. Miscellaneous S --- T --- R ---	_____
Property in Sec. S --- T --- R ---	_____

LINDA M. TWITCHELL
 REGISTER OF DEEDS
 EATON COUNTY, MICH.

LIBER 3 Pg 566

Register of Deeds Stamp & File Number

4. Lot No. _____, Recorded Plat _____
 5. Private Claims _____

	A	B	C	D	E	F	G	H	I	J	K	L	M
2	6	5	4	3	2	1							
3													
4	7	8	9	10	11	12							
5													
6	18	17	16	15	14	13							
7													
8	19	20	21	22	23	24							
9													
10	30	29	28	27	26	25							
11													
12	31	32	33	34	35	36							
13													

I, Maurice H. Mahieu, in a field survey on October 27, 19 94, do hereby certify that under requirements of P.A. 74, Michigan P.A. of 1970, the corner points mentioned in lines 1 and 2 above were in conformance with regulations and rules therefore as required in the current manual of survey instructions of the United States Department of the Interior, Bureau of Land Management or by a decree of a Court of Law and/or that the corner points mentioned in lines 3, 4 and 5 above were in conformance with the rules of the Michigan Board of Land Surveyors or by a Decree of a Court of Law; established, re-established, monumented, re-monumented, recovered, found as expressed below:

NOTE: Not more than 4 corners, all in the same town and range, may be recorded on this certificate.

- A. Description of original monument and accessories and/or subsequent restoration:
1. Original GLO survey by Orange Risdon in March 1827 indicate 1/4 post set at a distance of 40.00 chains.
 Witnessed by:
 12" Elm, N88 deg. E 11 links
 16" W. Maple, S 89 deg. E 27 links
 2. County surveyor replaced post with long stone based on marginal notes on GLO records. No witnesses given.

(Over)

B. Description of corner evidence found and/or method applied in restoring or reestablishing corner:

Found 1/2" iron rod in monument box. Iron falls in centerline of Muliken Highway. Found 4 witnesses by James Stephens PS #16053; Nail and Tag South side 15" Ash N 60 deg. W 44.54 feet; Nail and Tag West side Utility Pole N 45 deg. E 58.97 feet; Nail and Tag South side 10" Ash West 44.80 feet; Nail and Tag East side 10" Elm S 3 deg. W 59.55 feet. Iron falls in line with fence line to West. Excavated 4' x 4' hole at an average depth of 3 feet deep to undisturbed dark grey clay. Found no other evidence. Set standard 3/4" x 24" iron rod with cap #28414 PA 345 in location of 1/2" iron rod. Placed monument box over 3/4" iron rod. This surveyor accepts location of 1/2" rod based on method of placement by Fluke as the best perpetuated location of the corner. Performed traverse and measured North 2,227.41 feet to G-1 and 2,649.38 feet to G-3.

C. Description of monument for corner and accessories established to perpetuate locating the position of the corner:

Set 3/4" x 24" iron rod with cap #28414 PA 345, witnessed by:
 Found Nail and Tag #16053 West side Utility Pole, N 45 deg. E 58.88 feet
 Found Nail and Tag #16053 East side 10" Elm, S 30 deg. W 59.51 feet
 Found Nail and Tag #16053 South side 15" Ash, N 60 deg. W 44.56 feet
 Found Nail and Tag #16053 South side 10" Ash, West 44.78 feet

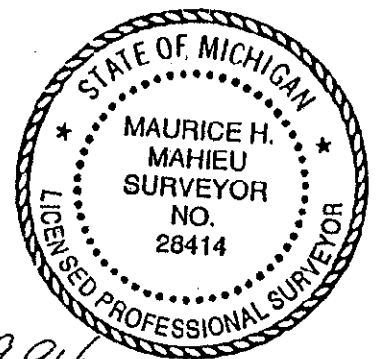

Signed by Maurice H. Mahieu Date 11-29-94
 Surveyor's Michigan License No. #28414

(Continued)

LIBER 3 Pg 557

3. Corner recorded in LCRC dated May 17, 1976 by Kay Don Fluke, PS #18988 (L-2, P-351). Set 1/2" rod with RLS cap #18988 on line between G-1 and G-3 proportionate to GLO distances, in bit. surface of Mulliken Road. Witnessed by:
 - 6" Oak, NE 48.80'
 - 18" Twin Oak, WNW 57.75'
 - 6" Ash, NW 70.70'

4. Unrecorded survey by K. Don Fluke, PS #18988 dated April 30, 1976. No monumentation noted but witnesses:
 - Northeast 48.40' Nail and Tag South side 6" Oak
 - West-Northwest 57.74' Tag and Nail NE side 18" Oak
 - Northwest 70.70' Tag & Nail, NE side 6" Ash

5. Corner referred to in an Act 132 survey done by Bryan Land Surveyors (L-5, P-221), dated 5-4-82. Found 1/2" bar in monument box as described in Liber 2, Page 351. Witnessed by:
 - Found Nail South side 6" Ash, N 50 deg. E 48.80'
 - Found Nail and Tag RLS #18988 East side 15" Maple, N 50 deg. W 57.75'
 - Set Nail and Tag West side 10" Ash, N 15 deg. E 213.75'