

**SURVEY &
REMONUMENTATION**

APR 27 1995

LAND CORNER RECORDATION CERTIFICATE
Filing Requirement of Act 74, Mich. P.A. 1970
CHESTER TOWNSHIP

FILED
copy
94 DEC -1 AM 9:44

For corners in **COMMISSION**

EATON

(County)

Located In:

Corner Code =//

- | | | |
|---------------------------------------|-------------------|-------|
| 1. Public Land Survey | T 3N.. R 5W.. | G-4 |
| | T ___ R ___ | _____ |
| | T ___ R ___ | _____ |
| | T ___ R ___ | _____ |
| 2. Property Controlling in Section | S ___ T ___ R ___ | _____ |
| | S ___ T ___ R ___ | _____ |
| 3. Miscellaneous Property in Sec. | S ___ T ___ R ___ | _____ |
| | S ___ T ___ R ___ | _____ |
| 4. Lot No. _____, Recorded Plat _____ | | |
| 5. Private Claims _____ | | |

LINDA M. TWITCHELL
REGISTER OF DEEDS
EATON COUNTY, MICH.

LIBER 3 Pg 570

Register of Deeds Stamp & File Number

I, Maurice H. Mahieu, in a field survey on October 27, 1994, do hereby certify that under requirements of P.A. 74, Michigan P.A. of 1970, the corner points mentioned in lines 1 and 2 above were in conformance with regulations and rules therefore as required in the current manual of survey instructions of the United States Department of the Interior, Bureau of Land Management or by a decree of a Court of Law and/or that the corner points mentioned in lines 3, 4 and 5 above were in conformance with the rules of the Michigan Board of Land Surveyors or by a Decree of a Court of Law; established, re-established, monumented, re-monumented, recovered, found as expressed below:

NOTE: Not more than 4 corners, all in the same town and range, may be recorded on this certificate.

	A	B	C	D	E	F	G	H	I	J	K	L	M
2	6	5	4	3	2	1							
3													
4	7	8	9	10	11	12							
5													
6	18	17	16	15	14	13							
7													
8	19	20	21	22	23	24							
9													
10	30	29	28	27	26	25							
11													
12	31	32	33	34	35	36							
13													

A. Description of original monument and accessories and/or subsequent restoration:

- Original GLO survey by Orange Risdon in March 1827 indicate 1/4 post set at a distance of 40.00 chains,
Witnessed by: 10" Beech, N61 deg. E 20 links
9" Sugar, S51 deg. W 17 links
- Survey by Oscar Church, County Surveyor in Liber 1, Page 221 dated April 9, 1875 monumentation states "Stake - Established according to law"

B. Description of corner evidence found and/or method applied in restoring or reestablishing corner:

Excavated 4' x 6' hole to an average depth of 2.5 feet in the centerline of Mulliken Road opposite occupied property line to East. Found long circular stone imbedded in clay just below layers of sand and gravel. Found smaller stones to the Southwest of stone. Stone falls 1.5 feet South of occupied property line. Set 3/4" x 24" standard iron rod with cap #28414 PA 345 in place of long circular stone. Placed monument box and cover over 3/4" rod. This surveyor accepted position of stone and subsequent 3/4" rod as the best perpetuated location of the corner. Performed traverse and measured North 2,640.24 feet to G-3, South 2,644.47 feet to G-5 and 2,643.61 feet to F-4.

C. Description of monument for corner and accessories established to perpetuate locating the position of the corner:

Set 3/4" x 24" iron rod with cap #28414 PA 345 in monument box, witnessed by:
Southwest Corner of Barn N 34 deg. E 469.99 feet
Southeast Corner of Concrete Block House N 13 deg. W 545.76 feet
Set Nail and Tag #28414 East side Utility Pole, N 50 deg. W 333.18 feet
Set Nail and Tag #28414 East side Utility Pole, S 56 deg. W 293.15 feet

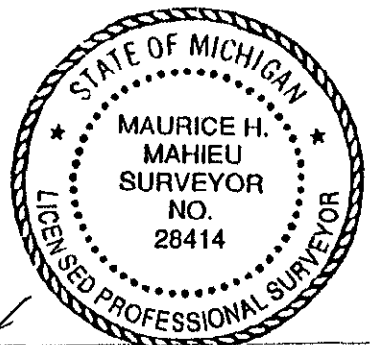

Signed by Maurice H. Mahieu
#28414

Date 11-29-94

Surveyor's Michigan License No. _____

FORM APPROVED BY MICHIGAN STATE BOARD OF LAND SURVEYORS, JAN. 28, 1971
REVISED MAY 14, 1975
REVISED JAN., 1983

P.A. 345 EATON COUNTY
PEER APPROVED 11/23/94 *ML*