

**SURVEY & REMONUMENTATION**

FILED

COPY

SEP 29 1994

**EATON COUNTY REMONUMENTATION**

**LAND CORNER RECORDATION CERTIFICATE**

94 SEP 28 AM 11:08

Filing Requirement of Act 74, Mich. P.A. 1970

**COMMISSION**

For corners in

EATON

(County)

Located In:

Corner Code #

- |                                  |   |           |   |           |             |
|----------------------------------|---|-----------|---|-----------|-------------|
| 1. Public Land Survey            | T | <u>4N</u> | R | <u>6W</u> | <u>D-11</u> |
| <b>SUNFIELD TWSP.</b>            | T | _____     | R | _____     | _____       |
| <b>1/4 COR. SEC. 29 &amp; 32</b> | T | _____     | R | _____     | _____       |
|                                  | T | _____     | R | _____     | _____       |
| 2. Property Controlling          | S | _____     | T | _____     | _____       |
| in Section                       | S | _____     | T | _____     | _____       |
| 3. Miscellaneous                 | S | _____     | T | _____     | _____       |
| Property in Sec.                 | S | _____     | T | _____     | _____       |

LINDA M. TWITCHELL  
REGISTER OF DEEDS  
EATON COUNTY, MICH.

L.3 Pg 455  
Register of Deeds Stamp & File Number

4. Lot No. \_\_\_\_\_, Recorded Plat \_\_\_\_\_  
5. Private Claims \_\_\_\_\_

	A	B	C	D	E	F	G	H	I	J	K	L
2	6	5	4	3	2	1						
3												
4	7	8	9	10	11	12						
5												
6	18	17	16	15	14	13						
7												
8	19	20	21	22	23	24						
9												
10	30	29	28	27	26	25						
11												
12	31	32	33	34	35	36						
13												

I, BRIAN REYNOLDS, in a field survey on 14 JULY, 1994, do hereby certify that under requirements of P.A. 74, Michigan P.A. of 1970, the corner points mentioned in lines 1 and 2 above were in conformance with regulations and rules therefore as required in the current manual of survey instructions of the United States Department of the Interior, Bureau of Land Management or by a decree of a Court of Law and/or that the corner points mentioned in lines 3, 4 and 5 above were in conformance with the rules of the Michigan Board of Land Surveyors or by a Decree of a Court of Law; established, re-established, monumented, re-monumented, recovered, found as expressed below:

**NOTE: Not more than 4 corners, all in the same town and range, may be recorded on this certificate.**

A. Description of original monument and accessories and/or subsequent restoration:

- GENERAL LAND OFFICE: ORANGE RISDON D.S., COPIED BY MORELL E. NEWCOMB, 01 APR 1908, WEST CORRECTED DISTANCE: 39.94ch.;**  
ASH - 14 - N2E - 45; ELM - 18 - S2W - 86
- COUNTY SURVEYOR OSCAR C. CHURCH: 39.85 1/2 W. TO C-11, 40.11ch. E. TO E-11; SET STONE IN PLACE OF STAKE; 5 MAY 1874**

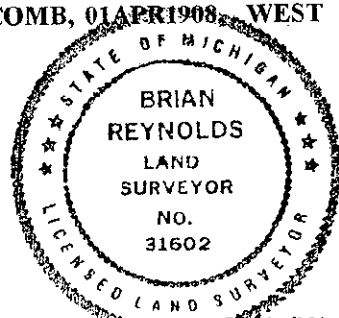

B. Description of corner evidence found and/or method applied in restoring or reestablishing corner:

**PRELIMINARY FIELD CHECK: EXCAVATED OVER MAGNETIC PULL TO FIND 1/2" UNCAPPED IRON ON CENTERLINE OF EAST-WEST ROAD IN LINE WITH OCCUPATION TREE ROW NORTH & SOUTH. IRON AT D-11 TO 1/8 LINE OCCUPATION FENCE WEST MEASURES 1314.5'; 1/8 LINE OCCUPATION FENCE TO INTERSECTION OF PHYSICAL ROAD CENTERLINES AT C-11 MEASURES 1315.8'; IRON AT D-11 TO INTERSECTION OF PHYSICAL ROAD CENTERLINES AT C-11 MEASURES 2630.29'; IRON AT D-11 TO FOUND P.K. AT INTERSECTION OF PHYSICAL ROAD CENTERLINES AT E-11 MEASURES 2629.18'. BASED ON CONSISTENT PATTERN OF PHYSICAL OCCUPATION, ACCEPTED 1/2" IRON AS BEST EVIDENCE OF THE POSITION FOR D-11. SET STANDARD 3/4" x 24" IRON WITH ORANGE PLASTIC CAP "PA 345 #31602 AND INSTALLED MON. BOX. UPON REQUEST OF EATON Co. PEER GROUP, REMOVED MON. BOX AND EXCAVATED TO FIND THAT REMON. IRON WAS POSITIONED IN A 2" DIA. PIPE WHICH WAS 2' BELOW ROAD GRADE AND AT NATURAL GRADE. 1/2" IRON WHICH WAS FOUND FIRST HAD BEEN USED TO RAISE THE POSITION OF OLDER 2" PIPE. THIS EVIDENCE FURTHER CONFIRMS CORNER POSITION.**

C. Description of monument for corner and accessories established to perpetuate locating the position of the corner:

**FOUND 1/2" IRON IN 2" PIPE. REPLACED 1/2" IRON WITH STANDARD EATON Co. REMON. IRON (3/4" x 24" WITH ORANGE PLASTIC CAP "PA345 #31602"), REMON. IRON BEING PLACED IN 2" PIPE. INSTALLED MON. BOX:**  
ON CENTERLINE OF EAST- WEST BITUMINOUS ROAD; ON OCCUPATION TREE ROW NORTH & SOUTH.  
SET 5" SPIKE WITH ORANGE PLASTIC "REYNOLDS #31602" TAG - S. FACE - 10" LOCUST - N62W - 74.32'  
SET 5" SPIKE WITH ORANGE PLASTIC "REYNOLDS #31602" TAG - E. FACE - 24" HICKORY - N. - 30.92'  
SET 5" SPIKE WITH ORANGE PLASTIC "REYNOLDS #31602" TAG - E. FACE - 8" ELM - S12W - 44.23'  
SET 5" SPIKE WITH ORANGE PLASTIC "REYNOLDS #31602" TAG - E. FACE - 12" ELM - S4E - 73.88'

Signed by

Date

SEPT 28 1994

Surveyor's Michigan License No.

31602

P.A. 345 EATON COUNTY

PEER APPROVED

8/24/94

FORM APPROVED BY MICHIGAN STATE BOARD OF LAND SURVEYORS, JAN. 28, REVISED MAY 14, REVISED JAN.,