

SURVEY & REMONUMENTATION

EMMET COUNTY REMONUMENTATION PROGRAM

STATE OF MICHIGAN
EMMET COUNTY
RECORDED

1994 DEC 14 PM 3:06

31 APR 27 1995
COMMISSION

LAND CORNER RECORDATION CERTIFICATE
Filing Requirement of Act 74, Mich. P.A. 1970

For corners in
EMMET

Alena B. Sipe
REGISTER OF DEEDS

(County)	Located In:	Corner Code #
1. Public Land Survey	SECTION 29 T T34 R R04 W	C11
	T - R -	-
	T - R -	-
	T - R -	-
2. Property Controlling in Section	S T - R -	-
	S T - R -	-
3. Miscellaneous Property in Sec.	S T - R -	-
	S T - R -	-

LIBER A
PAGE 42

Register of Deeds Stamp & File Number

4. Lot No. _____, Recorded Plat _____
5. Private Claims _____

I, Michael A. Trowbridge, in a field survey on 4/29, 1994, do hereby certify that under requirements of P.A. 74, Michigan P.A. of 1970, the corner points mentioned in lines 1 and 2 above were in conformance with regulations and rules therefore as required in the current manual of survey instructions of the United States Department of the Interior, Bureau of Land Management or by a decree of a Court of Law and/or that the corner points mentioned in lines 3, 4 and 5 above were in conformance with the rules of the Michigan Board of Land Surveyors or by a Decree of a Court of Law, established, re-established, monumented, re-monumented, recovered, found as expressed below:

	A	B	C	D	E	F	G	H	I	J	K	L	M
2	6		5		4		3		2		1		
3													
4	7		8		9		10		11		12		
5													
6	13		17		16		15		14		13		
7													
8	19		20		21		22		23		24		
9													
10	30		29		28		27		26		25		
11													
12	31		32		33		34		35		36		
13													

NOTE: Not more than 4 corners, all in the same town and range, may be recorded on this certificate.

A. Description of original monument and accessories and/or subsequent restoration:
C-11
SEE BACK OF THIS FORM FOR "A" INFORMATION...

UPPER MERIDIAN LAND CORNER
P.A. 945 OF 1990
EMMET COUNTY
RE. CELKE PS Co. Rep.
2 Dec. 1994

B. Description of corner evidence found and/or method applied in restoring or reestablishing corner:
C-11
FOUND 1/2" REROD, CAP NO. 27463, & WITNESSES AS REPRESENTED IN A CORNER RECORD BY TROWBRIDGE IN 1989, LIBER 2, LPAGE 267, & ALSO AS NOTED ON THE BACK OF THIS FORM; I FOUND THIS POSITION TO BE BASED ON THE BEST AVAILALBE EVIDENCE FOR THIS CORNER.

C. Description of monument for corner and accessories established to perpetuate locating the position of the corner:
C-11
SET A 2" DIAMETER, PVC PIPE WITH A BASE MAGNET & A STANDARD BRASS EMMET COUNTY REMONUMENTATION CAP IN THE SAME POSITION AS THE 1/2" REROD NOTED IN "B" ABOVE, & WITH THE SAME WITNESSES AS NOTED IN LIBER 2, PAGE 267, & AS FOLLOWS:

- 6" MAPLE 20.50' AZ. 337°
- 11" MAPLE 25.70' AZ. 30°
- 8" MAPLE 26.40' AZ. 221°
- 6" MAPLE 31.75' AZ. 170°

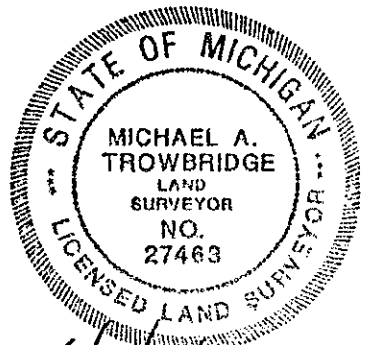

Signed by Michael A. Trowbridge Date 6/13/94

Surveyor's Michigan License No. 27463

EMMET COUNTY REMONUMENTATION PROGRAM

LIBER A
PAGE 43

CHRONOLOGY OF GLO CORNER

REMON. CORNER # 31 LCRC # 34-04-C11 TOWNSHIP...SPRINGVALE

CORNER COMMON TO 29-30-31-32, T34N, R4W

SURVEYOR: MICHAEL A. TROWBRIDGE, PLS # 27463

E.C.R. CONTRACT # 94-2

DATE	SURVEYOR	FOUND	SET (WITNESSES)
1841	GLO	SET POST	BEECH 8 S30E 12 BEECH 6 S60W 4
1880	E.K.ROBINSON (BK. 12 A, BOYNE CITY, & SPRINGVALE STATE ROAD SURVEY)	FOUND CORNER	NO WITNESSES; SHOWS WEST LINE SECTION 32 & DISTANCES, & DIVISION THEREOF...
1989	TROWBRIDGE... (P.A. 74 CORNER RECORD, L. 2, PAGE 267)	SET 1/2" REROD	& WITNESSES: 6" MAPLE 20.50 AZ. 337 11" MAPLE 25.70 AZ. 30 8" MAPLE 26.40 AZ. 221 6" MAPLE 31.75 AZ. 170

ADDITIONAL SUPPLEMENTAL INFORMATION INCLUDES:

-J.E.FERGUSON'S CORNER RECORD OF L2, PG. 102, ON C-12,
DATED 6-17-1982...*****NOTE*****THIS CORNER IS ERRONEOUSLY SET & IS
APPROXIMATELY 124'+/- SOUTH & 15'+/- EAST OF THE CORRECT POSITION. SEE CORNER
RECORD IN LIBER 2, PAGE 267 OF THE EMMET COUNTY RECORDS @ CORNER CODE #12C.

-E.A. ROBINSON, CO. SUR. NOTES, BK. 173, REGARDING THE 1880 INFORMATION
ABOVE, & ON C-12, DATED JAN. 9, 1906...

-TROWBRIDGE & ASSOCIATES WORKING DRAWING OF THE AREA...

-COPY OF 1902 PLAT MAP SHOWING ROADS...

-MISC. INFORMATION

3404-C11, MAT