

MICHIGAN
DEPARTMENT OF CONSERVATION
FORESTRY DIVISION

LAND CORNER RECORD

T. 34 N. R. 4W

Emmet COUNTY

DESCRIPTION OF CORNER 1/4 corner on south side Section 31.

CORNER MONUMENT Left 3/4" iron rod in place.

DATE MONUMENT PLACED AND WITNESSED 12-6-61

WITNESSES TO CORNER.....

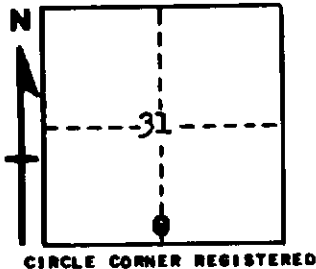

10" Elm - N 21 W - 25.8 feet

12" Elm - N 53 E - 25.8 feet

AND

DESCRIPTION IN DETAIL AS TO HOW CORNER WAS LOCATED AND IDENTIFIED OR RESTORED.

This corner was found while making a survey in this area. Found a 3/4" iron rod, 2" bent over, in centerline of E-W county line road. Checks acceptably for line and measurement to corners east and west, and appears to be the best available evidence of proper location for this corner.

1/4 corner on north side Section 6, T33N R4W is 17 1/2 links west.

SURVEYOR'S SEAL

SIGNED *Kenneth J. Oetting* DATE 12/12/61
REGISTERED LAND SURVEYOR