

SURVEY & REMONUMENTATION

APR 27 1995

COMMISSION

LAND CORNER RECORDATION CERTIFICATE
Filing Requirement of Act 74, Mich. P.A. 1970

STATE OF MICHIGAN
EMMET COUNTY
RECORDED

1994 DEC 28 AM 9:28

Thomas D. Swenor
REGISTER OF DEEDS

LIBER A
PAGE 103

Register of Deeds Stamp & File Number

For corners in

EMMET
(County)

Located In:

Corner Code #

1. Public Land Survey	T <u>34N</u> R <u>5W</u>	<u>L7</u>
	T _____ R _____	_____
	T _____ R _____	_____
	T _____ R _____	_____
2. Property Controlling in Section	S _____ T _____ R _____	_____
	S _____ T _____ R _____	_____
3. Miscellaneous Property in Sec.	S _____ T _____ R _____	_____
	S _____ T _____ R _____	_____

ECRP #37

4. Lot No. _____, Recorded Plat _____
5. Private Claims _____

Thomas D. Swenor, in a field survey on December, 1994, do hereby certify that under requirements of P.A. 74, Michigan P.A. of 1970, the corner points mentioned in lines 1 and 2 above were in conformance with regulations and rules therefore as required in the current manual of survey instructions of the United States Department of the Interior, Bureau of Land Management or by a decree of a Court of Law and/or that the corner points mentioned in lines 3, 4 and 5 above were in conformance with the rules of the Michigan Board of Land Surveyors or by a Decree of a Court of Law; established, re-established, monumented, re-monumented, recovered, found as expressed below:

NOTE: Not more than 4 corners, all in the same town and range, may be recorded on this certificate.

A. Description of original monument and accessories and/or subsequent restoration:

L7
SEE BACK PAGE OF THIS FORM FOR CHRONOLOGY

	A	B	C	D	E	F	G	H	I	J	K	L	M
2	6	5	4	3	2	1							
3													
4	7	8	9	10	11	12							
5													
6	18	17	16	15	14	13							
7													
8	19	20	21	22	23	24							
9													
10	30	29	28	27	26	25							
11													
12	31	32	33	34	35	36							
13													

RECORDED
P.A. 345 OF 1990
Emmet County
RECEIVED
20 DEC 1994

B. Description of corner evidence found and/or method applied in restoring or reestablishing corner:

L7

Found 1/2" Re-Rod referred to in Liber 2, Page 149, P.A. 74, 1970 Land Corner Recordation Certificate. Based on prior surveys was able to determine that the position as established by Trowbridge is approximately 3.85 feet south and 7.48 feet east of the single proportion measure from the Section Corners, East and West. See Note Below.

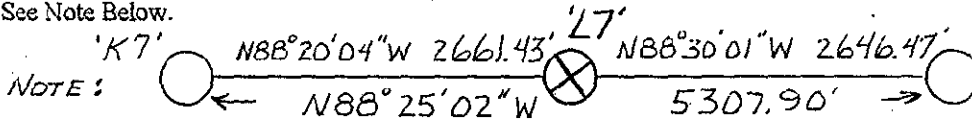

THIS CORNER IS ACCEPTED BY THE EMMET COUNTY REMONUMENTATION GROUP AS A FAITHFUL AND CAREFUL PERPETUATION OF THE ORIGINAL CORNER.

* BEARINGS ASSUMMED
* 'K7' & 'M-T' ASSUMMED CORRECT.

C. Description of monument for corner and accessories established to perpetuate locating the position of the corner:

L7

Found 1/2" Re-Rod and replaced with a 2" diameter, 30" long PVC Pipe with a Base magnet and a standard brass Emmet County Remonumentation cap.

Witnesses:

- 26" Maple - S40E 34.52' (Found spike nail centered in 27463 cap)
- 9" Red Maple - N52E 53.56' (Found spike nail centered in 27463 cap)
- 28" Maple - S17E 63.86' (Found spike nail centered in 27463 cap)
- 8" Red Pine - N62E 68.53' (Spike nail centered in 37282 cap)
- Nothwest Corner Block Foundation - S60E 124.51'

CORNER SET 6" BELOW GRADE TO HELP IN PRESERVATION OF CORNER

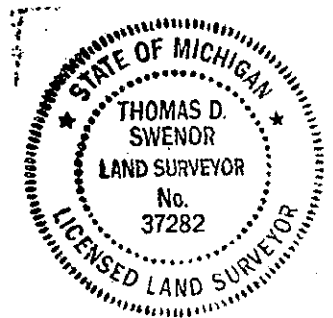

Signed by Thomas D. Swenor

Date 12-20-94

Surveyor's Michigan License No. 37282

A. DESCRIPTION OF ORIGINAL MONUMENT AND ACCESSORIES AND/OR SUBSEQUENT RESTORATION

Date	Surveyor	Found (Witnesses)
1840	GLO	Set post S55E, 12 lks, 10" maple; N25W 36 lks, 12" beech
1983	Trowbridge	Established position for corner. Held very old East fence extended for northing and average split of very old rows of trees on East and West right-of-way of Russett Road for easting.
1985	Trowbridge	Land Corner Recordation Certificate Liber 2, Page 149, for 1983 survey. witnesses: N65E, 44.70', 8" red pine S40E, 34.52', 20" maple N13W, 62.30', 24" maple
1991	Trowbridge	survey for Fouch, used 1/2" iron rod
1993	Swenor	Survey for Hickman (no map)-Corner accepted , and south 1/8 corner on North and South 1/4 line established using this corner.
1994	Swenor	Survey for VanKalker (sketch of findings prepared) in South 1/2 of the Southwest 1/4, Section 14, T34N R5W. Corner used in this survey.