

SURVEY & REMONUMENTATION

APR 27 1995

LAND CORNER RECORDATION CERTIFICATE
Filing Requirement of Act 74, Mich. P.A. 1970

LIBER A
PAGE 36

For corners in COMMISSION
EMMET
(County)

	Located In:	Corner Code #
1. Public Land Survey	T <u>34N</u> R <u>6W</u>	<u>I-9</u>
	T _____ R _____	_____
	T _____ R _____	_____
	T _____ R _____	_____
2. Property Controlling in Section	S _____ T _____ R _____	_____
	S _____ T _____ R _____	_____
3. Miscellaneous Property in Sec.	S _____ T _____ R _____	_____
	S _____ T _____ R _____	_____
4. Lot No. _____, Recorded Plat _____		
5. Private Claims _____		

STATE OF MICHIGAN
EMMET COUNTY
RECORDED
1994 DEC -7 AM 11:10
Alena D. Sigee
REGISTER OF DEEDS
Register of Deeds Stamp & File Number

I, Thomas D. Swenor, in a field survey on April, 1994, do hereby certify that under requirements of P.A. 74, Michigan P.A. of 1970, the corner points mentioned in lines 1 and 2 above were in conformance with regulations and rules therefore as required in the current manual of survey instructions of the United States Department of the Interior, Bureau of Land Management or by a decree of a Court of Law and/or that the corner points mentioned in lines 3, 4 and 5 above were in conformance with the rules of the Michigan Board of Land Surveyors or by a Decree of a Court of Law; established, re-established, monumented, re-monumented, recovered, found as expressed below:

	A	B	C	D	E	F	G	H	I	J	K	L	N
2	6		5		4		3		2		1		
3													
4	7		8		9		10		11		12		
5													
6	18		17		16		15		14		13		
7													
8	19		20		21		22		23		24		
9													
10	30		29		28		27		26		25		
11													
12	31		32		33		34		35		36		
13													

NOTE: Not more than 4 corners, all in the same town and range, may be recorded on this certificate.

A. Description of original monument and accessories and/or subsequent restoration:
19

SEE BACK PAGE OF THIS FORM FOR CHRONOLOGY

B. Description of corner evidence found and/or method applied in restoring or reestablishing corner:
1-9
Found 1"x3" Steel Stock
Searched for GLO Witnesses. DID NOT FIND.
Searched for and found both Elm witnesses as established by Miller/Schweigert in 1958.
Witnesses check to the face of both Elms; See below.

THIS CORNER IS ACCEPTED BY THE EMMET COUNTY REMONUMENTATION GROUP AS A CAREFUL AND FAITHFUL PERPETUATION OF THE ORIGINAL CORNER.

APPROVED LAND CORNER
P.A. 345 OF 1990
Emmet County
R.E. Celke P.S. G. Rep.
21 Nov. 1994

C. Description of monument for corner and accessories established to perpetuate locating the position of the corner:
1-9

- Found 1" x 3" Steel Stock 1 foot north of the centerline of a logging trail running east and replaced with a 2" diameter, 30" long PVC pipe with a base magnet and a standard brass Emmet County Remonumentation cap.
- 12" Maple - N04°W 24.90 feet (Small nail/no cap in west face)
- 12" Maple - S65°W 21.90 feet (Spike nail with 15401 cap in north face)
- 6" Maple - N60°E 14.01 feet (Spike nail with 37282 cap in south face)
- 10" Maple - S37°E 37.72 feet (Spike nail with 37282 cap in north face)
- 36" Elm Stump - S55°E 43.68 feet (Spike nail with 15401 cap in south face)
- to face of 36" Elm 41.2 feet (no nail/cap)
- 18" Elm Stump - N02°W 26.46 feet to face of stump (no nail/cap)

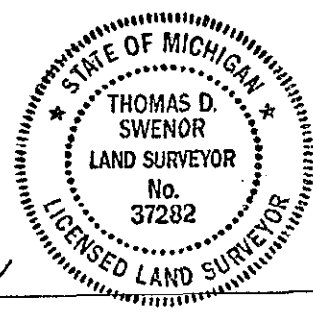

Signed by Thomas D. Swenor
Surveyor's Michigan License No. 37282

Date 11-22-94

A. DESCRIPTION OF ORIGINAL MONUMENT AND ACCESSORIES AND/OR SUBSEQUENT RESTORATION

Date	Surveyor	Found	Set (Witnesses)
1840	GLO	Set Post	Beech 10" N75°E 16 links Beech 10" N60°W 26 links
1900	Keep	Found Post	Beech 15" N63°E 16 links Beech 15" N51°W 26 links
1915	E.A. Robinson	Stake in Place	Stump of Beech 10" N75°E 16 links Roots of Beech 10" N60°W 26 links of Old Original Stake.
NOTE: A true copy of Blue Print on file in Emmet County Abstract & Title Co. of Section 27, T34N R6W, made by E.A. Robinson, Surveyor, Boyne City, Michigan, in the year 1915 shows "Section Corner put in Iron Stake."			
1949	T.W. Wilcoxen	Shows Corner.	No Reference
1958	Miller/Schweigert	Found 1" Bar	Elm 36" S63°E 41.2' Elm 18" N10°W 26.4'
1959	Miller/Schweigert	Found Iron Bar	
1966	M. C. Feindt	Shows Corner.	No Reference
1971	George Young	Found 1" Bar	
1975	Lawrence R. Feindt	Found iron intersection 2 track & North/South Fence line.	8"Maple S40°E 37.50' 11"Maple N10°W 24.65' 13"Maple S20°W 13.10'
1977	M. C. Feindt	P.A. 132 of 1975 Survey	
1978	James H. Green	Fnd 1" Iron Bar	36" Elm S63°E 41.2' 18" Elm N10°W 26.4'
1985	James H. Green	Found 1"x3" Bar	36" Elm Stump S63°E 43.7' 10"Maple S60°W 21.89' 10"Maple N6°W 24.90'
1990	James H. Green	Fnd 1"x3" Iron	36" Elm Stump S63°E 43.7' 10"Maple S60°W 21.89' 10"Maple N6°W 24.90' Corner found in the intersection of a trail road running South and East.
1991	Richard E. Oelke	Fnd 1"x3" Steel Stock	1' North + C/L Logging Trail to East
1991	Furgeson & Chamberlain	Fnd Steel Rod 1"x3"	
1991	Mike Trowbridge	Fnd 1"x3" Iron rod	Same as 1990 Green Witnesses