

MAR 16 1994

1994 FEB 14 AM 10:13

COMMISSION

LAND CORNER RECORDATION CERTIFICATE Filing Requirement of Act 74, Mich. P.A. 1970

For corners in EMMET

Glenn B. Sipe REGISTER OF DEEDS

Table with columns: Located In: (County), Corner Code #, and rows for Public Land Survey, Property Controlling in Section, and Miscellaneous Property in Sec.

LIBER A PAGE 5

Register of Deeds Stamp & File Number

4. Lot No. , Recorded Plat
5. Private Claims

Grid table with columns A-M and rows 2-13, containing numbers 1-36.

I, Michael A. Trowbridge, in a field survey on 11/24, 1993, do hereby certify that under requirements of P.A. 74, Michigan P.A. of 1970, the corner points mentioned in lines 1 and 2 above were in conformance with regulations and rules therefore as required in the current manual of survey instructions of the United States Department of the Interior, Bureau of Land Management or by a decree of a Court of Law and/or that the corner points mentioned in lines 3, 4 and 5 above were in conformance with the rules of the Michigan Board of Land Surveyors or by a Decree of a Court of Law; established, re-established, monumented, re-monumented, recovered, found as expressed below:

NOTE: Not more than 4 corners, all in the same town and range, may be recorded on this certificate.

A. Description of original monument and accessories and/or subsequent restoration:

- L3, 1841, GLO SURVEYOR, SET POST & WITNESSES: BEECH 6 HIGH, BEECH 12 S73E 4
1885, JOHN KEEP SET STONE WITH CROSS PER #46 OF CITY OF PETOSKEY RECORDS DATED FEB. 16, 1903, PG.S 27 & 28.
1957, E.C.RD.COMM, FOUND STONE WITH CROSS; SANK STONE, & PLACED 1-1/2" X 18" SHAFT WITH EYE ON TOP END OVER STONE & WITH'S: PP NW 38.6, 12" APPLE NW 89.3, PP NE 32.0, MAPLE SE 61.1, COR. FND. HOUSE SW 73.8.
1963, MILLER/TAN LCRC BK./CODE (1-7), PD. PER 1899 HAYDEN SURVEY STONE/CROSS ON TOP & IRON BOLT ON TOP OF STONE, HAYDEN'S WITH'S: 4" APPLE 58' NO BEARING, 4" APPLE 64' NO BEARING, NOTES...NOW 24" S. MAPLE, MILLER SET SHORT T-IRON OVER IRON BOLT & WITH'S: 24" S. MAPLE S48E 61.1, NE COR. RESIDENCE S42W 73.5; E.C.RD.COMM. WITH.'S 402(27) TO SAME COR...NO DATE, PD. T-IRON WITH CAP, S45W 73.62 NE COR HOUSE, N52W 38.88 TEL POLE, S45E 62.1 28" MAPLE.
1986, TROWBRIDGE, L2/P161, FOUND T-IRON IN MON. BOX, & MADE THESE WITH'S, WHICH ARE IN ERROR: PP N50E 31.31, PP S47E 42.05.

B. Description of corner evidence found and/or method applied in restoring or reestablishing corner:

- L3, 1993, TROWBRIDGE, FOUND T-IRON .9' LONG IN MON. BOX; T-IRON WAS OVER A .17' DIA. EYE BOLT (HOLE IN TOP WITH .07' DIA. THREADS AT BASE) 1.7' LONG; THE THREADS OF THE BOLT WERE RESTING ON TOP OF A LARGE ROCK, WHERE EVIDENCE OF A CROSS WAS ASCERTAINED...TOP OF ROCK IS 2.6' BELOW THE ROAD SURFACE! I USED THIS POSITION AS THE BEST AVAILABLE EVIDENCE FOR THIS GLO CORNER.

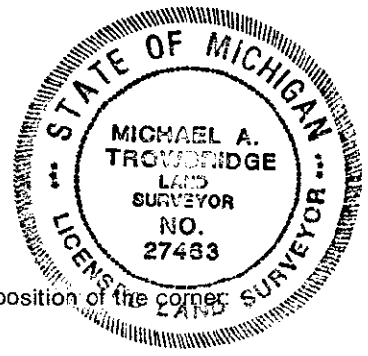

C. Description of monument for corner and accessories established to perpetuate locating the position of the corner

- L3 Mon. Box
I SET AN EMMET COUNTY SURVEY REMONUMENTATION PROGRAM MARKER IN SAME POSITION AS MILLER'S T-IRON ABOVE, BEING OVER THE EYE BOLT & CROSS ON TOP OF KEEP'S 1885 ROCK & FOLLOWING WITH'S: R - MEANS RECORD, & M-MEANS NEW MEASURE; 27463 TAG IN NW PC PP N48'E 32.68' (M) (N50'E 31.31' (R)), 27463 TAG IN E. PC. PP S45'E 43.44' (M) S47'E 42.05' (R), NEAREST POINT BASE 2" DIA. FLAGPOLE S45'W 57.94', 33983 TAG S PC. PP N75'W 123.21', 27463 CAPPED HEROD (1/2") OVER FOUND PIPE S79'W 136.05', 10710 CAP W. PC. 24" S. MAPLE S44'E 60.80' (M) S48'E 61.1' (R), NE COR. RESIDENCE AT CORNER CEMENT FOUNDATION S42'W 73.53' (M) S42'W 73.5' (R).

Signed by Michael A. Trowbridge Surveyor's Michigan License No. 27463

Date 12/31/93