

MAY 05 1997

COMMISSION LAND CORNER RECORDATION CERTIFICATE
Filing Requirement of Act 74, Mich. P.A. 1970

STATE OF MICHIGAN
EMMET COUNTY
RECORDED

96 DEC 31 PM 2:25

Glenn B. Spivey
REGISTER OF DEEDS

For corners in

Emmet
(County)

Located In:

Corner Code #

Littlefield Township

- 1. Public Land Survey T 35N R 4W C-3
ECRP #44
2. Property Controlling in Section S T R
3. Miscellaneous Property in Sec. S T R

LIBER A
PAGE 127

Register of Deeds Stamp & File Number

- 4. Lot No. , Recorded Plat
5. Private Claims

I, Michael A. Trowbridge, in a field survey on December 2, 1996, do hereby certify that under requirements of P.A. 74, Michigan P.A. of 1970, the corner points mentioned in lines 1 and 2 above were in conformance with regulations and rules therefore as required in the current manual of survey instructions of the United States Department of the Interior, Bureau of Land Management or by a decree of a Court of Law and /or that the corner points mentioned in lines 3, 4 and 5 above were in conformance with the rules of the Michigan Board of Professional Surveyors or by a Decree of a Court of Law; established, re-established, monumented, re-monumented, recovered, found as expressed below:

Grid table with columns A-M and rows 1-13. A dot is marked at row 3, column C.

NOTE: Not more than 4 corners, all in the same town and range, may be recorded on this certificate.

A. Description of original monument and accessories and/or subsequent restoration:

C-3..... Corner common to Sections 5, 6, 7 & 8, T35N, R4W

See Emmet County Remonumentation Program chronology of GLO corner on back side of this page.

APPROVED LAND CORNER
P.A. 345 OF 1990
Emmet County
P.E. OSUKE
12-30-96

B. Description of corner evidence found and/or method applied in restoring or reestablishing corner:

C-3..... Corner common to Sections 5, 6, 7 & 8, T35N, R4W

Found 1-1/4" pipe with aluminum Emmet County marker.

Found Witnesses

- 3) S30°E(record) Az.172°(measure), 10.28', 8" Maple (spike in west face)
4) East, 11.75', 8" Maple (spike in south face)
5) N7°E, 21.25', 6" Birch-dead (27463 cap in east face)
6) N39°W, 8.65', 5" Ash (27463 cap in east face)
7) S22°E, 6.68', 10" Maple (27463 cap in west face)

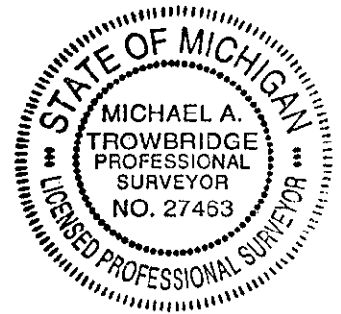

C. Description of monument for corner and accessories established to perpetuate locating the position of the corner:

C-3..... Corner common to Sections 5, 6, 7 & 8, T35N, R4W

The 1-1/4" pipe with aluminum Emmet County marker was removed and replaced with a 2" diameter x 30" long PVC pipe, a base magnet and a standard brass Emmet County Remonumentation cap. This position is accepted as a careful and faithful perpetuation of the original corner.

New Witness

- 8) Az.1°, 18.75', 8" Maple (27463 cap in west face)

Signed by Michael A. Trowbridge

Date December 19, 1996

Surveyor's Michigan License No. 27463

EMMET COUNTY REMONUMENTATION PROGRAM

**CHRONOLOGY OF GLO CORNER**

REMON. CORNER # 44      LCRC # 35-04-C3      TOWNSHIP...LITTLEFIELD

LIBER A  
PAGE 128

CORNER COMMON TO SECTIONS 5, 6, 7 & 8, T35N, R4W

DATE	SURVEYOR	FOUND/POST	WITNESSES:
1840	GLO	Set Post	1) S32°W, 12 Lks, 9" Beech 2) N40°E, 45 Lks, 12" Maple
1888	Keep	Found corner.	
	ECRC	Set standard Emmet County marker.	3) S30°E, 10.28', 8" Maple 4) East, 11.75', 8" Maple
1970	Green	Survey for MBT shows found standard Emmet County marker.	
1974	Advance	Survey (252/63) found corner.	
1979	Green	Survey for Holmes (305/754) & (305/755) found Emmet Co. standard marker.	
1980	Green	LCRC 2/45, found 1-1/4" iron pipe.	3) S30°E, 10.28', 8" Maple 4) S90°E, 11.75', 8" Maple
1986	Trowbridge	Found 1-1/4" pipe with Emmet County marker.	5) N7°E, 21.25', 6" Birch (27463 cap) 6) N39°W, 8.65', 5" Ash (27463 cap) 7) S22°E, 6.68', 10" Maple (27463 cap)