

MAY 15 1997

COMMISSION

LAND CORNER RECORDATION CERTIFICATE
Filing Requirement of Act 74, Mich. P.A. 1970

STATE OF MICHIGAN
EMMET COUNTY
RECORDED

96 DEC 31 PM 2:26

Blanca A. Sipes
REGISTERED DEEDS

BOOK A
PAGE 163

For corners in Emmet Located In: Littlefield Township Corner Code # _____
(County)

- 1. Public Land Survey T 35N R 5W Corner Code # K-6
ECRP #15 T _____ R _____
T _____ R _____
T _____ R _____
- 2. Property Controlling S _____ T _____ R _____
in Section S _____ T _____ R _____
- 3. Miscellaneous S _____ T _____ R _____
Property in Sec. S _____ T _____ R _____

Register of Deeds Stamp & File Number

- 4. Lot No. _____, Recorded Plat _____
- 5. Private Claims _____

I, Michael A. Trowbridge, in a field survey on December 12, 1996, do hereby certify that under requirements of P.A. 74, Michigan P.A. of 1970, the corner points mentioned in lines 1 and 2 above were in conformance with regulations and rules therefore as required in the current manual of survey instructions of the United States Department of the Interior, Bureau of Land Management or by a decree of a Court of Law and /or that the corner points mentioned in lines 3, 4 and 5 above were in conformance with the rules of the Michigan Board of Professional Surveyors or by a Decree of a Court of Law; established, re-established, monumented, re-monumented, recovered, found as expressed below:

	A	B	C	D	E	F	G	H	I	J	K	L
1												
2	6			5			4		3		2	1
3												
4	7						8		9		10	11
5												
6	18			17		16		15		14	13	
7												
8	19			20		21		22		23	24	
9												
10	30			29		28		27		26	25	
11												
12	31			32		33		34		35	36	
13												

NOTE: Not more than 4 corners, all in the same town and range, may be recorded on this certificate.

A. Description of original monument and accessories and/or subsequent restoration:

K-6..... Corner common to Sections 13 & 14, T35N, R5W

See Emmet County Remonumentation Program chronology of GLO corner on Pages 2 and 3 of this document. Also see sketch on Page 4 of 4.

APPROVED LAND CORNER
P.A. 345 OF 1990
Emmet County
P.E. OELKE
12-30-96

B. Description of corner evidence found and/or method applied in restoring or reestablishing corner:

K-6..... Corner common to Sections 13 & 14, T35N, R5W

Found 1" diameter x 32" long pipe

Found Witnesses

- 2) S60°E 78.78' 24" Maple (spike in north face)
- 3) S85°E 31.45' 8" Cedar (spike in south face)
- 4) S60°E 7.07' Concrete Monument

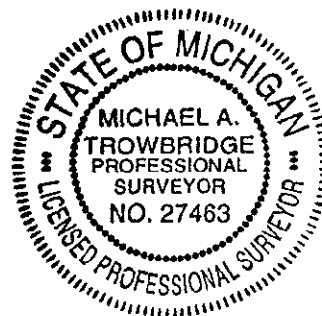

C. Description of monument for corner and accessories established to perpetuate locating the position of the corner:

K-6..... Corner common to Sections 13 & 14, T35N, R5W

The pipe was removed and replaced with a 2" diameter x 30" long PVC pipe, a base magnet and a standard brass Emmet County Remonumentation cap. This position is accepted as the best available evidence of the position of the original corner.

New Witnesses

- 2) S60°E 78.78' 24" Maple (spike in north face) added 27463 cap at same position as found spike
- 3) S85°E 31.45' 8" Cedar (spike in south face) added 27463 cap above found spike
- 5) Az.71° 35.80' Power Pole (27463 cap in south face)
- 6) Az.2° 37.95' 8" Birch (27463 cap in northeast face)

Signed by Michael A. Trowbridge Date December 19, 1996
Surveyor's Michigan License No. 27463

EMMET COUNTY REMONUMENTATION PROGRAM

CHRONOLOGY OF GLO CORNER

LIBER A
PAGE 164

REMON. CORNER # 15 LCRC # 35-05-K6 TOWNSHIP..LITTLE TRAVERSE

SURVEYOR: MICHAEL A. TROWBRIDGE, PLS # 27463

E.C.R. CONTRACT # 2

DATE	SURVEYOR	FOUND	SET (WITNESSES)
1840	GLO	SET POST	HEMLOCK 9 N81E 07 HEMLOCK 10 S29W 09
1880/1886	HARTZLER	COMMENTS: HIGHWAY SURVEY, SHOWS GOV'T BEARING TREES & EVIDENCE PER DIMENSIONS ALONG SECTION LINES OF VISITING CORNERS AT THIS TIME	
1930	TRIPP/E.C.RD. COMM.	, BROWN FIELD BOOK # 99, PG. 4-11 COMMENTS: SHOWS "O" AT CORNER POSITION & DESCRIBES LAND AREA FOR PROPOSED ROAD R.O.W. PURCHASE... TRIPP OBVIOUSLY VISITED CORNER.. VALUE?????	
1965	E.C.RD. COMM.	CODE: B-(3)-D....PLANS SHOW "O" FOR CORNER POSITION & DIMENSIONS SOUTH & WEST TO APPARENT CORNER POSITIONS....	
1970	G.E.YOUNG (877/CY JORDAN) (NOTES, BK. P)	FOUND 1" IRON PIPE & REPLACED WITH A CONCRETE MONUMENT... (SHOWS DISTANCES TO 1/2" BAR AT SE-14, & T-IRON AT W1/4C-14)	
1974	MCCOMBS/CONS. PWR. CO.	FOUND G.E.YOUNG'S CONC. MON. & MADE FOLLOWING WITN'S: PP N50-1/2E 29.53 8" BIRCH N65-1/2W 57.95' SMALL CLUMP BIRCH S55-1/2W 37.45	
1975	J.H.GREEN/SHORTER	FOUND PIPE	WITNESSES: 1) N70°E 33.40' POWER POLE 2) S58°E 79.00' 24" MAPLE
1978	DEYOUNG	USED CONC. MON.	WITN'S SAME AS MCCOMBS/1974
1982	J.H. GREEN/CROFF	USED PIPE AS IN GREEN/1975/SHORTER	
1984	BIDSTRUP & YOUNG/O'NEIL, 83-30/MOETEC	COMMENTS: O'NEIL USED CONC. MON./G.E.YOUNG/1970 ABOVE... NOTES THERE ARE (2) OTHER CORNERS....BESIDES CONC. MON.	
1984	TROWBRIDGE	USED JHG'S PIPE & WITNESSES (SMITH) SURVEY, L354, P546...PRIOR RECORDING, L339, P851	
1984	MITCHELL	USED JHG'S PIPE & RECORDED SURVEY & CORNER L345/P441 L2/P107	WITNESSES: 1) N70°E 33.35' POWER POLE 2) S60°E 78.78' 24" MAPLE 3) S85°E 31.45' 8" CEDAR 4) S60°E 7.07' CONCRETE MONUMENT
1984/1985	TROWBRIDGE	USED J.H. GREEN'S PIPE & USED MITCHELL'S WITN.S [UNRECORDED SURVEYS, (2)]	
1987	BIDSTRUP & YOUNG	USED G.E. YOUNG'S CONC. MON. FOR MCBRIDE PARK PLAT....	

EMMET COUNTY REMONUMENTATION PROGRAM

LIBER A
PAGE 165

CHRONOLOGY OF GLO CORNER

REMON. CORNER # 15 LCRC # 35-05-K6 TOWNSHIP..LITTLE TRAVERSE

SURVEYOR: MICHAEL A. TROWBRIDGE, PLS # 27463

E.C.R. CONTRACT # 2

DATE SURVEYOR FOUND SET (WITNESSES)

1988 TROWBRIDGE USED J.H. GREEN'S PIPE & MITCHELL'S
L400/P620 WITNESSES.....SURVEY IS PART OF THE
NE1/4 NW1/4 SECTION 13-35-5

1989 TROWBRIDGE USED G.E. YOUNG'S CONC. MON. WITH NOTATION
L421/040 OF (2) CORNERS AT THIS LOCATION.....
WITNESSES:
SPIKE/N FC PP N64E 29.68 AZ. 59
5 CEDAR AZ 95 25.14 NAIL/N. FC.
8 W BIRCH N78W 57.93 TO PK NAIL/S FC
92.89 TO CONC MON AZ 183

1990 BIDSTRUP & YOUNG USED CONC. MON. & WITNESSES:
N04E 33.20 4" APPLE ELY FACE TAG # 24676
N50E 29.64 PP FD. SP. N. FACE
N84E 25.13 8" CEDAR FD. NAIL S. FACE
N65W 7.07 FD. 1" PIPE
(ABOVE FROM 88-307/MCBRIDE, DAVIS
& PARSON, 8-14-90, 90-10, PG. 13
NOTES)

1990 BIDSTRUP & YOUNG
(88-307/MCBRIDE, 9-2-90, 90-12/11, R.E. OELKE)
COMMENTS:
R.E. OELKE SEARCHING FOR EVIDENCE AT THE W1/4C-13-35-5
FOR MORE INFORMATION.....

HE MADE A FIELD SKETCH SHOWING (4) DIFFERENT IRON
MATERIALS FOUND AT THIS ALREADY CONFUSING CORNER...

HE FOUND PER HIS SKETCH:

- (A) MITCHELL'S (GREEN'S)
PIPE, L2/P107
- (B) G.E. YOUNG'S CONC.
MON./1970
- (C) 1/2" IP, 20" +/- LONG

WITNESSES TAKEN BY REO
N29E 57.75 FENCE COR.
N67E 31.25 PP NAIL W/OLD TAG?
N88W 53.22 8" BIRCH
S1E 97.09 CON. MON.
....NOTE: (C) IS APPROX. 2'
E. OF MITCHELL'S PIPE & APPROX.
6' NW/LY OF YOUNG'S CONC. MON.

- (D) T-IRON
NOTE: T-IRON IS APPROX. 10' N. OF (C)

...NOTE...SEE SKETCH ENCLOSED FOR FURTHER CLARITY.....

1992 BIDSTRUP & YOUNG
92-277/KINSEY DAVIS/NOLAN, 92-7/48, SE1/4 SEC. 14-35-5

COMMENTS: TIED IRONS A, B, C, D ABOVE INTO THEIR CONTROL NET, SE1/4 SEC. 14-35-5

1993 TROWBRIDGE
(2) UNRECORDED SURVEYS.....

COMMENTS: USED T-IRON AT THE C1/4C-14-35-5, & T-IRON AT THE W1/4C-14-35-5, WHICH
IS IN HARMONY WITH G.E. YOUNG'S CONC. MON. AT THE E1/4C-14-35-5

SURVEY &
REMONUMENTATION

MAY 05 1997

COMMISSION

APPROVED LAND CORNER
P.A. 345 OF 1990
Emmet County
R.E. OELKE
12-30-96

SKETCH OF ECRP NO. 15 & SURROUNDING FEATURES

