

MAY 05 1997

COMMISSION

LAND CORNER RECORDATION CERTIFICATE  
Filing Requirement of Act 74, Mich. P.A. 1970

STATE OF MICHIGAN  
EMMET COUNTY  
RECORDED

96 DEC 31 PM 2:25

*Glenn B. Aizer*  
REGISTER OF DEEDS  
LIBER A  
PAGE 115

For corners in EMMET Located in: \_\_\_\_\_ Corner Code # \_\_\_\_\_  
(County)

- 1. Public Land Survey T 35N R 5W \_\_\_\_\_ K7  
ECRP #129 T \_\_\_\_\_ R \_\_\_\_\_  
T \_\_\_\_\_ R \_\_\_\_\_  
T \_\_\_\_\_ R \_\_\_\_\_
- 2. Property Controlling S \_\_\_\_\_ T \_\_\_\_\_ R \_\_\_\_\_  
in Section S \_\_\_\_\_ T \_\_\_\_\_ R \_\_\_\_\_
- 3. Miscellaneous S \_\_\_\_\_ T \_\_\_\_\_ R \_\_\_\_\_  
Property in Sec. S \_\_\_\_\_ T \_\_\_\_\_ R \_\_\_\_\_

Register of Deeds Stamp & File Number

- 4. Lot No. \_\_\_\_\_, Recorded Plat \_\_\_\_\_
- 5. Private Claims \_\_\_\_\_

I, Michael A. Trowbridge, in a field survey on December 12, 19 96, do hereby certify that under requirements of P.A. 74, Michigan P.A. of 1970, the corner points mentioned in lines 1 and 2 above were in conformance with regulations and rules therefore as required in the current manual of survey instructions of the United States Department of the Interior, Bureau of Land Management or by a decree of a Court of Law and /or that the corner points mentioned in lines 3, 4 and 5 above were in conformance with the rules of the Michigan Board of Professional Surveyors or by a Decree of a Court of Law; established, re-established, monumented, re-monumented, recovered, found as expressed below:

NOTE: Not more than 4 corners, all in the same town and range, may be recorded on this certificate.

A. Description of original monument and accessories and/or subsequent restoration:

K7, CORNER COMMON TO SECTIONS 13,14,23, & 24, T35N, R5W  
SEE CHRONOLOGY ON BACK OF THIS FORM FOR CORNER HISTORY.

B. Description of corner evidence found and/or method applied in restoring or reestablishing corner:

K7, CORNER COMMON TO SECTIONS 13,14,23, & 24, T35N, R5W

Found boat spike (1/2" bar noted in chronology on back is this same boat spike ) as noted on back & the following witness:

(3 )North 2651.43' 1" iron pipe

APPROVED LAND CORNER  
P.A. 345 OF 1990  
Emmet County  
P.E. OELLS  
12-30-96

C. Description of monument for corner and accessories established to perpetuate locating the position of the corner:

K7, CORNER COMMON TO SECTIONS 13,14,23, & 24, T35N, R5W

The boat spike above was removed, and replaced with a 2" diameter , 30" long, PVC pipe with a base magnet and a standard brass Emmet County Survey Remonumentation Program cap, which was placed within a standard Emmet County monument box. This position is accepted as a careful and faithful perpetuation of the position of the original corner.

ADDITIONAL NEW WITNESSES:

- AZIMUTH 65° 57.20' top center of fence post, cap #27463 & nail
- AZIMUTH 321° 72.00' 6" Birch, cap #27463 in south face
- AZIMUTH 249° 56.37' top center of fence post, cap #27463 & nail
- AZIMUTH 98° 47.18' wolmanized power pole, cap #27463 & nail in south face

Signed by Michael A. Trowbridge

Date 12/20/1996

Surveyor's Michigan License No. 27463

	A	B	C	D	E	F	G	H	I	J	K	L	M
1													
2	6			5			4		3			2	1
3													
4	7						8		9		10		11
5													
6	18			17			16		15			14	13
7													
8	19			20			21		22		23		24
9													
10	30			29			28		27			26	25
11													
12	31			32			33		34		35		36
13													

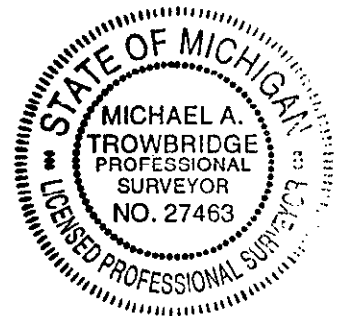

EMMET COUNTY REMONUMENTATION PROGRAM

LIBER A

CHRONOLOGY OF GLO CORNER

PAGE 116

REMON. CORNER # 129      LCRC # 35-05-K7      TOWNSHIP...Little Traverse

CORNER COMMON TO SECTIONS 13,14,23,24 , T35 N, R05 W

DATE	SURVEYOR	FOUND/POST	WITNESSES:		
1840	GLO	Set Post	1)N54°W	04 lks.	Cedar 8
			2)N73°E	06 lks.	Cedar 8
1889 (?)	KEEP B5,P15	"Beginning @ old corner" 13-14-23-24....shows distances south			
1889	KEEP B1,P56-58	"From NW Cor. Sec. 24-35-5"....shows distances south			
1970	Young, George	Found 1/2" bar			
1984	Mitchell, R.F. L2,P107 LCRC,PA74	Found boat spike on fence east @ c/l north & south road	3)North 4)South	2651.43' 1" Iron Pipe 2658.00' 1" Iron Bar	
1984	Mitchell, R.F. L345,P441 MAP, PA132	...same as above...			

NOTE.....this boat spike has been used in many unrecorded surveys as the corner