

MAY 05 1997

LAND CORNER RECORDATION CERTIFICATE
Filing Requirement of Act 74, Mich. P.A. 1970

STATE OF MICHIGAN
EMMET COUNTY
RECORDED

96 DEC 31 PM 2:25

William B. Lyons
REGISTER OF DEEDS

COMMISSION

For corners in EMMET Located in: _____ Corner Code # _____
(County)

1. Public Land Survey	T <u>37N</u> R <u>4W</u>	<u>C5</u>
	T _____ R _____	_____
ECRP #117	T _____ R _____	_____
	T _____ R _____	_____
2. Property Controlling in Section	S _____ T _____ R _____	_____
	S _____ T _____ R _____	_____
3. Miscellaneous Property in Sec.	S _____ T _____ R _____	_____
	S _____ T _____ R _____	_____

LIBER A
PAGE 125

Register of Deeds Stamp & File Number

4. Lot No. _____, Recorded Plat _____
5. Private Claims _____

I, MICHAEL A. TROWBRIDGE in a field survey on DECEMBER 13, 1996, do hereby certify that under requirements of P.A. 74, Michigan P.A. of 1970, the corner points mentioned in lines 1 and 2 above were in conformance with regulations and rules therefore as required in the current manual of survey instructions of the United States Department of the Interior, Bureau of Land Management or by a decree of a Court of Law and for that the corner points mentioned in lines 3, 4 and 5 above were in conformance with the rules of the Michigan Board of Professional Surveyors or by a Decree of a Court of Law; established, re-established, monumented, re-monumented, recovered, found as expressed below:

	A	B	C	D	E	F	G	H	I	J	K	L	M
1													
2	6		5		4		3		2		1		
3													
4	7		8		9		10		11		12		
5													
6	18		17		16		15		14		13		
7													
8	19		20		21		22		23		24		
9													
10	30		29		28		27		26		25		
11													
12	31		32		33		34		35		36		
13													

NOTE: Not more than 4 corners, all in the same town and range, may be recorded on this certificate.

A. Description of original monument and accessories and/or subsequent restoration:

C5, CORNER COMMON TO SECTIONS 7, 8, 17, & 18, T37N, R4W

SEE CHRONOLOGY ON BACK FOR CORNER HISTORY.

B. Description of corner evidence found and/or method applied in restoring or reestablishing corner:

C5, CORNER COMMON TO SECTIONS 7, 8, 17, & 18, T37N, R4W

SET CORNER ON FENCE LINE NORTH IN CENTERLINE OF EAST & WEST GRAVEL ROAD.

APPROVED LAND CORNER
P.A. 345 OF 1990
Emmet County
R.E. DEWIS
12-30-96

C. Description of monument for corner and accessories established to perpetuate locating the position of the corner:

C5, CORNER COMMON TO SECTIONS 7, 8, 17, & 18, T37N, R4W

Set at the corner a 2" diameter, 30" long, PVC pipe with a base magnet and a standard brass Emmet County Survey Remonumentation Program cap. This position is accepted as the best available evidence of the position of the original corner.

Witnesses:

Azimuth	5°	33.69'	Corner fence post, cap #27463 & nail in west face
Azimuth	31°	56.83'	14" Basswood, cap # 27463 & nail in east face
Azimuth	326°	74.60'	8" Maple, cap # 27463 & nail in southwest face
Azimuth	208°	35.83'	steel corner post of pasture fence, nearest point
Azimuth	144°	43.60'	7" Basswood, cap # 27463 in southwest face

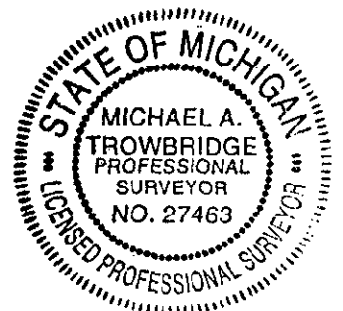

Signed by Michael A. Trowbridge Date 12/19/1996

Surveyor's Michigan License No. 27463

EMMET COUNTY REMONUMENTATION PROGRAM

CHRONOLOGY OF GLO CORNER

LIBER A
PAGE 126

REMON. CORNER #117 LCRC # 37-04-C5 TOWNSHIP...MCKINLEY

CORNER COMMON TO SECTIONS 7, 8, 17, & 18, T37N, R4W

DATE	SURVEYOR	FOUND/SET	WITNESSES
1840	GLO	SET POST	(1) BEECH 7 N15W 27 (2) BEECH 7 S62E 21
1909	SWIFT	5" BEECH STAKE & BOTH ORIG. BRG. TREES (FOUND)	
1915	MAIN	BEECH POST & ONE STANDING BRG. TREE, & ONE BLOWN DOWN (FOUND)	*NEW BEARING TREE* (3)BEECH 5 S88E 16'