

LAND CORNER RECORDATION CERTIFICATE 98 DEC 31 PM 1:03
Filing Requirement of Act 74, Mich. P.A. 1970

For corners in

Emmet
(County)

Located In:

Corner Code #

1. Public Land Survey
ECRP # 68

T 37N R 4W
T _____ R _____
T _____ R _____
T _____ R _____
S _____ T _____ R _____
S _____ T _____ R _____
S _____ T _____ R _____
S _____ T _____ R _____

H-13

Alma L. Sipe
REGISTER OF DEEDS

LIBER A
PAGE 296

Register of Deeds Stamp & File Number

4. Lot No. _____, Recorded Plat _____
5. Private Claims _____

I, Thomas D. Swenor, in a field survey on December 03, 1998, do hereby certify that under requirements of P.A. 74, Michigan P.A. of 1970, the corner points mentioned in lines 1 and 2 above were in conformance with regulations and rules therefore as required in the current manual of survey instructions of the United States Department of the Interior, Bureau of Land Management or by a decree of a Court of Law and/or that the corner points mentioned in lines 3, 4 and 5 above were in conformance with the rules of the Michigan Board of Land Surveyors or by a Decree of a Court of Law; established, re-established, monumented, re-monumented, recovered, found as expressed below:

NOTE: Not more than 4 corners, all in the same town and range, may be recorded on this certificate.

A. Description of original monument and accessories and/or subsequent restoration:

H-13 (sc), aka H-1(cc)
1/4 Corner common to Section 3, T36N R4W, and common to Section 34, T37N R4W.

(SEE BACK OF PAGE FOR HISTORY)

See abstract in Section B. below.

B. Description of corner evidence found and/or method applied in restoring or reestablishing corner:

H-13 (sc), aka H-1(cc),
Found 1" iron bar which matches 1883 Plat of Pellston, (L.1 P.28) prepared by Heyden, pe. Further found P.K. Nail as recorded in LCRC in Liber 2, Page 75, measuring S77°W 10.44 feet from 1" iron bar. P.K. Nail appears to be referenced on 1902 Plat of Bogardus' Addition to Pellston, (L.3 P.28) prepared by Heyden, pe., and 1906 Plat of Bogardus 2nd Addition (L.4 P.01) prepared by Keep. Appears as though Heyden may have changed his mind between 1883 plat and 1902 plat, (Point of Commencement, 1/4 post notes 295 feet in 1883, Whereby Point of Commencement, 1/4 post is 305 feet on 1902, & 1906 plats). 1910 Main measures 821 feet from centerline of railroad to 1/4 corner, (see county surveyor notes, bk. 4, pg. 40). 1993 Oelke, measures 821 feet from centerline of railroad to 1" Iron Bar. P.K. Nail, over 5/8" Re-Rod, which is above T-Iron didn't come into existence until 1956, by ECRC which states T-Iron set by MDSH for Consumers Power, whereby 1" solid rod has been in place since before 1956, although Bidstrup didn't find until 1979. Although corner as recorded in L. 2, P. 75 was used extensively by prior surveyors the corner to be used for remonumentation corner will be the corner recorded on LCRC in Liber 3, Page 120. This corner is validated by the Original Plat in 1883, and further matches Main 1910 measure to railroad. THIS POSITION IS ACCEPTED BY THE EMMET COUNTY REMONUMENTATION GROUP AS A FAITHFUL AND CAREFUL PERPETUATION OF THE POSITION OF THE ORIGINAL CORNER.

C. Description of monument for corner and accessories established to perpetuate locating the position of the corner:

H-13 (sc), aka H-1(cc),
Found 1" iron bar and replaced with a 2" diameter, 30" long PVC Pipe with a Base magnet and a standard Brass Emmet County Remonumentation Cap. Further set a monument box to preserve corner position.

- Witnesses:
- (8) S30°W 31.50' - Power Pole (spike w/10710 cap in face)
 - (9) S60°E 68.86' - Power Pole (spike in south side)
 - (10) N49°E 26.44' - 18" Maple (spike in face)
 - (11) N07°W 39.07' - 12" Spruce (spike w/37282 cap in face)
 - (12) S77°W 10.43' - P.K. Nail
 - (13) N54°W 39.40' - 24" Maple (spike in face)

Signed by Thomas D. Swenor
Surveyor's Michigan License No. 37282

Date 12-31-98

	A	B	C	D	E	F	G	H	I	J	K	L	M
2	6		5		4		3		2		1		
3													
4	7		8		9		10		11		12		
5													
6	16		17		16		15		14		13		
7													
8	19		20		21		22		23		24		
9													
10	30		29		28		27		26		25		
11													
12	31		32		33		34		35		36		
13													

APPROVED LAND CORNER
P.A. 345 OF 1990
Emmet County
Thomas D. Swenor
ECRC Reg 12-31-98

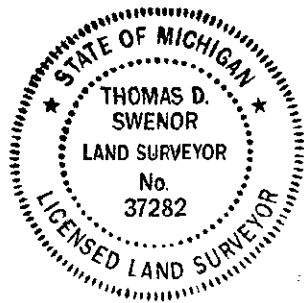

SECTION
EMMET COUNTY REMONUMENTATION PROGRAM
CORNER NO. 68
T37N R4W H-13

A. DESCRIPTION OF ORIGINAL MONUMENT AND ACCESSORIES AND/OR SUBSEQUENT RESTORATION

Date	Surveyor	Found	(Witnesses)
1840	GLO	Set Post	(1) Beech 9 - N17W 26 (2) Beech 8 - N85W 6
1883	Heyden	Plat of Pellston (L. 1, P. 31), shows corner	
1893	Main	L1, P. 306-307), fd cor, set witness posts N & E.	
1902	Heyden	Plat of Bogardus' Addition to Pellston (L. 3, P. 28), Shows corner.	
1906	Keep	Plat of Bogardus Second Addition to Pellston (L. 4, P. 01), corner is gas pipe	
1910	Main	(County Surveyor Notes Bk. 4, P. 40), ties to cor. from road survey.	
1916	Main	(L. 1, P. 46), Found corner gas pipe & old cedar post.	
1956	ECRC	Says M.D. St H. set T-iron, for Consumers Power	(3) N54°E 36.2' - 14" Maple set nail (4) S10°E 34.55' - 30" Cottonwood set nail (5) N48°W 33.65' - 14" Maple set nail
1968	Bidstrup	Survey of Pellston, shows sybol @ corner	
1969	GE Young	Survey, found T-iron	
1974	Bidstrup	Survey for Wilbert, Shows Found T-iron, raised with 5/8" iron rod	(3) N55°E 35.97' - 14" Maple (6) S07°W 25.60' - Power Pole (5) N47°W 33.41' - 16" Maple
1978	Fausser	Consumers Power notes, Found T-iron bent top.	(3) N54°E 35.96' - 16" Maple tagged #10710 (6) S11°W 25.62' - Power Pole tagged #10710 (5) N43°W 33.43' - 20" Maple tagged #10710
1979	Bidstrup	Survey for Maile, found T-iron and also found 1" square iron 9.33' E and 3.17' N	(3) N55°E 35.97' - 14" Maple (6) S07°W 25.60' - Power Pole (5) N47°W 33.41' - 16" Maple
1980	Green	L.C.R.C. (L. 2, P. 75) Found 5/8" iron rod	(3) N55°E 35.95' - 20" Maple tagged #10710 (6) S10°W 25.59' - Power Pole tagged #10710 (5) N44°W 33.42' - 20" Maple tagged #10710
1980 to present	Numerous surveyors	used 5/8" iron rod	(7) S44°E 56.40' - 7" Red Pine
1993	Oelke	Survey for Benac, used 1" iron bar. 9.33' E and 3.17' N of 5/8" iron rod	
1993	Swenor	L.C.R.C. (L. 3, P. 120) used Oelke found 1" iron	(8) S30°W 31.60' - Power Pole tagged #10710 (9) S60°E 68.86' - Power Pole spike south side (10) N49°E 26.44' - 16" Maple spike in face (11) N05°W 39.07' - 12" spruce tagged #37282 (12) S77°W 10.44' - 5/8" solid rod