

MICHIGAN
DEPARTMENT OF CONSERVATION
FORESTRY DIVISION

LAND CORNER RECORD

T. 37 N. R. 5 W.

Emmet COUNTY

DESCRIPTION OF CORNER Section corner common to Sections 21 - 22 - 27 - 28

CORNER MONUMENT Set 1" pipe with 4" brass cap

DATE MONUMENT PLACED AND WITNESSED June 13, 1962

WITNESSES TO CORNER.....

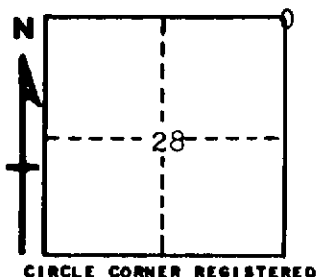

7" Spruce N 2 W 70.5'

9" Cedar Stump N 82 E 22.3'

AND 6" W. Birch S 69 W 21.8'

DESCRIPTION IN DETAIL AS TO HOW CORNER WAS LOCATED AND IDENTIFIED OR RESTORED.

This corner was restored while making a survey in this area. Set corner in accordance with the record of survey by S. Main, County Surveyor, executed in 1912 at which time he restored a previous survey of 1895. Placed corner at Main's record measurement from NW corner Section 28 and from E 1/4 corner. Unable to locate a previous post which was not referenced, but believe this corner is restored in conformity with previous surveys and fits the pattern of survey for Section 28.

SURVEYOR'S SEAL

SIGNED *Kenneth J. Osting* DATE June 14, 1962
REGISTERED LAND SURVEYOR