

SURVEY & REMONUMENTATION

MAY 31 2000

Remonumentation corner under P.A. 345, Michigan P.A. of 1990

SECTION

LAND CORNER RECORDATION CERTIFICATE
Filing Requirement of Act 74, Mich. P.A. 1970

DEED LIBER 2562 PAGE 570

For corners in

<u>Genesee</u> (County)	Located In:	Corner Code #:
	<u>Argentine Township</u>	
1. Public Land Survey	T <u>T5N</u> R <u>R5E</u>	<u>L-3</u>
	T _____ R _____	_____
	T _____ R _____	_____
	T _____ R _____	_____
2. Property Controlling in Section	S _____ T _____ R _____	_____
	S _____ T _____ R _____	_____
3. Miscellaneous Property in Sec.	S _____ T _____ R _____	_____
	S _____ T _____ R _____	_____
4. Lot No. _____, Recorded Plat _____		
5. Private Claims _____		

RECORDED
REGISTERED DEEDS
JUN 12 8 47 AM '95
GENESEE COUNTY REGISTER OF DEEDS
2093
Register of Deeds Stamp & File Number

900 filed & recd

	A	B	C	D	E	F	G	H	I	J	K	L	M
2	6		5		4		3		2		1		
3													
4	7		8		9		10		11		12		
5													
6	18		17		16		15		14		13		
7													
8	19		20		21		22		23		24		
9													
10	30		29		28		27		26		25		
11													
12	31		32		33		34		35		36		
13													

I, James E. Kovas, PS, PE in a field survey on September 27, 19 94, do hereby certify that under requirements of P.A. 74, Michigan P.A. of 1970, the corner points mentioned in lines 1 and 2 above were in conformance with regulations and rules therefore as required in the current manual of survey instructions of the United States Department of the Interior, Bureau of Land Management or by a decree of a Court of Law and/or that the corner points mentioned in lines 3, 4 and 5 above were in conformance with the rules of the Michigan Board of Land Surveyors or by a Decree of a Court of Law; established, re-established, monumented, re-monumented, recovered, found as expressed below:

NOTE: Not more than 4 corners, all in the same town and range, may be recorded on this certificate.

A. Description of original monument and accessories and/or subsequent restoration:

- 1823/GLO - John Mullett, DS, set post, two accessories
- 1847/RODeeds - No monument description, County Surveyor Post Witness Book, two accessories
- Date Unknown, G.C.R.C.- Found Stone Genesee County Witness Book, cor. No. 52, three accessories
- 1934/G.C.R.C - G.C.R.C. road plans, Project No. T-124, Dwg. No. 134, Field No. 92, L3 to M3=2694.75'
- 1934/G.C.R.C - G.C.R.C. road plans, Project No. T-208, Dwg. No. 208, Field No. 206, K3 to L3=2680.94'
- 1985/RODeeds - Found 3/4" bolt, L.C.R.C. D.L. 2276 P. 383, Joseph A. Wizynajtyts, RLS #21585, four accessories

Ratified by Peer Group in accordance with P.A. 345, 1990
Co. Rep. Carl Carlson
Date Oct 25, 1994

B. Description of corner evidence found and/or method applied in restoring or reestablishing corner:

1994/REMON. SUMMARY OF EXISTING ACCESSORIES

1994/Remon	Found 3/4" Bolt, Wade-Trim, Inc. Remonumentation		
1978/Survey	S15W 87.46' Spk./w East Side 66" twin Oak	(measured to center)	87.5'
	S45W 93.09' Spk/w power pole		93.11'
1985/RODeeds	S35W 87.54' Nail & tag twin 36" Oak		87.45'
	S45W 92.68' Nail & tag NE face P. Pole		93.11'
	North 33.00' Delta iron		33.00'
	N50W 66.65' P.K. nail in triple 6" Shag Bark Hickory	(measured to center)	67.32'

Ratified by Genesee County Peer Group, October 25, 1994.

C. Description of monument for corner and accessories established to perpetuate locating the position of the corner:

ACCESSORIES:

1994/Remon	Found 3/4" Bolt, Wade-Trim, Inc. Remonumentation	L3 to M3=2693.56' E.D.M.
S15W 87.45'	to Nail/tag in E. Face of 70" twin Oak	K3 to L3=2681.50' E.D.M.
S45W 93.11'	to Nail/in NE Face P. Pole	
N50W 67.32"	to Nail/tag in S. Face triple 8" Shag Bark Hickory	
North 33.00'	to Iron with Delta cap	

I set the standard 30"X2 3/8" Berntsen stainless steel tube with brass remonumentation cap over the 3/4" Bolt.

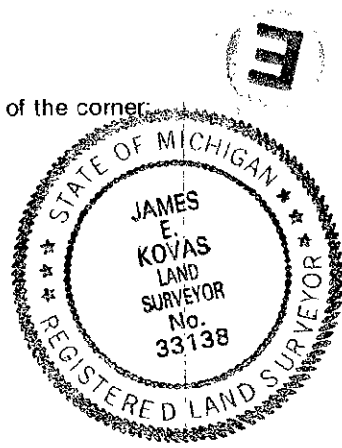

Signed by James E. Kovas Date 12/6/94
Surveyor's Michigan License No. 33138

85