

SURVEY & REMONUMENTATION

MAY 31 2000

Remonumentation corner under P.A. 345, Michigan P.A. of 1990

SECTION

LAND CORNER RECORDATION CERTIFICATE

Filing Requirement of Act 74, Mich. P.A. 1970

DEED LIBER 2562 PAGE 436

For corners in

<u>Genesee</u> (County)	Located In:	Corner Code #
	<u>Fenton Township</u>	
1. Public Land Survey	T <u>T5N</u> R <u>R6E</u>	<u>C-3</u>
	T _____ R _____	_____
	T _____ R _____	_____
	T _____ R _____	_____
2. Property Controlling in Section	S _____ T _____ R _____	_____
	S _____ T _____ R _____	_____
3. Miscellaneous Property in Sec.	S _____ T _____ R _____	_____
	S _____ T _____ R _____	_____

RECORDED
REGISTERED DEEDS
JAN 11 11 45 AM '99
GENESEE COUNTY REGISTER OF DEEDS
1870
Register of Deeds Stamp & File Number

4. Lot No. _____, Recorded Plat _____
5. Private Claims _____

I, James E. Kovas, PS, PE in a field survey on September 27, 19 94, do hereby certify that under requirements of P.A. 74, Michigan P.A. of 1970, the corner points mentioned in lines 1 and 2 above were in conformance with regulations and rules therefore as required in the current manual of survey instructions of the United States Department of the Interior, Bureau of Land Management or by a decree of a Court of Law and/or that the corner points mentioned in lines 3, 4 and 5 above were in conformance with the rules of the Michigan Board of Land Surveyors or by a Decree of a Court of Law; established, re-established, re-established, re-monumented, recovered, found as expressed below:

9.00 Filed & Recd

	A	B	C	D	E	F	G	H	I	J	K	L	M
2	6	5	4	3	2	1							
3													
4	7	8	9	10	11	12							
5													
6	18	17	16	15	14	13							
7													
8	19	20	21	22	23	24							
9													
10	30	29	28	27	26	25							
11													
12	31	32	33	34	35	36							
13													

NOTE: Not more than 4 corners, all in the same town and range, may be recorded on this certificate.

- A. Description of original monument and accessories and/or subsequent restoration:
- 1823/GLO - Joseph Fletcher, DS, set post, one accessory
 - 1847/RODeeds - No monument description, County Surveyor Post Witness Book, one accessory
 - 1847/RODeeds - No monument description, County Surveyor Post Witness Book, one accessory
 - 1974/RODeeds - Found Rod, Set "T" Iron, recorded survey by Gould Engineering, Inc., D.L. 1900 P. 783, Elbex B. Harris, RLS #9431, three accessories
 - 1974/RODeeds - Found 1/4" Rod, Set "T" Iron, recorded survey by Gould Engineering, Inc., D.L. 1900 P783, Elbex B. Harris, RLS #9431, three accessories
 - 1992/Survey - Found Iron, unrecorded Survey by CHIMP, Job No. 92045900, G. Misjak, LS #21271, four accessories.

Ratified by Peer Group accordance with P.A. 345, 19
Co. Rep Carl Carlson
Date Nov 23, 1994

- B. Description of corner evidence found and/or method applied in restoring or reestablishing corner:

1994/REMON. SUMMARY OF EXISTING ACCESSORIES

1994 Remonun., Found 1/2" re-rod, Wade-Trim, Inc. Remonumentation	
1974/RODeeds, S80E 26.51' Nail and tag N face of 4" Elm (now 12" & dead)	(measured to center) 26.7'
1992/Survey N45E 9.69' Gould Nail/tag 18" tree (tree now dead)	(measured to center) 9.5'
S80E 26.50' 12" tree (now dead)	(measured to center) 26.7'
S45E 30.00' 10" Ash (now 16")	(measured to center) 30.00'

Ratified by Genesee County Peer Group, November 23, 1994

- C. Description of monument for corner and accessories established to perpetuate locating the position of the corner:

ACCESSORIES:
1994 Remonun., Found 1/2" re-rod, Wade-Trim, Inc. Remonumentation
S45E 29.64' to Nail/remon-tag in 18" Ash
N45E 0.60' to face metal fence post
N50E 24.28' to Nail/remon-tag in NW face 20" Poplar
N20E 13.19' to Nail/remon-tag in E face 14" Ash

I set the standard 30" x 2 3/8" Beintzen stainless steel tube with brass remonumentation cap over 1/2" re-rod

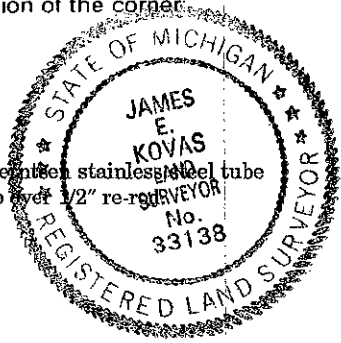

Signed by James E. Kovas Date 12/6/94
Surveyor's Michigan License No. 33138

