

SURVEY & REMONUMENTATION

MAY 31 2000 Remonumentation corner under P.A. 345, Michigan P.A. of 1990

LAND CORNER RECORDATION CERTIFICATE

Filing Requirement of Act 74, Mich. P.A. 1970

SECTION

For corners in

DEED LIBER 2562 PAGE 567
 REGISTERED
 REGISTER OF DEEDS
 JAN 12 8 47 AM '95
 GENESSEE COUNTY REGISTER OF DEEDS
 2090
 Register of Deeds Stamp & File Number

Located In: Genesee (County) Corner Code # E-3
Fenton Township

1. Public Land Survey	T <u>T5N</u> R <u>R6E</u>	<u>E-3</u>
	T _____ R _____	_____
	T _____ R _____	_____
	T _____ R _____	_____
2. Property Controlling in Section	S _____ T _____ R _____	_____
	S _____ T _____ R _____	_____
3. Miscellaneous Property in Sec.	S _____ T _____ R _____	_____
	S _____ T _____ R _____	_____
4. Lot No. _____, Recorded Plat _____		
5. Private Claims _____		

900 Filed sheet

A	B	C	D	E	F	G	H	I	J	K	L	M
2	6		5		4		3		2		1	
3				●								
4	7		8		9		10		11		12	
5												
6	18		17		16		15		14		13	
7												
8	19		20		21		22		23		24	
9												
10	30		29		28		27		26		25	
11												
12	31		32		33		34		35		36	
13												

I, James E. Kovas, PS, PE in a field survey on September 27, 19 94, do hereby certify that under requirements of P.A. 74, Michigan P.A. of 1970, the corner points mentioned in lines 1 and 2 above were in conformance with regulations and rules therefore as required in the current manual of survey instructions of the United States Department of the Interior, Bureau of Land Management or by a decree of a Court of Law and/or that the corner points mentioned in lines 3, 4 and 5 above were in conformance with the rules of the Michigan Board of Land Surveyors or by a Decree of a Court of Law; established, re-established, monumented, re-monumented, recovered, found as expressed below:

NOTE: Not more than 4 corners, all in the same town and range, may be recorded on this certificate.

A. Description of original monument and accessories and/or subsequent restoration:

1823/GLO - Joseph Fletcher, DS, set post, two accessories
 1847/RODeeds - No monument description, County Surveyor Post
 Witness Book, two accessories
 1993/Survey - Set iron, unrecorded survey by Flint Surveying & Engineering Co., Job No. 14589, survey for Rev. F.E. Burke, Carl H. Carlson, L.S. #9189, four accessories

Ratified by Peer Group in accordance with P.A. 345, 1990

Co. Rep. Carl Carlson
 Date Nov 23, 1994

B. Description of corner evidence found and/or method applied in restoring or reestablishing corner:

1994/REMON. SUMMARY OF EXISTING ACCESSORIES

1994 Remonun., Found 1/2" Capped Iron (C. Carlson RLS #9189), Wade-Trim, Inc. Remonumentation
 1993/Survey North 7.51' 15" Oak (measured to C. Carlson tag)
 N45W 33.14' 12" Oak (measured to center)
 N60E 15.05' 20" Oak (measured to C. Carlson tag)
 East 31.60' 14" Oak (measured to C. Carlson tag)

MEASURED

7.53'
 33.0'
 15.08'
 31.64'

Ratified by Genesee County Peer Group, November 23, 1994

C. Description of monument for corner and accessories established to perpetuate locating the position of the corner:

ACCESSORIES:

1994 Remonun., Found 1/2" Capped Iron (C. Carlson RLS #9189), Wade-Trim, Inc. Remonumentation
 North 7.53' Nail/Carlson-tag in 20" Oak
 N64E 15.08' Nail/Carlson-tag in 20" Oak
 N90E 31.64' Nail/Carlson-tag in 14" Oak
 N50W 32.98' Nail/Remon-tag 12" Oak

I set the standard 30" x 2 3/8" Berntsen stainless steel tube with brass remonumentation cap over 1/2" Capped Iron.

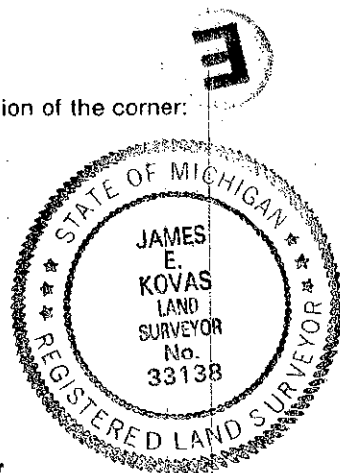

Signed by James E. Kovas
 Surveyor's Michigan License No. 33138

Date 12/14/94

93