

SURVEY & REMONUMENTATION

MAY 31 2000

Remonumentation corner under P.A. 345, Michigan P.A. of 1990

SECTION

LAND CORNER RECORDATION CERTIFICATE

Filing Requirement of Act 74, Mich. P.A. 1970

DEED LIBER. 2562 PAGE 559

For corners in

Genesee

(County)

Located In:

Corner Code #

Fenton Township

J-3 OFF SET

335' E. of the S. 1/4 Cor. Section 2, T5N, R6E

1. Public Land Survey

T T5N R R6E

T R

T R

T R

2. Property Controlling in Section

S T R

S T R

3. Miscellaneous

S T R

Property in Sec.

S T R

4. Lot No. _____, Recorded Plat _____

5. Private Claims _____

RECORDED
REGISTERED
JUN 12 8 47 AM '99
GENESEE COUNTY REGISTER OF DEEDS
2082
Register of Deeds Stamp & File Number

9.00 filed & recd

A	B	C	D	E	F	G	H	I	J	K	L	A
2	6	5	4	3	2	1						
3												
4	7	8	9	10	11	12						
5												
6	18	17	16	15	14	13						
7												
8	19	20	21	22	23	24						
9												
10	30	29	28	27	26	25						
11												
12	31	32	33	34	35	36						
13												

I, James E. Kovas, PS, PE in a field survey on September 27, 19 94, do hereby certify that under requirements of P.A. 74, Michigan P.A. of 1970, the corner points mentioned in lines 1 and 2 above were in conformance with regulations and rules therefore as required in the current manual of survey instructions of the United States Department of the Interior, Bureau of Land Management or by a decree of a Court of Law and/or that the corner points mentioned in lines 3, 4 and 5 above were in conformance with the rules of the Michigan Board of Land Surveyors or by a Decree of a Court of Law; established, re-established, monumented, re-monumented, recovered, found as expressed below:

NOTE: Not more than 4 corners, all in the same town and range, may be recorded on this certificate.

A. Description of original monument and accessories and/or subsequent restoration:

1823/GLO - No monument set, corner falls in Lake

Ratified by Peer Group in accordance with P.A. 345, 1990
Co. Rep. Carl Carlson
Date Dec 21, 1994

B. Description of corner evidence found and/or method applied in restoring or reestablishing corner:

1994/REMON. SUMMARY OF EXISTING ACCESSORIES:

The Remonumentation Peer Group decided that our company should set a reference corner to the East of J3, after discovering the actual corner (J3) was in a lake. The GLO notes show that the corner fell in a lake and was not set.

Terrestrial surveying techniques were used to obtain the positions of I3 and K3 (Fenton Twp). A 1/2" re-rod was set at the East edge of Lake Fenton. The resulting distances are shown in this report. A L.C.R.C. will be recorded for this corner, calling it a "reference corner" to J3 of Fenton Township.

Ratified by Genesee County peer Group December 21, 1994.

C. Description of monument for corner and accessories established to perpetuate locating the position of the corner:

ACCESSORIES:

The set corner is 335' East of the theoretical split (J3) of the section line.

- N30°E 34.46' to Nail/Remon. tag in 18" tree
- East 50.33' to West corner steel base of light pole for Fenton Harbor Condo 2226
- East 1.46' to Nail/Remon. tag in post for a 6' high privacy fence
- S20°E 17.17' to Nail/Remon. tag in post for a 6' high privacy fence
- S40°W 2.38' to corner of railroad tie seawall

MEASURED

- I3 to K3 5370.71'
- I3 to J3OFF 3030.35'
- J3OFF to K3 2340.36'

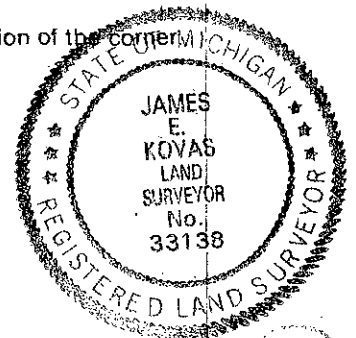

I set the standard 30"x2 3/8" Berntsen stainless steel tube with brass remonumentation cap.

Signed by James E. Kovas

Date 12/23/94

Surveyor's Michigan License No. 33138

85
86