

**SURVEY & REMONUMENTATION**

MAY 31 2000

Remonumentation corner under P.A. 345, Michigan P.A. of 1990

**SECTION**

**LAND CORNER RECORDATION CERTIFICATE**  
Filing Requirement of Act 74, Mich. P.A. 1970

DEED LIBER 2562 PAGE 563

For corners in Genesee

(County)

Located In: Corner Code #

Fenton Township

- |                                       |                         |       |
|---------------------------------------|-------------------------|-------|
| 1. Public Land Survey                 | T T5N R R6E             | M-2   |
|                                       | T _____ R _____         | _____ |
|                                       | T _____ R _____         | _____ |
|                                       | T _____ R _____         | _____ |
| 2. Property Controlling in Section    | S _____ T _____ R _____ | _____ |
|                                       | S _____ T _____ R _____ | _____ |
| 3. Miscellaneous Property in Sec.     | S _____ T _____ R _____ | _____ |
|                                       | S _____ T _____ R _____ | _____ |
| 4. Lot No. _____, Recorded Plat _____ |                         |       |
| 5. Private Claims _____               |                         |       |

RECORDED  
REGISTERED OF DEEDS  
JAN 12 8 47 AM '95  
2086  
Register of Deeds Stamp & File Number

9.00 filed & rec'd

	A	B	C	D	E	F	G	H	I	J	K	L	M
2	6		5		4		3		2		1		
3													
4	7		8		9		10		11		12		
5													
6	18		17		16		15		14		13		
7													
8	19		20		21		22		23		24		
9													
10	30		29		28		27		26		25		
11													
12	31		32		33		34		35		36		
13													

I, James E. Kovas, PS, PE, in a field survey on September 27, 19 94, do hereby certify that under requirements of P.A. 74, Michigan P.A. of 1970, the corner points mentioned in lines 1 and 2 above were in conformance with regulations and rules therefore as required in the current manual of survey instructions of the United States Department of the Interior, Bureau of Land Management or by a decree of a Court of Law and/or that the corner points mentioned in lines 3, 4 and 5 above were in conformance with the rules of the Michigan Board of Land Surveyors or by a Decree of a Court of Law; established, re-established, monumented, re-monumented, recovered, found as expressed below:

**NOTE: Not more than 4 corners, all in the same town and range, may be recorded on this certificate.**

A. Description of original monument and accessories and/or subsequent restoration:

- 1823/GLO - J. Fletcher, DS, set post, two accessories
- 1847/RODeeds - No monument description, County Surveyor Post Witness Book, two accessories

B. Description of corner evidence found and/or method applied in restoring or reestablishing corner:

**1994/REMON. SUMMARY OF EXISTING ACCESSORIES:**  
1994 REMON - Found 1/2" Re-rod in Mon. Box, Wade-Trim, Inc. Remonumentation  
**PHYSICAL OCCUPATION NOTES:**  
The mon. box is in the centerline of Thompson Road.  
The mon. box also fits the apparent property line due North.  
The "Genesee County" sign is N20W at the edge of road.  
The area South was search and nothing was found.

Ratified by Peer Group in accordance with P.A. 345, 1990  
Co. Rep. Carl Carlson  
Date Nov 23, 1994

Ratified by Genesee County Peer Group November 23, 1994

C. Description of monument for corner and accessories established to perpetuate locating the position of the corner:

**ACCESSORIES:**  
1994 REMON. - Found 1/2" Re-rod in Mon. Box, Wade-Trim, Inc. Remonumentation  
North 51.07' Gould tag in W. Face P. Pole  
South 26.37' Nail /Remon-tag in W. Face 8" Beech  
N45E 82.50' to S.E. corner of house #1003 Thompson Rd.  
N45W 51.35' Nail/Remon-tag N.E. Face 8" Ash

I set the standard 30" x 2 3/8" Bernsten stainless steel tube with brass remonumentation cap over 1/2" Re-Rod.

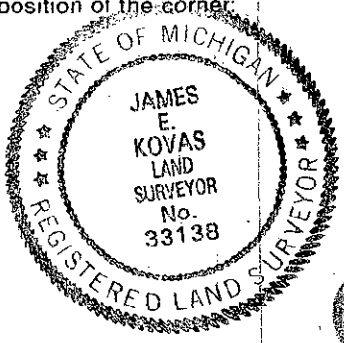

Signed by James E. Kovas Date 12/21/94  
Surveyor's Michigan License No. 33138

89