

SURVEY & REMONUMENTATION

MAY 31 2000

Remonumentation corner under P.A. 345, Michigan P.A. of 1990

SECTION

LAND CORNER RECORDATION CERTIFICATE

Filing Requirement of Act 74, Mich. P.A. 1970

DEED LIBER 2562 PAGE 561

For corners in

Genesee (County)	Located In:	Corner Code #
	Fenton Township	
1. Public Land Survey	T <u>T5N</u> R <u>R6E</u>	<u>M-3</u>
	T _____ R _____	_____
	T _____ R _____	_____
	T _____ R _____	_____
2. Property Controlling in Section	S _____ T _____ R _____	_____
	S _____ T _____ R _____	_____
3. Miscellaneous Property in Sec.	S _____ T _____ R _____	_____
	S _____ T _____ R _____	_____
4. Lot No. _____, Recorded Plat _____		
5. Private Claims _____		

RECORDED
REGISTERED OF DEEDS
JAN 12 8 47 AM '95
GENESEE COUNTY REGISTER OF DEEDS
2084
Register of Deeds Stamp & File Number

9.00 Filed & Recd

A	B	C	D	E	F	G	H	I	J	K	L	M
2	6	5	4	3	2	1						
3												
4	7	8	9	10	11	12						
5												
6	13	17	16	15	14	13						
7												
8	19	20	21	22	23	24						
9												
10	30	29	28	27	26	25						
11												
12	31	32	33	34	35	36						
13												

I, James E. Kovas, PS, PE, in a field survey on September 27, 1994, do hereby certify that under requirements of P.A. 74, Michigan P.A. of 1970, the corner points mentioned in lines 1 and 2 above were in conformance with regulations and rules therefore as required in the current manual of survey instructions of the United States Department of the Interior, Bureau of Land Management or by a decree of a Court of Law and/or that the corner points mentioned in lines 3, 4 and 5 above were in conformance with the rules of the Michigan Board of Land Surveyors or by a Decree of a Court of Law; established, re-established, monumented, re-monumented, recovered, found as expressed below:

NOTE: Not more than 4 corners, all in the same town and range, may be recorded on this certificate.

A. Description of original monument and accessories and/or subsequent restoration:

- 1823/GLO - J. Fletcher, DS, set post, two accessories
- 1847/RODeeds - No monument description, County Surveyor Post Witness Book, two accessories
- 1973/RODeeds - No monument description, deed to Fenton Orchards, DL 2235, P. 117

B. Description of corner evidence found and/or method applied in restoring or reestablishing corner:

1994/REMON. SUMMARY OF EXISTING ACCESSORIES

The corner was placed on the line connecting M2 and M4 (Fenton Twp). This distance from M3 to M4 was obtained from said deed. Terrestrial and GPS surveying techniques were employed for this procedure. The resulting measurements are shown.

	GPS BEARING	MEASURED
M2 to M3	S01-47-25E	2731.34'
M3 to M4	S01-47-25E	2696.04'
M2 to M4	S01-47-25E	5427.38'
M4 to M5	S01-59-18E	2697.41'

Ratified by Peer Group in accordance with P.A. 345, 1990

Co. Rep. Paul Carlson
Date Dec 7, 1994

Ratified by Genesee County Peer Group December 7, 1994.

C. Description of monument for corner and accessories established to perpetuate locating the position of the corner:

ACCESSORIES:

- 1994/Remon Set 5/8" Re-Rod by using the said deed distance and placing corner on line connecting M2 and M4 (Fenton Twp).
- Wade-Trim, Inc. Remonumentation:
 - East 5.05' Nail/Remon-tag S face 24" Oak
 - S45E 15.13' Nail/Remon-tag NE face 12" Oak
 - N05E 33.02' Nail/Remon-tag SE face 18" Oak
 - West 32.30' Nail/Remon-tag N face 8" Poplar

I set the standard 30" x 2 3/8" Bernsten stainless steel tube with brass remonumentation cap over 5/8" Re-Rod.

Signed by James E. Kovas Date 12/21/94

Surveyor's Michigan License No. 33138

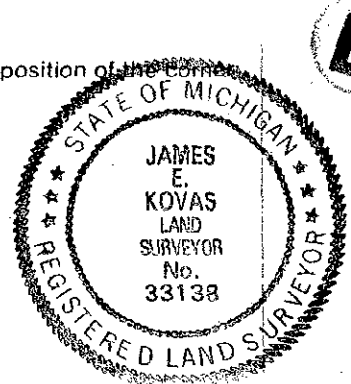

87