

SURVEY & REMONUMENTATION

MAY 31 2000

Remonumentation corner under P.A. 345, Michigan P.A. of 1990

SECTION

LAND CORNER RECORDATION CERTIFICATE
Filing Requirement of Act 74, Mich. P.A. 1970

DEED LIBER 2562 PAGE 568

For corners in Genesee

(County)	Located In:	Corner Code #:
	Fenton Township	
1. Public Land Survey	T <u>T5N</u> R <u>R6E</u>	<u>M-4</u>
	T _____ R _____	_____
	T _____ R _____	_____
	T _____ R _____	_____
2. Property Controlling in Section	S _____ T _____ R _____	_____
	S _____ T _____ R _____	_____
3. Miscellaneous Property in Sec.	S _____ T _____ R _____	_____
	S _____ T _____ R _____	_____
4. Lot No. _____, Recorded Plat _____		
5. Private Claims _____		

RECORDED
REGISTER OF DEEDS
JAN 12 8 47 AM '94
GENESEE COUNTY REGISTER OF DEEDS
2091
Register of Deeds Stamp & File Number
900 Filed & Recd

A	B	C	D	E	F	G	H	I	J	K	L	M
2	6	5	4	3	2	1						
3												
4	7	8	9	10	11	12						
5												
6	18	17	16	15	14	13						
7												
8	19	20	21	22	23	24						
9												
10	30	29	28	27	26	25						
11												
12	31	32	33	34	35	36						
13												

I, James E. Kovas, PS, PE, in a field survey on September 27, 1994, do hereby certify that under requirements of P.A. 74, Michigan P.A. of 1970, the corner points mentioned in lines 1 and 2 above were in conformance with regulations and rules therefore as required in the current manual of survey instructions of the United States Department of the Interior, Bureau of Land Management or by a decree of a Court of Law and/or that the corner points mentioned in lines 3, 4 and 5 above were in conformance with the rules of the Michigan Board of Land Surveyors or by a Decree of a Court of Law; established, re-established, monumented, re-monumented, recovered, found as expressed below:

NOTE: Not more than 4 corners, all in the same town and range, may be recorded on this certificate.

A. Description of original monument and accessories and/or subsequent restoration:
1823/GLO - J. Fletcher, DS, set post, two accessories
1847/RODeeds - No monument description, County Surveyor Post
Witness Book, two accessories

Ratified by Peer Group in accordance with P.A. 345, 1990
Co. Rep. Carl Carbone
Date Nov-23-1994

B. Description of corner evidence found and/or method applied in restoring or reestablishing corner:

1994/REMON. SUMMARY OF EXISTING ACCESSORIES:
1994 REMON. - Found 3/4" Pipe, Wade-Trim, Inc. Remonumentation
PHYSICAL OCCUPATION NOTES:
The pipe is in the weeds directly North of a ninety degree curve in Eddy Lake Road and is buried approximately 1' deep. The pinch pipe is 29.40' East of a fence post. The fence runs to the West and to the South. The pinch pipe is directly on line with the fence running West. Also, the pinch pipe is directly on line with the center of Eddy Lake Road to the South and 70' North of the center line of the road running East.

Ratified by Genesee County Peer Group November 23, 1994

C. Description of monument for corner and accessories established to perpetuate locating the position of the corner:

ACCESSORIES: 3/4" Pipe
1994 REMON. - Found _____, Wade-Trim, Inc. Remonumentation
West 29.40' to Face of a steel Fence Post
East 59.48' to Nail/Remon-tag N. Face 12" Poplar
S10W 58.02' to Nail/Remon-tag E. Face 7" Crab Apple
S45E 88.54' to Nail/Remon-tag S. Face tripple 24" Ash

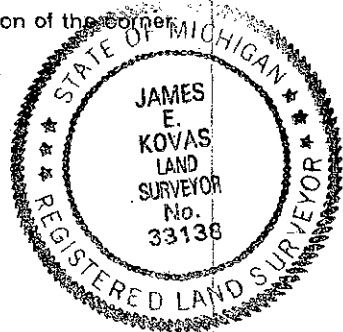

I set the standard 30" x 2 3/8" Bernstein stainless steel tube with brass remonumentation cap over 3/4" PIPE

Signed by James E. Kovas Date 12/14/94
Surveyor's Michigan License No. 33138

94