

SURVEY & REMONUMENTATION

MAY 31 2000

SECTION

Remonumentation corner under P.A. 345, Michigan P.A. of 1990

LAND CORNER RECORDATION CERTIFICATE  
Filing Requirement of Act 74, Mich. P.A. 1970

DEED LIBER REGISTER OF DEEDS  
GENESEE COUNTY  
2562 PAGE 565  
JAN 12 8 47 AM '95  
RECORDED  
REGISTERED OF RECORD  
2088

For corners in

Genesee  
(County)

Located In:

Corner Code -#

Fenton Township

1. Public Land Survey

T 15N R R6E M-5

T R

T R

T R

2. Property Controlling in Section

S T R

S T R

3. Miscellaneous Property in Sec.

S T R

S T R

4. Lot No. , Recorded Plat

5. Private Claims

Register of Deeds Stamp & File Number

9.00 Filed & Recd

	A	B	C	D	E	F	G	H	I	J	K	L	M
2	6	5	4	3	2	1							
3													
4	7	8	9	10	11	12							
5													
6	18	17	16	15	14	13							
7													
8	19	20	21	22	23	24							
9													
10	30	29	28	27	26	25							
11													
12	31	32	33	34	35	36							
13													

I, James E. Kovas, PS, PE, in a field survey on September 27, 1994, do hereby certify that under requirements of P.A. 74, Michigan P.A. of 1970, the corner points mentioned in lines 1 and 2 above were in conformance with regulations and rules therefore as required in the current manual of survey instructions of the United States Department of the Interior, Bureau of Land Management or by a decree of a Court of Law and/or that the corner points mentioned in lines 3, 4 and 5 above were in conformance with the rules of the Michigan Board of Land Surveyors or by a Decree of a Court of Law; established, re-established, monumented, re-monumented, recovered, found as expressed below:

NOTE: Not more than 4 corners, all in the same town and range, may be recorded on this certificate.

A. Description of original monument and accessories and/or subsequent restoration:

1823/GLO - J. Fletcher, DS, set post, two accessories  
1847/RODeeds - No monument description, County Surveyor Post  
Witness Book, one accessory

B. Description of corner evidence found and/or method applied in restoring or reestablishing corner:

1994/REMON. SUMMARY OF EXISTING ACCESSORIES:  
1994 REMON - Found 1/2" Re-rod approx. 13" buried, Wade-Trim, Inc. Remonumentation

Ratified by Genesee County Peer Group December 7, 1994.

Ratified by Peer Group in accordance with P.A. 345, 1990  
Co. Rep. Carl Carlson  
Date Dec 7, 1994

C. Description of monument for corner and accessories established to perpetuate locating the position of the corner:

ACCESSORIES:  
1994 REMON. - Found 1/2" Re-rod approx. 13" buried, Wade-Trim, Inc. Remonumentation  
East 16.90' to Nail/Remon-tag top of guard rail post  
N50W 24.45' to Nail /Remon-tag top of guard rail post  
N30W 74.6' to Nail/Remon-tag in a concrete headwall at the West end of an 8' CMP  
S45E 28.48' to Nail/Remon-tag W Face 16" twin Elm

I set the standard 30" x 2 3/8" Bernstein stainless steel tube with brass remonumentation cap over 1/2" Re-Rod.

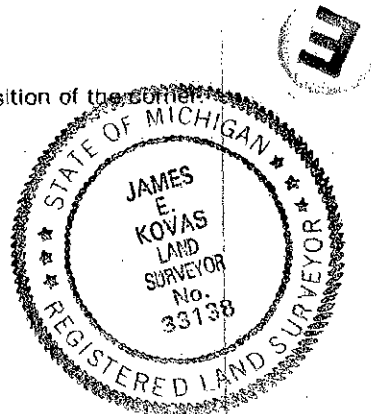

Signed by James E. Kovas Date 12/21/94  
Surveyor's Michigan License No. 33138

91