

MAY 31 2000

Remonumentation corner under P.A. 345, Michigan P.A. of 1990

SECTION

LAND CORNER RECORDATION CERTIFICATE

Filing Requirement of Act 74, Mich. P.A. 1970

For corners in

Genesee (County) Located In: Fenton Township Corner Code # M-7

1. Public Land Survey T T5N R R6E

2. Property Controlling in Section S T R

3. Miscellaneous Property in Sec. S T R

4. Lot No. Recorded Plat

5. Private Claims

DEED LIBER 2562 PAGE 557

RECORDED

REGISTERED OF DEEDS

GENESEE COUNTY REGISTER OF DEEDS

2089

Jan 12 8 47 AM '99

Register of Deeds Stamp & File Number

9.00 Filed & Recd

	A	B	C	D	E	F	G	H	I	J	K	L	M
2	6		5		4		3		2		1		
3													
4	7		8		9		10		11		12		
5													
6	18		17		16		15		14		13		
7													
8	19		20		21		22		23		24		
9													
10	30		29		28		27		26		25		
11													
12	31		32		33		34		35		36		
13													

I, James E. Kovas, PS, PE, in a field survey on September 27, 1994, do hereby certify that under requirements of P.A. 74, Michigan P.A. of 1970, the corner points mentioned in lines 1 and 2 above were in conformance with regulations and rules therefore as required in the current manual of survey instructions of the United States Department of the Interior, Bureau of Land Management or by a decree of a Court of Law and/or that the corner points mentioned in lines 3, 4 and 5 above were in conformance with the rules of the Michigan Board of Land Surveyors or by a Decree of a Court of Law; established, re-established, monumented, re-monumented, recovered, found as expressed below:

NOTE: Not more than 4 corners, all in the same town and range, may be recorded on this certificate.

A. Description of original monument and accessories and/or subsequent restoration:

1823/GLO - J. Fletcher, DS, set post, two accessories
 1847/RODeeds - No monument description, County Surveyor Post
 Witness Book, two accessories

Ratified by Peer Group in accordance with P.A. 345, 1990

Co. Rep. Carl Carlson
 Date Nov 23, 1994

B. Description of corner evidence found and/or method applied in restoring or reestablishing corner:

1994/REMON. SUMMARY OF EXISTING ACCESSORIES:
 1994/Remon - Found Concrete Monument, Wade-Trim, Inc. Remonumentation

M5 to M7= 5437.08' GPS
 M7 to M8= 2619.71' GPS

PHYSICAL OCCUPATION NOTES:
 The GLO notes call for a distance of 25 chains (1650') to the North of this corner to the end of a swamp. A distance of approximately 1650' was scaled off an aerial photo from the concrete monument to the edge of a swamp to the North. The concrete monument found is near an ancient fence corner running to the West and to the North. Also, by looking at the aerial photo, the section lines to the North and the West are very apparent. To the North there is a definite tree line and to the West there are evident occupation lines. Also, a man named Nicholas Petts, whom lives on the adjacent property to the south, says that the concrete monument is the section corner and he knows it has been for at least forty years.

Ratified by Genesee County Peer Group November 23, 1994

C. Description of monument for corner and accessories established to perpetuate locating the position of the corner:

ACCESSORIES:
 1994/Remon - Found Concrete Monument, Wade-Trim, Inc. Remonumentation
 N05W 3.23' to Nail/Remon-tag W Face 8" Cherry
 East 43.84' to Nail/Remon-tag in S. Face twin 6" Ash
 West 38.29' to Nail/Remon-tag S. Face 12" Oak
 N70W 29.20' to Nail/Remon-tag S. Face twin 8" Oak

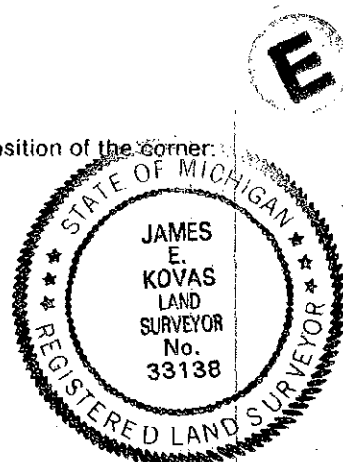

Signed by James E. Kovas Date 12/14/94
 Surveyor's Michigan License No. 33138

83
 07