

**SURVEY & REMONUMENTATION**

MAY 31 2000

Remonumentation corner under P.A. 345, Michigan P.A. of 1990

**SECTION**

**LAND CORNER RECORDATION CERTIFICATE**  
Filing Requirement of Act 74, Mich. P.A. 1970

DEED LIBER 2562 PAGE 558  
 REGISTERED OF DEEDS  
 JUN 12 8 47 AM '95  
 REGISTERED OF DEEDS  
 GENESSEE COUNTY  
 2081  
 REGISTERED  
 M. J. [Signature]

For corners in

Genessee (County) Located In: Corner Code #

Fenton Township

1. Public Land Survey T T5N R R6E M-9

2. Property Controlling in Section S \_\_\_ T \_\_\_ R \_\_\_

3. Miscellaneous Property in Sec. S \_\_\_ T \_\_\_ R \_\_\_

4. Lot No. \_\_\_ , Recorded Plat \_\_\_

5. Private Claims \_\_\_

Register of Deeds Stamp & File Number

9.00 Filed & Recd

A	B	C	D	E	F	G	H	I	J	K	L	M
2	6	5	4	3	2	1						
3												
4	7	8	9	10	11	12						
5												
6	18	17	16	15	14	13						
7												
8	19	20	21	22	23	24						
9												
10	30	29	28	27	26	25						
11												
12	31	32	33	34	35	36						
13												

I, James E. Kovas, PS, PE, in a field survey on September 27, 1994, do hereby certify that under requirements of P.A. 74, Michigan P.A. of 1970, the corner points mentioned in lines 1 and 2 above were in conformance with regulations and rules therefore as required in the current manual of survey instructions of the United States Department of the Interior, Bureau of Land Management or by a decree of a Court of Law and/or that the corner points mentioned in lines 3, 4 and 5 above were in conformance with the rules of the Michigan Board of Land Surveyors or by a Decree of a Court of Law; established, re-established, monumented, re-monumented, recovered, found as expressed below:

**NOTE: Not more than 4 corners, all in the same town and range, may be recorded on this certificate.**

A. Description of original monument and accessories and/or subsequent restoration:

- 1823/GLO - J. Fletcher, DS, set post, two accessories
- 1847/RODeeds - No monument description, County Surveyor Post. Witness Book, two accessories
- Date Unknown - Found Oak stake & nails, placed 2" gas pipe, Genessee G.C.R.C. County Witness Book, cor. No. 74, five accessories
- 1975/RODeeds - Found 2" pipe, recorded survey D.L. 1929, P. 778, Rowe Engineering, Odd H. Johnsrud, RLS #18434, three accessories
- 1976/RODeeds - Found 2" pipe, recorded survey D.L. 1945, P. 465, Rowe Engineering, Odd H. Johnsrud, RLS #18434, three accessories
- 1977/RODeeds - Found 2" Pipe, L.C.R.C. D.L., 1977, P. 784, Jan S. Fokens, RLS #21567
- 1978/Survey - Found 2" Pipe, unrecorded survey by CHMP, Job No. 18881, RLS #12024, three accessories

B. Description of corner evidence found and/or method applied in restoring or reestablishing corner:

**1994/REMON. SUMMARY OF EXISTING ACCESSORIES:**

			MEASURED
1994/Remon - Found badly deformed 2" pipe, Wade-Trim, Inc. Remonumentation			
1975/RODeeds N60W 61.53'	P.P. (RLS10057) (pole hit from East)	(measured to tag)	61.80'
1976/RODeeds N60W 61.53'	P.P. (RLS10057) (pole hit from East)	(measured to tag)	61.80'
1977/RODeeds N60W 61.53'	P.P. (RLS10057) (pole hit from East)	(measured to tag)	61.80'

Ratified by Genessee County Peer Group November 23, 1994

Ratified by Peer Group in accordance with P.A. 345, 1990

Co. Rep. Carl Carlson  
Date Nov-23, 1994

C. Description of monument for corner and accessories established to perpetuate locating the position of the corner:

**ACCESSORIES:**

- 1994/Remon - Found badly deformed 2" pipe, Wade-Trim, Inc. Remonumentation
- S70E 20.36' to Nail/tag in N Face P. Pole
- N60W 61.80' to Nail/tag in N Face P. Pole
- S60W 73.51' to Nail/tag NW Face twin 10" Elm
- East 24.73' to Nail/tag in S Face 30" Oak

I removed the badly deformed 2" pipe and placed the standard 30" x 2 3/8" Bernsten stainless steel tube with brass remonumentation cap.

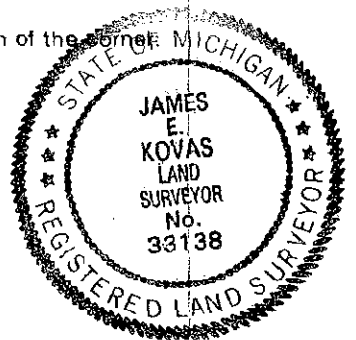

Signed by James E. Kovas Date 12/14/94  
Surveyor's Michigan License No. 33138

84