

SURVEY & REMONUMENTATION

1994 REMONUMENTATION PROGRAM

DEED LIBER 2565 PAGE 877

APR 27 1995

LAND CORNER RECORDATION CERTIFICATE
Filing Requirement of Act 74, Mich. P.A. 1970

For corners in **COMMISSION**

| | | |
|---------------------------------------|-------------------------|----------------------|
| <u>GENESEE</u> (County) | Located In: | Corner Code <i>≠</i> |
| | GAINES | M-3 |
| 1. Public Land Survey | T <u>6N</u> R <u>5E</u> | _____ |
| | T _____ R _____ | _____ |
| | T _____ R _____ | _____ |
| | T _____ R _____ | _____ |
| 2. Property Controlling In Section | S _____ T _____ R _____ | _____ |
| | S _____ T _____ R _____ | _____ |
| 3. Miscellaneous Property in Sec. | S _____ T _____ R _____ | _____ |
| | S _____ T _____ R _____ | _____ |
| 4. Lot No. _____, Recorded Plat _____ | | |
| 5. Private Claims _____ | | |

RECORDED
FEB 16 7 37 AM '95
778
Register of Deeds Stamp & File Number

| | | | | | | | | | | | | |
|----|----|----|----|----|----|----|----|----|----|----|----|----|
| | A | B | C | D | E | F | G | H | I | J | K | L |
| 2 | 1 | 2 | 3 | 4 | 5 | 6 | 7 | 8 | 9 | 10 | 11 | 12 |
| 3 | | | | | | | | | | | | |
| 4 | | | | | | | | | | | | |
| 5 | | | | | | | | | | | | |
| 6 | 16 | 17 | 18 | 19 | 20 | 21 | 22 | 23 | 24 | 25 | 26 | 27 |
| 7 | | | | | | | | | | | | |
| 8 | 19 | 20 | 21 | 22 | 23 | 24 | 25 | 26 | 27 | 28 | 29 | 30 |
| 9 | | | | | | | | | | | | |
| 10 | 30 | 31 | 32 | 33 | 34 | 35 | 36 | 37 | 38 | 39 | 40 | 41 |
| 11 | | | | | | | | | | | | |
| 12 | 31 | 32 | 33 | 34 | 35 | 36 | 37 | 38 | 39 | 40 | 41 | 42 |
| 13 | | | | | | | | | | | | |

I, DAVID J. KENNEY, PS, in a field survey on NOVEMBER 11, 1994, do hereby certify that under requirements of P.A. 74, Michigan P.A. of 1970, the corner points mentioned in lines 1 and 2 above were in conformance with regulations and rules therefore as required in the current manual of survey instructions of the United States Department of the Interior, Bureau of Land Management or by a decree of a Court of Law and/or that the corner points mentioned in lines 3, 4 and 5 above were in conformance with the rules of the Michigan Board of Land Surveyors or by a Decree of a Court of Law; established, re-established, monumented, re-monumented, recovered, found as expressed below:

NOTE: Not more than 4 corners, all in the same town and range, may be recorded on this certificate.

- A. Description of original monument and accessories and/or subsequent restoration:
- 1823 GLO; JOHN MULLETT, D.S. - SET POST - NO ACCESSORIES
 - 1919 GCRC - FOUND STONE - 3 ACCESSORIES
 - 1965 GCRC - FOUND STONE, SET IRON - 6 ACCESSORIES
 - 1965 A.C.E. - SET IRON - 6 ACCESSORIES

B. Description of corner evidence found and/or method applied in restoring or reestablishing corner:

1994 GENESEE COUNTY REMONUMENTATION PROGRAM
FOUND P.K. NAIL
5 ACCESSORIES, 1965 GCRC
2 ACCESSORIES, 1965 A.C.E.

Ratified by Peer Group in accordance with P.A. 345, 1990
Co. Rep. Carl D. Carl
Date 12-28-94

RATIFIED BY GENESEE COUNTY PEER GROUP DECEMBER 28, 1994

C. Description of monument for corner and accessories established to perpetuate locating the position of the corner:

SET STANDARD GENESEE COUNTY MONUMENT IN MONUMENT BOX

| | | |
|-------|--------|--|
| N40°E | 71.95' | FOUND NAIL & TAG, W. FACE OF POWER POLE |
| N60°W | 100.2' | FOUND NAIL & TAG, IN SE FACE OF POWER POLE |
| SOUTH | 66.25' | TO NW CORNER, SECTION 7, T6N, R6E |
| N45°W | 45.00' | N. END, BACK OF CURB, W. SIDE OF ELMS ROAD |

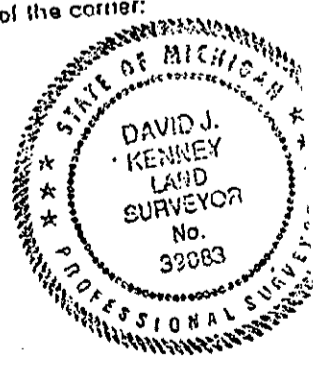

Signed by David J. Kenney
Surveyor's Michigan License No. 39083

Date DECEMBER 31, 1994
FORM APPROVED BY MICHIGAN STATE BOARD OF LAND SURVEYORS, JAN. REVISED MAY