

1994 REMONUMENTATION PROGRAM

APR 27 1995

LAND CORNER RECORDATION CERTIFICATE
Filing Requirement of Act 74, Mich. P.A. 1970

For corners COMMISSION

GENESEE (County)	Located In: MUNDY	Corner Code #1
1. Public Land Survey	T 6N R 6E	F-3
	T _____ R _____	_____
	T _____ R _____	_____
	T _____ R _____	_____
2. Property Controlling In Section	S _____ T _____ R _____	_____
	S _____ T _____ R _____	_____
3. Miscellaneous Property In Sec.	S _____ T _____ R _____	_____
	S _____ T _____ R _____	_____

RECORDED
FEB 16 7 37 AM '95
7793
Register of Deeds Stamp & File Number

4. Lot No. _____, Recorded Plat _____
 5. Private Claims _____

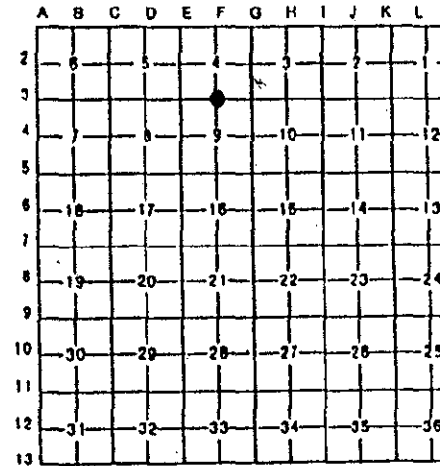

I, DAVID J. KENNEY, P.S. in a field survey on, OCTOBER 24, 19 94, do hereby certify that under requirements of P.A. 74, Michigan P.A. of 1970, the corner points mentioned in lines 1 and 2 above were in conformance with regulations and rules therefore as required in the current manual of survey instructions of the United States Department of the Interior, Bureau of Land Management or by a decree of a Court of Law and/or that the corner points mentioned in lines 3, 4 and 5 above were in conformance with the rules of the Michigan Board of Land Surveyors or by a Decree of a Court of Law; established, re-established, monumented, re-monumented, recovered, found as expressed below:

NOTE: Not more than 4 corners, all in the same town and range, may be recorded on this certificate.

A. Description of original monument and accessories and/or subsequent restoration:

- 1823 GLO; HARVEY PARKE - SET POST - NO ACCESSORIES
- 1890 MOSES MIDDLETON, CO. SURV. - SET STAKE AND STONE - 3 ACCESSORIES
- 1935 GCRC - FOUND STONE - 3 ACCESSORIES AND MEASURED BETWEEN CORNERS
- 1965 GCRC - NO DESCRIPTION - 3 ACCESSORIES
- 1971 RICHARD FRANKS - PLAT "COVENTRY FARMS RECORDED IN LIBER 50, PAGES 49 & 50, MEASURED BETWEEN CORNERS.
- 1990 RICHARD H. KRAFT, R.L.S. - FOUND 1/2" ROD MONUMENT BOX - 4 ACCESSORIES

B. Description of corner evidence found and/or method applied in restoring or reestablishing corner:

- 1994 GENESEE COUNTY REMONUMENTATION PROGRAM
- SET RE-ROD W/KRAFT CAP IN MONUMENT BOX AFTER ROAD CONSTRUCTION
- 1 ACCESSORY FROM GCRC 1935
- 2 ACCESSORIES FROM KRAFT 1990

Ratified by Peer Group in accordance with P.A. 345, 1990

RATIFIED BY GENESEE COUNTY PEER GROUP DECEMBER 21, 1994

Carl D. Carlson
Date 12-21-94

C. Description of monument for corner and accessories established to perpetuate locating the position of the corner:

SET STANDARD GENESEE COUNTY MONUMENT IN MONUMENT BOX

- ACCESSORIES:
- NORTH 60.01' TOP NW FACE, R/W MARKER
 - N20°W 37.76' FOUND NAIL AND TAG IN POWER POLE
 - N45°W 55.57' FOUND NAIL AND TAG IN 8" TREE
 - SOUTH 60.17' TOP NE FACE, R/W MARKER

MEASURED S 1/4 CORNER TO SW CORNER 2,644.83'
 MEASURED S 1/4 CORNER TO SE CORNER 2,637.32'

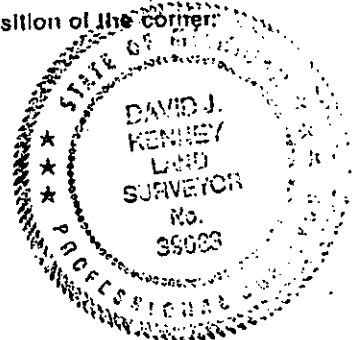

Signed by David J. Kenney Date DECEMBER 31, 1994
 Surveyor's Michigan License No. 39083