

SURVEY & REMONUMENTATION

MASTER LIBER 4355 PAGE 120

MAR 28 2000

**1999 GENESEE COUNTY REMONUMENTATION PROGRAM
LAND CORNER RECORDATION CERTIFICATE
Filing Requirement of Act 74, Mich. P.A. 1970**

SECTION

For corners in

Genesee (County)	Located In: Grand Blanc	Corner Code #
1. Public Land Survey	T6N R7E	C-13
	T R	
	T R	
	T R	
2. Property Controlling in Section	S T R	
	S T R	
3. Miscellaneous Property in Sec.	S T R	
	S T R	

Dec 21 3 10 PM '99
109088
Register of Deeds Stamp & File Number
Filed & Rec 9.00

4. Lot No. _____, Recorded Plat _____
5. Private Claims _____

I, Kevin B. Cleaver, in a field survey on December 9, 1999, do hereby state that under requirements of P.A. 74, Michigan P.A. of 1970, the corner points mentioned in lines 1 and 2 above were in conformance with regulations and rules therefore as required in the current manual of survey instructions of the United States Department of the Interior, Bureau of Land Management or by a decree of a Court of Law and /or that the corner points mentioned in lines 3, 4 and 5 above were in conformance with the rules of the Michigan Board of Land Surveyors or by a Decree of a Court of Law; established, re-established, monumented, recovered, found as expressed below:

	A	B	C	D	E	F	G	H	I	J	K	L	M
1													
2	6			5		4		3		2			1
3													
4	7			8		9		10		11			12
5													
6	18			17		16		15		14			13
7													
8	19			20		21		22		23			24
9													
10	30			29		28		27		26			25
11													
12	31			32		33		34		35			36
13													

NOTE: Not more than 2 corners, all in the same town and range, may be recorded on this certificate.

- A. Description of original monument and accessories and/or subsequent restoration:**
- 1815 General Land Office (GLO) field notes: set post w/two accessories
 - 1823 GLO measurement to closing corner
 - 8/14/72 P.A. 132 Certified Survey, Liber 1843, Pages 485 and 486: 'T'-iron w/three accessories, half-mile measurement, and measurement to section corner
 - Undated Rowe Incorporated field notes: measurement to section corner and mile measurement
 - Undated Cornerstone Surveying and Engineering witness ties: bent 'T'-iron, reset iron w/cap #32332 w/three accessories
 - 8/29/72 Land Corner Recordation Certificate, Liber 1838, Page 153: stone w/chiseled cross
 - 8/29/72 P.A. 132 Certified Survey, Liber 1840, Pages 638-639: stone w/chiseled cross, three accessories, and half-mile measurements
 - 1/21/99 Rowe Inc. field notes: iron w/ cap #32332
 - 3/3/99 Rowe Inc. field notes: closing corner and half-mile measurements

- B. Description of corner evidence found and/or method applied in restoring or reestablishing corner:**
- GLO coner and accessory not found
 - 1823 closing corner not found
 - Recovered corner, one accessory, and confirmed half-mile measurement from 1972 certified survey
 - Did not measure undated section corner and mile measurements
 - Recovered corner and three accessories from undated Cornerstone witness ties
 - Recovered corner and two accessories from 1972 LCRC
 - Recovered corner, two accessories, and measured half-mile distances from 1972 LCRC
 - Recovered corner from 1999 field notes
 - Confirmed half-mile measurement from 3/3/99 field notes
 - This monument found was ratified by the Genesee County Remonumentation Peer Review Committee on December 1, 1999.

- C. Description of monument for corner and accessories established to perpetuate locating the position of the corner:**
- Set the standard Bernsten monument SS-A-5BR-30 with 3 1/4" brass cap stamped "Genesee County Remonumentation Corner, 1999, #29242" over rod w/cap #32332 and bent 'T'-iron.

Ratified by Peer Group in accordance with P.A. 345, 1990

Co. Rep. Carl Carlson

Date 12-1-99

- N 68° W 39.53' set Genesee County witness tag in north face 9" ash
- N 47° W 34.87' nail in east face of 9" ash
- N 15° E 35.78' set Genesee County witness tag in southeast face 22" ash
- S 83° E 9.052' set Genesee County witness tag in south face 27" ash

Signed by Kevin B. Cleaver
Surveyor's Michigan License No. _____

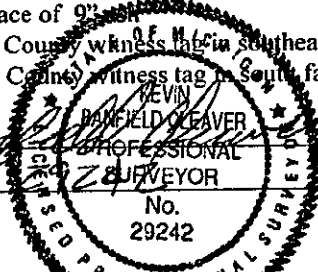

Date 12/20/99