

MAR 05 1998

MASTER LIBER 3685 PAGE 944

RECORDED
REGISTERED
Dec 29 11 33 AM '97

SECTION

1997 REMONUMENTATION PROGRAM
LAND CORNER RECORDATION CERTIFICATE
Filing Requirement of Act 74, Mich. P.A. 1970

For corners in

<u>Genesee</u> (County)	Located In:	Corner Code #
1. Public Land Survey	T. 6N R. 7E	J-5
	T. R.	
	T. R.	
2. Property Controlling in Section	S. T. R.	
	S. T. R.	
3. Miscellaneous Property in Sec.	S. T. R.	
	S. T. R.	
4. Lot No. _____, Recorded Plat _____		
5. Private Claims _____		

GENESEE COUNTY
REGISTERED

Good filed & rec
Register of Deeds Stamp & File Number

	A	B	C	D	E	F	G	H	I	J	K	L	M
1													
2	6		5		4		3		2		1		
3													
4	7		8		9		10		11		12		
5													
6	18		17		16		15		14		13		
7													
8	19		20		21		22		23		24		
9													
10	30		29		28		27		26		25		
11													
12	31		32		33		34		35		36		
13													

I, Kevin B. Cleaver, in a field survey on December 15, 1997 do hereby state that under requirements of P.A. 74, Michigan P.A. of 1970, the corner points mentioned in lines 1 and 2 above were in conformance with regulations and rules therefore as required in the current manual of survey in sections of the United States Department of the Interior, Bureau of Land Management or by a decree of Court of Law and/or that the corner points mentioned in lines 3, 4 and 5 above were in conformance with the rules of the Michigan Board of Land Surveyors or by a Decree of a Court of Law; established, re-established, monumented, recovered, found as expressed below.

NOTE: Not more than 2 corners, all in the same town and range, may be recorded on this certificate.

SURVEY & REMONUMENTATION

MAR 05 1998

SECTION

A. Description of original monument and accessories and/or subsequent restoration:

1823 GLO Set post and two (2) accessories
July 24, 1952 GCRD Recorded plat of "Minterbrook" L 23, P 59

B. Description of corner evidence found and/or method applied in restoring or reestablishing corner:

The Genesee County Peer Review Committee on December 18, 1997, determined that proportional measure was the only acceptable method to re-establish the correct location for this corner.

C. Description of monument for corner and accessories established to perpetuate locating the position of the corner:

Set the standard Bernsten monument SS-A-5-BR-30 with 3 1/4" brass cap stamped Genesee County Re-monumentation Corner 1997, #29242.

- 40° E, 92.25' - Set Re-mon nail and tag in the West face of a 30" oak
- S 45° W, 58.62' - Found pinch pipe
- S 65° E, 42.54' - Set Re-mon nail and tag in the South face of a 12" oak
- East, 88.38' - Found 'T' Iron
- N 20° W, 105.69' - Set Re-mon nail and tag in the West face of a 12" maple

Signed by Kevin Banfield Cleaver
Kevin Banfield Cleaver, P.S.,
Field Manager

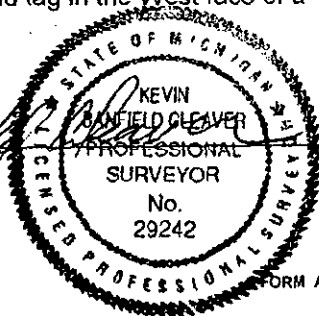

Date 12/24/97

Surveyor's Michigan License No. 29242

FORM APPROVED BY MICHIGAN STATE BOARD OF PROFESSIONAL SURVEYORS, JAN. 28, 1971
REVISED MAY 14, 1975
REVISED JAN., 1983 REVISED OCT., 1995

97H-GCRM-LCRC-3643

Ratified by Peer Group in
accordance with P.A. 345, 1990
Co. Rep. Carl Caskey
Date 12-18-97

88579