

SURVEY & REMONUMENTATION

MASTER LIBER **3685** PAGE **947**

MAR 05 1998

RECORDED
REGISTERED
DEC 29 11 33 AM '97

**SECTION 1997 REMONUMENTATION PROGRAM
LAND CORNER RECORDATION CERTIFICATE
Filing Requirement of Act 74, Mich. P.A. 1970**

GENESEE COUNTY
REGISTER OF DEEDS

For corners in

<u>Genesee</u> (County)	Located in:	Corner Code #
1. Public Land Survey	T <u>6N</u> R <u>7E</u>	<u>K-5</u>
	T _____ R _____	_____
	T _____ R _____	_____
2. Property Controlling in Section	S _____ T _____ R _____	_____
	S _____ T _____ R _____	_____
3. Miscellaneous Property in Sec.	S _____ T _____ R _____	_____
	S _____ T _____ R _____	_____
4. Lot No. _____, Recorded Plat _____		
5. Private Claims _____		

Go Field & Rec
Register of Deeds Stamp & File Number

A	B	C	D	E	F	G	H	I	J	K	L	M
1												
2	6		5		4		3		2		1	
3												
4	7		8		9		10		11		12	
5												
6	18		17		16		15		14		13	
7												
8	19		20		21		22		23		24	
9												
10	30		29		28		27		26		25	
11												
12	31		32		33		34		35		36	
13												

I, Kevin B. Cleaver, in a field survey on November 10, 1997 do hereby state that under requirements of P.A. 74, Michigan P.A. of 1970, the corner points mentioned in lines 1 and 2 above were in conformance with regulations and rules therefore as required in the current manual of survey instructions of the United States Department of the Interior, Bureau of Land Management or by a decree of a Court of Law and for that the corner points mentioned in lines 3, 4 and 5 above were in conformance with the rules of the Michigan Board of Land Surveyors or by a Decree of a Court of Law; established, re-established, monumented, recovered, found as expressed below:

Ratified by Peer Group in accordance with P.A. 345, 1990
Co. Rep. Carl Carlson
Date 11-13-97

NOTE: Not more than 2 corners, all in the same town and range, may be recorded on this certificate.

A. Description of original monument and accessories and/or subsequent restoration:

- 1823 GLO Set post and two (2) accessories
- No Date GEI Iron Rod, Brick, three (3) accessories
- July 24, 1952 GCRD Recorded Plat of "Minterbrook" L 23 P 59
- Nov. 28, 1979 GCRD Certified Survey, L 2074 P 171 - Found Gould Engineering Tag in Asphalt, four (4) accessories
- Jan. 15, 1980 GCRD LCRC, L 2074 P 168 - Found Gould Engineering Tag, four (4) accessories
- Feb. 12, 1980 Certified Survey, L 2074 P 170 - Found Gould Engineering Tag, five (5) accessories
- Dec. 14, 1989 GCRD LCRC, L 2380 P 872 - Found Nail/Tag in B/T, four (4) accessories
- March 9, 1990 GCRD Recorded Plat of "Riverbend East No. 5" L 64, P 45 and 46
- April 15, 1994 GCRD Certified Survey, L 2578 P 392 - Found Nail/Tag in Asphalt, four (4) accessories
- Jan. 21, 1997 GCRD Certified Survey, L 3447 P 702 - Found Nail/Tag in Asphalt, four (4) accessories

B. Description of corner evidence found and/or method applied in restoring or reestablishing corner:

Found nail and tag in asphalt

Found plat monumentation in the recorded plat of "Minterbrook L 23 P 59 July 24, 1952; Found three (3) accessories, and distances established NE corner of survey to K-5 and established SW corner of survey to K-5 from November 28, 1979 survey L 2074 P 171; Found three (3) accessories from January 15, 1980 LCRC L 2074 P 168; Found three (3) accessories from February 12, 1980 survey L 2074 P 170; Found three (3) accessories from December 14, 1989 LCRC L 2380 P 872; Found plat monumentation and distance K-5 to K-6 in the recorded plat of "Riverbend East No. 5" L 64 P 45 - 46; Found four (4) accessories, distances K-4 to K-5 and K-5 to the centerline of Belsay Road, and angle K-4, K-5, L-5 from April 15, 1994 survey L 2578 P 392; Found four (4) accessories from January 21, 1997 survey L 3447 P 702.

The monument found was ratified by the Genesee County Peer Review Committee on November 13, 1997, as the accepted corner.

C. Description of monument for corner and accessories established to perpetuate locating the position of the corner:

Set the standard Bernsten monument SS-A-5-BR-30 with 3 1/4" brass cap stamped Genesee County Re-monumentation Corner 1997, #29242 in Monument Box.

- North, 50.06' - Found pipe
- S 45° E, 71.26' - Found 'X' in the North rim of MBT manhole
- S 25° W, 75.14' - Found nail and tag in a light pole
- N 30° W, 66.44' - Found nail and tag in the East face of a 10" tree

Surveyed by Kevin Banfield Cleaver
Kevin Banfield Cleaver, P.S.
Field Manager

Date 12/24/97

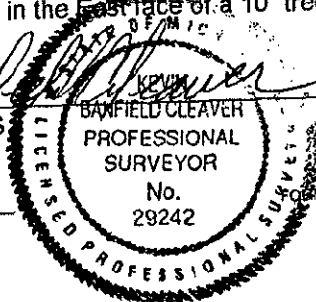

Surveyor's Michigan License No. 29242