

MAY 31 2000

DEED LIBER 2564 PAGE 531

LAND CORNER RECORDATION CERTIFICATE

Filing Requirement of Act 74, Mich. P.A. 1970

SECTION

For corners in Genesee (County)	Located In:	Corner Code #
1. Public Land Survey	T 7N R 5E	A-3
	T R	
	T R	
	T R	
2. Property Controlling in Section	S T R	
	S T R	
3. Miscellaneous Property in Sec.	S T R	
	S T R	

RECORDED  
REGISTER OF DEEDS  
FEB 1 10 16 AM '95  
GENESEE COUNTY  
REGISTER OF DEEDS  
5479  
Register of Deeds Stamp & File Number

4. Lot No. \_\_\_\_\_ Recorded Plat \_\_\_\_\_  
 5. Private Claims \_\_\_\_\_

I, Jack N. Owens, Prof. Surveyor, in a field survey on DEC 27, 19 94, do hereby certify that under requirements of P.A. 74, Michigan P.A. of 1970, the corner points mentioned in lines 1 and 2 above were in conformance with regulations and rules therefore as required in the current manual of survey instructions of the United States Department of the Interior, Bureau of Land Management or by a decree of a Court of Law and/or that the corner points mentioned in lines 3, 4 and 5 above were in conformance with the rules of the Michigan Board of Land Surveyors or by a Decree of a Court of Law; established, re-established, monumented, re-monumented, recovered, found as expressed below:

	A	B	C	D	E	F	G	H	I	J	K	L	M
1													
2	6	5	4	3	2	1							
3													
4	7	8	9	10	11	12							
5													
6	18	17	16	15	14	13							
7													
8	19	20	21	22	23	24							
9													
10	30	29	28	27	26	25							
11													
12	31	32	33	34	35	36							
13													

NOTE: Not more than 4 corners, all in the same town and range, may be recorded on this certificate.

A. Description of original monument and accessories and/or subsequent restoration:

1821, GLO - J. WAMPLER, DS; SET POST & 2 ACCESSORIES  
 1878, GCRC - S.N.BEDEN, DEP. CO. SUR.; STONE AND BRICK AND 1 NEW ACCESSORY  
 1919, GCRC AND WIT. BOOK - BEECHER ROAD PLANS; FND STONE AND CROCKERY AND 3 NEW ACCESSORIES  
 1931, MDOT R/W BOOK - LARGE POINTED ROCK, 1' RIGHT/SUR. C/L AND 2 ACCESSORIES FROM 1919 AND 3 NEW ACCESSORIES  
 1940?, GCRC WIT. BOOK - CROCKERY, MON. BOX AND 2 ACCESSORIES FROM 1919 AND 3 ACCESSORIES FROM 1931  
 1968, REI SURV. RECS - SHOWS COR., NOT DESCRIBED, SET 1.0' E OF C/L AND NO ACCESSORIES  
 1970, GCRC - NO MONUMENTATION, 5 NEW ACCESSORIES LISTED  
 1976-78, CERT. SURV. L. 1942 P. 55 & 313 AND L. 2022, P. 617, AND LCRC, L. 1977 P. 792, J.S. FOKENS, PS 21567;  
 FND PK SHAFT, RESET AND 3 ACCESSORIES FROM 1970  
 1984, CERT. SURV. L. 2211 P. 172, M.L. VANRAEMDONCK, PS24622; FND PK NAIL AND 3 ACCESSORIES FROM 1970  
 1986, LCRC - L. 2305 P. 497, J.A. WIZYNAJTY PS21585; FND NAIL AND 2 ACCESSORIES FROM 1970 AND 1 NEW ACCESSORY

B. Description of corner evidence found and/or method applied in restoring or reestablishing corner:

1994 - SET TEMP. PK NAIL 1.0'E OF ORIGINAL C/L AND FND 1 ACCESSORY FROM 1931 (WILKINSON ROAD TO THE SOUTH AT 653.8') AND 1 ACCESSORY FROM 1940 (SURVEY AND PAVEMENT C/L TO THE WEST AT 1.0') AND 2 ACCESSORIES FROM 1970, 1976-78 (TAG IN P. POLE TO NW AT 104.20 AND TO THE NE AT 104.24) AND 3 ACCESSORIES FROM 1986 (24" CMP TO SE AT 71.90' AND TO THE NE AT 73.30' AND 18" CONC. TILE TO THE WEST AT 52.58')  
 DIST. TO C-3 = 4674.63' (70.827 CH) & 4673.58' FROM 1970 C/L POSITION [CF=4674.31' IN 1972, 4674.56' FROM 1970 C/L POSITION, 4674.25' FROM STONE IN 1919, 4663.6' (70.66 CH) IN 1878 & 4587' (69.50 CH) IN 1821 GLO BUT CORRECTED TO 4653' (70.50 CH)]. I CONCLUDE THE COR. POSITION DOESN'T SEEM TO HAVE CHANGED SINCE STONE/BRICK SET IN 1878 & RECOVERED IN 1919/31 INDICATES LONG HISTORY OF CAREFULL PERPETUATION BY CO.SUR., GCRC, & MDOT. I RE-ESTABLISHED 1970 POSITION FROM 1970 GCRC/REI SURVEY FROM FND TAGS IN NE & NW EXTANT 1970 POLES & IT FELL ON 24' WD. C/L, NOT ORIG. 20" WD. C/L WHICH STILL EXISTS 2.0' W. (4 FT. WAS ADDED IN 1960'S). MDOT RECS. SHOW COR WAS 1.0' E. OF ORIG. C/L. ALSO FELL ON BEECHER RD. C/L & I CONCLUDE THESE C/L'S BEST EVIDENCE OF LOCATION. I RE-ESTABLISHED COR. AT CORRECT POSITION BY THE COLLATERAL EVIDENCE OF ORIG. C/L AT LOCATION 1.0' E. I NOTED THAT MILE IS ABOUT 1 CHAIN LONGER THAN GLO REC. DIST. & ERROR IS IN THE ORIG. GLO UNIT OF MEASURE & AN EVEN NUMBER OF FULL HALF-CHAINS. ALSO, DIVIDING EDM DIST. BY CORRECTED GLO DIST. GIVES 66.3 FT./CH. FOR THE "FEET/CHAIN" OF DEP.SUR'S. CHAIN, A LOGICAL VALUE, WHEREAS THE REC. GLO DIST. GIVES 67.3 FT./CH., ILLOGICAL FOR THE 66-FOOT CHAIN. I ACCEPT THE POSITION AS THE LONG-KNOWN POSITION AND AS A FAITHFUL AND CAREFUL RE-ESTABLISHMENT OF THE POSITION OF THE ORIGINAL CORNER.  
 RATIFIED BY GEN. CO. PEER GROUP OCT. 18, 1994.

C. Description of monument for corner and accessories established to perpetuate locating the position of the corner:

Accessories:  
 SOUTH 658.1' (9.971 CH) - WILKINSON ROAD C/L W'LY  
 WEST, 1.0' - ORIG. MDOT SURVEY AND PAVEMENT C/L  
 N38W, 103.58' - FND OLD NAIL/DISC IN  
 ENE FACE OF P/POLE  
 N36E, 104.82' - FND OLD NAIL/DISC IN  
 S FACE OF P/POLE  
 S42E, 72.45' - S END TOP CNTR OF 24" CMP  
 N43E, 72.87' - N END TOP CNTR OF 24" CMP  
 S89W, 51.65' - S END TOP CNTR OF 18" RCP  
 CUT HOLE IN PAVEMENT & INSTALLED  
 MON. BOX LIFT RING & I SET  
 STANDARD BERNTSEN MONUMENT CAP  
 SS-A-5-BR-30 (3 1/4" D. BRASS  
 CAP STAMPED "GENESEE COUNTY  
 REMONUMENTATION CORNER, A-3,  
 20709, 1994" ON 18" LONG  
 X 5/8" REROD.

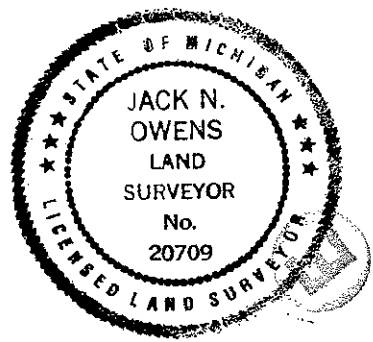

Signed by Jack N. Owens Date Dec 31, 1994

Surveyor's Michigan License No. 20709 Ratified by Peer Group in accordance with P.A. 345, 1990

Co. Rep. Carl Carlson  
 Date 10-18-94 68