

MAY 31 2000

SECTION

DEED LIBER 2564 PAGE 538 LAND CORNER RECORDATION CERTIFICATE Filing Requirement of Act 74, Mich. P.A. 1970

For corners in Genesee (County) Located In: Corner Code # 1. Public Land Survey T 7N R 5E K-3 2. Property Controlling in Section S S T R 3. Miscellaneous Property in Sec. S T R 4. Lot No. Recorded Plat 5. Private Claims

RECORDED REGISTER OF DEEDS FEB 1 10 16 AM '95 5486 Register of Deeds Stamp & File Number

I, Jack N. Owens, Prof. Surveyor, in a field survey on OCT. 26, 19 94, do hereby certify that under requirements of P.A. 74, Michigan P.A. of 1970, the corner points mentioned in lines 1 and 2 above were in conformance with regulations and rules therefore as required in the current manual of survey instructions of the United States Department of the Interior, Bureau of Land Management or by a decree of a Court of Law and/or that the corner points mentioned in lines 3, 4 and 5 above were in conformance with the rules of the Michigan Board of Land Surveyors or by a Decree of a Court of Law; established, re-established, monumented, re-monumented, recovered, found as expressed below:

NOTE: Not more than 4 corners, all in the same town and range, may be recorded on this certificate.

A. Description of original monument and accessories and/or subsequent restoration:

- 1821, GLO - H. BALL, DS; SET POST AND 2 ACCESSORIES. 1920, GCRC - BEECHER RD PLANS; FND LARGE CORNER STONE AND 3 NEW ACCESSORIES. 1940, GCRC & WIT BOOK (COR #4) & BEECHER RD PLANS; LARGE STONE AND 5 NEW ACCESSORIES. 1968, PLAT - "TIMBERLEA ESTATES," (L. 47, P. 8) C. H. CARLSON, PS 9189; FND STONE IN MON. BOX, NO ACCESSORIES. 1970, GCRC - BEECHER RD PLANS; SET MON. BOX OVER CORNER (NOT DESCRIBED) AND 4 NEW ACCESSORIES. 1973, LCRC - (L. 1875, P. 558), R. L. MITCHELL, PS 6936, FND MON. BOX & 4 NEW ACCESSORIES. 1974, CERT. SURV. (L. 1896, P. 28), C. H. CARLSON, PS 9189, FND MON. BOX & 4 1973 ACCESSORIES. 1979, LCRC - (L. 2033, P. 329), B. GRIGGS JR. PS 14763, FND MON. BOX & 4 1973 ACCESSORIES. 1986, CERT. SURV. (L. 2264, P. 564 & L. 2268, P. 402), A. V. KUPISCH, PS 13586; FND MON. BOX & 1 ACCESSORY FROM 1973 - 1979 AND 3 NEW ACCESSORIES. 1991, REI UNREC. SUR., P. N. BROWN, PS 33134; FND STONE IN MON. BOX & 3 1986 ACCESSORIES AND 1 NEW ACCESSORY.

B. Description of corner evidence found and/or method applied in restoring or reestablishing corner:

1994, FND LRG. STONE IN MON. BOX & 2 1979 ACCESSORIES (18" MAPLE TO NE AT 61.46' & POWER POLE TO SW AT 59.88') AND 1 1986 ACCESSORY (N & TAG IN P/POLE TO SE AT 69.36') AND 2 1991 ACCESSORIES (BROWN TAG IN 10" SPRUCE TO SE AT 50.01' AND TAG #11192 IN P/POLE TO SW AT 60.68').

SEE J-3 & L-3 LCRC'S FOR DISTANCES TO THOSE CORS. 1970 ANGLE TO N = 181°40'00" [CF=181°39'-1/2' IN 1920].

NEARLY IDENTICAL TO 1920. YO 1970 MSRMTS. THIS PATTERN OF PERPETUATION BY CO. SUR. & GCRC DATES BACK 100 TO 130 YEARS. I ACCEPT THE STONE UNDER THE MON BOX AS A FAITHFUL AND CAREFUL PERPETUATION OF THE POSITION OF THE ORIGINAL CORNER.

I CONCLUDE THE CORNER POSITION DOESN'T SEEM TO HAVE CHANGED PROBABLY SINCE THE GLO SURVEY SINCE THE STONE (PROBABLY SET IN THE 1870'S OR 1880'S) RECOVERED IN THE 1920 & 1940 SURVEYS, AS WELL AS THIS RETRACEMENT SURVEY, INDICATES A LONG HISTORY OF CAREFUL PERPETUATION BY THE CO. SUR. & GCRC. THE CO. SUR. RECORDS CIRCA 1860-1890'S SHOW PATTERN OF STONES AT CORNERS IN THIS AREA. DISTANCES ARE

RATIFIED BY GEN. CO. PEER GROUP OCT. 18, 1994.

C. Description of monument for corner and accessories established to perpetuate locating the position of the corner:

- Accessories: N35E, 61.47' - FND NAIL/G.E. TAG IN NW FACE 20" MAPLE & 61.44 - SET SPIKE/REMON TAG IN NW FACE S35W, 59.74' - FND NAIL/G.E. TAG IN SE FACE OLD P POLE S45E, 69.31' - FND NAIL/G.E. TAG IN NE FACE 1982 P/POLE S48E, 50.08' - FND S.R. BROWN TAG IN NE FACE 10" SPRUCE S35W, 60.66' - FND NAIL/TAG #11192 IN SE FACE 1989 P POLE N15W, 113.74' - SET PK/REMON TAG IN E FACE OF 1988 P POLE

I SET THE STANDARD BERNTSEN MONUMENT SS-A-5-BR-30 (3 1/4" D. BRASS CAP STAMPED "GENESEE COUNTY REMONUMENTATION CORNER 20709, 1994" WITH 11" X 2 3/8" O.D. STAINLESS STEEL TUBE) WITH GROUT ON TOP OF STONE IN MON BOX.

Ratified by Peer Group accordance with P.A. 345, 1994

Co. Rep. [Signature] Date 10-18-94

Signed by [Signature] Date Dec 30, 1994 Surveyor's Michigan License No. 20709

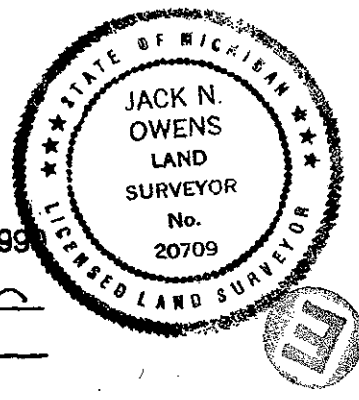

75