

SURVEY & REMONUMENTATION

MAY 31 2000

DEED LIBER 2564 PAGE 544

LAND CORNER RECORDATION CERTIFICATE

Filing Requirement of Act 74, Mich. P.A. 1970

SECTION

For corners in Genesee (County)	Located In:	Corner Code #
1. Public Land Survey	T 7N R 8E	K-3
	T R	
	T R	
	T R	
2. Property Controlling in Section	S T R	
	S T R	
3. Miscellaneous Property in Sec.	S T R	
	S T R	

RECORDED
REGISTER OF DEEDS
FEB 1 10 17 AM '95
GENESEE COUNTY
REGISTER OF DEEDS
5490
Register of Deeds Stamp & File Number

4. Lot No. _____, Recorded Plat _____
5. Private Claims _____

I, Jack N. Owens, in a field survey on DEC. 20 19 94, do hereby certify that under requirements of P.A. 74, Michigan P.A. of 1970, the corner points mentioned in lines 1 and 2 above were in conformance with regulations and rules therefore as required in the current manual of survey instructions of the United States Department of the Interior, Bureau of Land Management or by a decree of a Court of Law and/or that the corner points mentioned in lines 3, 4 and 5 above were in conformance with the rules of the Michigan Board of Land Surveyors or by a Decree of a Court of Law; established, re-established, monumented, re-monumented, recovered, found as expressed below:

	A	B	C	D	E	F	G	H	I	J	K	L	M
1													
2	6	5	4	3	2	1							
3													
4	7	8	9	10	11	12							
5													
6	18	17	16	15	14	13							
7													
8	19	20	21	22	23	24							
9													
10	30	29	28	27	26	25							
11													
12	31	32	33	34	35	36							
13													

NOTE: Not more than 4 corners, all in the same town and range, may be recorded on this certificate.

A. Description of original monument and accessories and/or subsequent restoration:

- 1821, GLO - J. WAMPLER, DS.; SET POST & 2 ACCESSORIES
- 1864/74, GCSR - S. MATHEWSON & S.R. BILLINGS CO. SURV.; POST AND BRICK, NO ACCESSORIES (PG 542 & 552)
- 1916, GCRC - DAVISON RD PLANS; PIPE W/STONE/STAKE & 3 ACCESSORIES (COR. 52)
- 1928-40?, MDOT - DAVISON RD PLANS; NO MONUMENTATION & 3 NEW WITNESSES
- 1972, CERT. SURV. (L. 1838, P. 475) C., H. CARLSON, PS 9189; FND MON BOX & 3 NEW WITNESSES
- 1974, CPCO - (L. 1889, P. 573-574) & (L. 1880, P. 886-888); FND MON BOX & NO ACCESSORIES
- 1979, LCRC (L. 2075, P. 991) & REI SURV. RECS. & CERT. SURV. (L. 2213, P. 911-912), J.S. FOKENS PS21567; FND 1" IRON PIN IN MON. BOX & 3 NEW ACCESSORIES
- 1986, GCRC - HENDERSON ROAD PLANS; FND PLATE (TOP OF MON BOX) & 3 NEW ACCESSORIES
- 1989, CERT. SURV. (L. 2353, P. 359) A.F. MILLER, PS12024; CENTER OF MON. BOX & 2 ACCESSORIES FROM 1979 & 2 NEW ACCESSORIES

B. Description of corner evidence found and/or method applied in restoring or reestablishing corner:

1994, - FND 3/4" PIPE IN MON. BOX & 2 ACCESSORIES FROM 1979 (P/POLES TO SE & NE @ 27.67' & 62.90') & 3 ACCESSORIES FROM 1986 (N & T IN P/POLE TO NE @ 63.00' & N & T IN 12" BASSWOOD TO SW @ 45.63' & N & T IN P/POLE TO SE @ 27.75')

ANGLE TO SOUTH = 180°46'50", CALC. FROM 1928/1940 MDOT PLANS (CF=180°39' IN 1916)

I CONCLUDE THE CORNER POSITION DOESN'T SEEM TO HAVE CHANGED SINCE 1864 & THE STONE RECOVERED IN 1916 INDICATES LONG HISTORY OF PERPETUATION BY CO. SUR., GCRC & MDOT RECORDS OVER 130 YRS. THE DISTANCES [ON J-3 & L-3 LCRC] ARE CLOSE OR NEARLY THE SAME FROM 1864 & 1984 ALLOWING FOR CHANGES IN SURVEY PROCEDURES & CHANGES IN TECHNOLOGY. THE GCRC USED IRON PINS SINCE 1971 & THIS SEEMS TO HAVE SURVIVED UNTIL 1984. I ACCEPT THE 3/4" PIPE IN THE MON BOX AS A FAITHFUL & CAREFUL PERPETUATION OF THE POSITION OF THE ORIGINAL CORNER.

RATIFIED BY GEN. CO. PEER GROUP DEC. 7, 1994.

C. Description of monument for corner and accessories established to perpetuate locating the position of the corner:

- Accessories:
- S05E, 27.63' - FND TAG 11192 IN P/POLE-NE FC
 - N45E, 62.84' - FND TAG 11192 IN P/POLE-SW FC
 - N45E, 63.07' - FND NAIL & RED PLASTIC TAG IN P/POLE - W FC
 - S45W, 45.48' - FND NAIL & TAG IN 12" BASSWOOD- N FC
 - S05E, 27.75' - FND NAIL & RED PLASTIC TAG IN N FACE OF P/POLE
 - S30W, 45.60' - FND PK & FLAG IN E FACE OF 12" BASSWOOD
 - N45E, 63.57' - SET SPK & GC RE MON TAG NW FACE OF P/POLE
 - S05E, 27.62' - SET SPK & GC RE MON TG W FACE OF P/POLE
 - S50W, 70.91' - SET SPK & GC RE MON TAG NW FACE OF 24" RED OAK
 - S55E, 63.23' - SET SPK & GC RE MON TAG NE FACE OF 24" BASSWOOD

I SET THE STANDARD BERNSTEN MONUMENT SS-A-5-BR-30 (3 1/4" D. BRASS CAP STAMPED "GENESEE COUNTY REMONUMENTATION CORNER, 20709, 1994" WITH 10" X 2 3/8" O.D. STAINLESS STEEL TUBE WITH GROUT) OVER THE 3/4" PIPE.

Ratified by Peer Group in accordance with P.A. 345, 1990

Co. Rep. Carl Carlson
Date 10-18-94

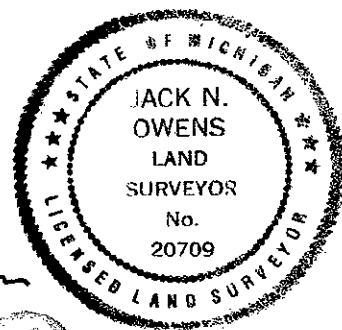

Signed by Jack N. Owens Date Dec 30, 1994
Surveyor's Michigan License No. 20709

86