

SURVEY & REMONUMENTATION

MAY 31 2000

DEED LIBER 2564 PAGE 556

LAND CORNER RECORDATION CERTIFICATE
Filing Requirement of Act 74, Mich. P.A. 1970

SECTION

For corners in Genesee (County) Located In: _____ Corner Code # _____

1. Public Land Survey	T	7N	R	8E	M-10
	T		R		
	T		R		
	T		R		
2. Property Controlling in Section	S		T	R	
	S		T	R	
3. Miscellaneous Property in Sec.	S		T	R	
	S		T	R	

4. Lot No. _____, Recorded Plat _____
5. Private Claims _____

RECORDED
REGISTER OF DEEDS
FEB 1 10 17 AM '95
GENESEE COUNTY REGISTER OF DEEDS
5501
Register of Deeds Stamp & File Number

I, Jack N. Owens, in a field survey on OCT. 31 19 94, do hereby certify that under requirements of P.A. 74, Michigan P.A. of 1970, the corner points mentioned in lines 1 and 2 above were in conformance with regulations and rules therefore as required in the current manual of survey instructions of the United States Department of the Interior, Bureau of Land Management or by a decree of a Court of Law and/or that the corner points mentioned in lines 3, 4 and 5 above were in conformance with the rules of the Michigan Board of Land Surveyors or by a Decree of a Court of Law, established, re-established, monumented, re-monumented, recovered, found as expressed below:

1	A	B	C	D	E	F	G	H	I	J	K	L	M
2	6	5	4	3	2	1							
3													
4	7	8	9	10	11	12							
5													
6	18	17	16	15	14	13							
7													
8	19	20	21	22	23	24							
9													
10	30	29	28	27	26	25							
11													
12	31	32	33	34	35	36							
13													

NOTE: Not more than 4 corners, all in the same town and range, may be recorded on this certificate.

A. Description of original monument and accessories and/or subsequent restoration:

1821, GLO - J. WAMPLER, DS; SET POST & 2 ACCESSORIES
1933, GCRC-BRISTOL / WASHBURN PLANS (ROAD #72) NOT FIND COR BUT SHOWS 1/4 LINE FNC TO WEST & MEASUREMENT TO COR M-9
1966, CFCO & GCRC-H. DORCEY, PS 9429, FIELD NTOES, SET T-IRON AT PROPORTIONATE DISTANCE FROM COR. M-9, 2624.68'S. WIT BK COR #141 ALSO LISTS 3 ACCESSORIES.
1973, LCRC (L. 1849., P. 334) R.L. MITCHELL, PS6936; FND BENT T-IRON, SET 1" X 24" ROD & 2 NEW ACCESSORIES
1974, SUR. RECORDS-G.R. STONEROCK, PS 13601, SHOWS MEASUREMENT FROM M-11 TO M-9 BUT NOT TIE IN THIS CORNER. STATES FND BENT T-IRON

B. Description of corner evidence found and/or method applied in restoring or reestablishing corner:

1994, FND 3/4" IRON BAR & 2 ACCESSORIES FROM 1973 (D/POLE TO THE NE @ 60.25' & OAK TO NW @ 38.6')
DIST. TO M-9=2628.21' (39.821 CHS) EDM (CF=2624.68' [39.768 CHS] IN 1966, 2626' [39.79 CHS] IN 1933. & 2640' [40.00 CHS] IN 1821 GLO).
DIST. TO M-11=2515.15' [38.108 CHS] IN 1974 (CF=2640' [40.00 CHS] IN 1821 GLO BUT CORRECTED TO 2508' [38.00 CHS]).
DIST. M-11 TO M-9 = 5143.36' (77.30 CHS) IN 1974 EDM (CF=5280' [80.00 CHS] IN 1821 GLO BUT CORRECTED TO 5148' [78.00 CHS]).

I CONCLUDE THE COR. POSITION PROBABLY HAS NOT CHANGED SINCE THE GLO SURVEY BUT THERE IS LITTLE HISTORY PRIOR TO 1966. THE GCRC DID NOT RECOVER ANY MONUMENTATION BUT NOTED THE FNC TO WEST WHICH IS NOW GONE BUT IS COLLATERAL EVIDENCE & PROBABLY RESULTED FROM CO. SUR. PERPETUATION. COPOCO RE-ESTABLISHED THE COR., APPARENTLY BY USING THE DIST. FROM M-8 TO M-9 (2627.93' EDM), ABOUT AVERAGE SEEN IN RETRACING WAMPLER'S 1/2 MILES (SEE NOTE ON M-5 LCRC). S 1/2 MILE CLEARLY SHOWS 2 CHAIN (MISMEASUREMENT WHICH IS IN UNIT OF ORIG. SURVEY) AS DOES THE MILE MEASUREMENT. ALSO 1/4 LINE FNC RUNNING WEST IN 1933 MATCHES RECENT RECORDS (1974 TO DATE) WITH REMNANTS & LARGE TREES STARTING ABOUT 700' W. I ACCEPT THE 3/4" BAR AS A FAITHFUL & CAREFUL RE-ESTABLISHMENT OF THE POSITION OF THE ORIGINAL CORNER. RATIFIED BY GEN. CO. PEER GROUP DEC. 7, 1994.

C. Description of monument for corner and accessories established to perpetuate locating the position of the corner:

Accessories:
N75E, 60.45' - FND PK W/FLAGGING IN SE FACE OF POWER POLE
N85W, 38.70' - FND NAIL W/RUSTY DISK IN NORTH FACE OF 36" OAK
S45W, 58.21' - FND NAIL W/FLAGGING IN NORTH FACE OF 15" OAK
S45W, 58.68' - FND PK W/FLAGGING IN NW FACE OF 15" OAK
S45E, 49.28' - FND PK W/FLAGGING IN SW FACE OF 15" ASH
N85W, 38.73' - SET REMON TAG W/NAIL IN NORTH FACE 36" OAK
N75E, 60.40' - SET REMON TAG W/PK IN SE FACE OF POWER POLE
S45W, 58.60' - SET REMON TAG W/NAIL IN NW FACE OF 15" OAK
S45E, 49.26' - SET REMON TAG W/NAIL IN SW FACE OF 15" ASH

I SET THE STANDARD BERNTSEN MONUMENT SS-A-BR-30 (3 1/4" D. BRASS CAP STAMPED "GENESEE COUNTY REMONUMENTATION CORNER, 20709, 1994" WITH 18" x 2 3/8" O.D. STAINLESS STEEL TUBE) OVER 3/4" IRON BAR AT 6" BELOW GRADE.

Ratified by Peer Group in accordance with P.A. 345, 1990

Co. Rep. Carl Carlson
Date 12-7-94

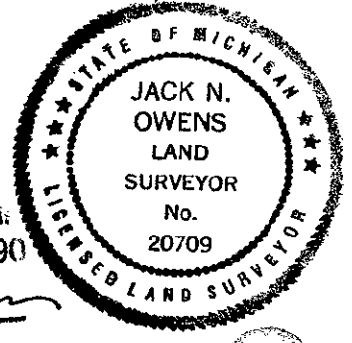

Signed by Jack N. Owens Date Dec 30, 1994
Surveyor's Michigan License No. 20709

97