

MAR 16 1994

COMMISSION

LAND CORNER RECORDATION CERTIFICATE

Filing Requirement of Act 74, Mich. P.A. 1970

Remonumentation corner under P.A. 345 Michigan P.A. of 1990

For corners in  
Genesee  
(County)

Located in: Flushing Corner Code #

DEED LIBER 2517 PAGE 494

1. Public Land Survey	T 8N	R 5E	D-3
	T	R	
	T	R	
	T	R	
2. Property Controlling in Section	S	T	R
	S	T	R
3. Miscellaneous Property in Sec.	S	T	R
	S	T	R

Register of Deeds Stamp & File Number

Nov 23 4 28 PM '93  
GENESEE COUNTY  
FLINT MI 48801  
RECORDS  
9.00

4. Lot No. \_\_\_\_\_ Recorded Plat \_\_\_\_\_  
5. Private Claims \_\_\_\_\_

1	A	B	C	D	E	F	G	H	I	J	K	L	M
2	6	5	4	3	2	1							
3													
4	7	8	9	10	11	12							
5													
6	18	17	16	15	14	13							
7													
8	19	20	21	22	23	24							
9													
10	30	29	28	27	26	25							
11													
12	31	32	33	34	35	36							
13													

I, Jack N. Owens, in a field survey on Aug. 3 19 93, do hereby certify that under requirements of P.A. 74, Michigan P.A. of 1970, the corner points mentioned in lines 1 and 2 above were in conformance with regulations and rules therefore as required in the current manual of survey instructions of the United States Department of the Interior, Bureau of Land Management or by a decree of a Court of Law and/or that the corner points mentioned in lines 3, 4 and 5 above were in conformance with the rules of the Michigan Board of Land Surveyors or by a Decree of a Court of Law; established, re-established, monumented, re-monumented, recovered, found as expressed below:

NOTE: Not more than 4 corners, all in the same town and range, may be recorded on this certificate.

A. Description of original monument and accessories and/or subsequent restoration:

- 1821, GLO-J. Wampler, D.S. set post 1978, Cert. Sur. L. 2001, P. 168, JSFokens, PS21567
- 1912, GCRC-O. Branch. Fnd stone; no accessories 1979, LCRC L2034, P379, JSFokens, PS21567
- 1928, GCRC-Mt. Morris Rd Plans. Large "+" on stone; 3 accessories 1980, Cert. Sur. L2090, P22, JSFokens, PS21567
- 1966, Rowe Engr., -DTRove, reset nail by collateral evid. c/l rd & 1/4 line fnc; no accessories 1979, LCRC L2034, P275, JSFokens [This is not this cor., erroneous code #]
- 1974, Cert. Sur. L1903, P308, EBHarris PS9431 1986, Cert. Sur. L2279, P475, JNOwens, PS20709
- LCRC L1907, P225, AVKarpisch PS13586 Fnd old PK shaft, reset, lists 4 accessories
- Fnd PK nail, lists 6 accessories 1989, CCRC-Mt. Morris Rd Plans. & 1922 Fnd PK and 4 accessories
- 1990, Cert. Sur. L2396, P977, MLVanRaemdonck, LCRC L2401, P996, PS24622
- Fnd PK/brass tag and 4 accessories

B. Description of corner evidence found and/or method applied in restoring or reestablishing corner:

1993 Fnd 1/2 rered in mon box & 2 accessories I conclude that the corner has long been perpetuated from 1990 LCRC & doesn't seem to have changed since 1928. It has (U. Pole to North @ 48.55' & Pine to NW & always been called the 1/4 cor. to Secs. 4 & 9. The two Pine to NW @ 65.80') recovered accessories predate the 1992 paving and match the Rered set to replace PK in 1952 repaving. Distances and the 1989/1992 plans recovered 2 1979 Distance to C-3=2641.06' (cf=2645' in 1912, LCRC and one 1974 C.S. accessories showing it is the 2645.33' in 1928 & 2641.3' in 1921) same position. I accept it as a faithful and careful restoration of the position of the original corner.

Distance to E-3=2643.02' (cf=2643' in 1912, 2643.23' in 1928 & 2641.3' in 1821)

Angle to S=179°54'18" (cf=179°47' in 1912 & 179°48' in 1928)

Approved by Genesee County Peer Review Group Nov. 4, 1993

C. Description of monument for corner and accessories established to perpetuate locating the position of the corner:

I set the standard Bersten monument (3 1/4" South, 48.55' Fnd nail W fc p. pole & 40.61' & set spk/GCRemon. tag W. fc & 40.61' & set spk/GCRemon. tag W. fc N60W, 65.71' Fnd Kraft Eng. tag SE fc. of 8" Pine & 66.17' & set spk/GCRemon tag SW fc of 8" Pine 850E, 37.62' Chisled V-notch E and new 12" cap N70E, 112.37' Top cntr. new stone NH rnd. rim

Signed by Jack N. Owens  
Surveyor's Michigan License No. 20709

Date Nov. 11, 1993

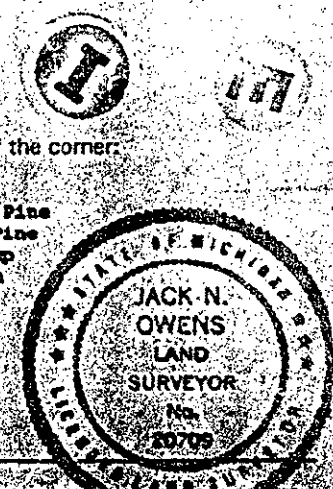

FORM APPROVED BY MICHIGAN STATE BOARD OF SURVEYORS, JANUARY 14, 1979

71055