

Ratified by Peer Group in 1995 REMONUMENTATION PROGRAM

accordance with P.A. 345, 1900 LAND CORNER RECORDATION CERTIFICATE

DEED LIBER 2601 PAGE 280

Co. Rep. Carl Larson Filing Requirement of Act 74, Mich. P.A. 1970

Date 11-15-95

For corners in Genesee (County) Located In: _____ Corner Code # _____

- 1. Public Land Survey T 8N R 5E
- 2. Property Controlling in Section S T R
- 3. Miscellaneous Property in Sec. S T R

I-5
SURVEY & REMONUMENTATION
 APR 29 1996
COMMISSION

RECORDED
 REGISTERED
 GENESSEE COUNTY REGISTER OF DEEDS
 JAN 5 10 42 AM 1996
 1100
 [Handwritten signature]

Register of Deeds Stamp & File Number

- 4. Lot No. _____, Recorded Plat _____
- 5. Private Claims _____

	A	B	C	D	E	F	G	H	I	J	K	L	M
1													
2	6	5	4	3	2	1							
3													
4	7	8	9	10	11	12							
5													
6	18	17	16	15	14	13							
7													
8	19	20	21	22	23	24							
9													
10	30	29	28	27	26	25							
11													
12	31	32	33	34	35	36							
13													

I, Jack N. Owens, Prof. Surveyor, in a field survey on September 26, 1995, do hereby certify that under requirements of P.A. 74, Michigan P.A. of 1970, the corner points mentioned in lines 1 and 2 above were in conformance with regulations and rules therefore as required in the current manual of survey instructions of the United States Department of the Interior, Bureau of Land Management or by a decree of a Court of Law and/or that the corner points mentioned in lines 3, 4 and 5 above were in conformance with the rules of the Michigan Board of Land Surveyors or by a Decree of a Court of Law; established, re-established, monumented, re-monumented, recovered, found as expressed below:

NOTE: Not more than 4 corners, all in the same town and range, may be recorded on this certificate.

A. Description of original monument and accessories and/or subsequent restoration:

- 1822 GLO - H. Ball, DS set post and 2 accessories
- 1890 GCRC - Moses Middleton, Co. Sur.; stone & crockery, measured between corners I-5 & J-5, and I-5 & I-4, no accessories.
- 1924 GCRC - Field Notes McKinley Rd, Flushing Twp, Sec. 10; shapely stone, glass & brick and 5 new accessories
- 1929 GCRC - Field Notes, McKinley Rd co #109, Flushing Twp; fnd 18" peaked stone, brick & glass con.(container) and 1 new accessory
- 1969 REI - Field Sketch; mon. box (no description of monument given)
- 1970 REI - Field Sketch; mon. box (no description of monument given)
- 1970 REI - Field Sketch; NW cor. Sec. 14, unable to remove plate used center top
- 1971 Cert surv. L 1810, pgs 727-728, by John M. Budzik PS18982; 1972 Cert. surv. L 1840, p 370, 1973 Cert. surv. L 1877, pgs 179-180, 1974 Cert. surv. L 1889 pgs 520-521, all done by David T. Rowe PS 11192; 1977 Cer. surv. L 1986 pgs 189-190, and 1981 Cert. surv. L 2116, pgs 807-809, both by Jan S. Fokens PS21567; mon. box and 3 new accessories
- 1976 REI - Field Sketch; stone in mon. box, no accessories

(Continued on back)

B. Description of corner evidence found and/or method applied in restoring or reestablishing corner:

1995 Fnd shapely (peaked) stone (type selected by County Surveyors) in mon. box and 1 accessory from 1924 GCRC field notes (12" oak to SSW at 100.9'), and 1 accessory from 1971-1981 cert. surveys (pk nail w/tag in T/P NE at 46.80') and 2 more accessories from 1988 cert. survey (chis "+" rim water MH to NW at 63.05', and chis "+" rim water MH to NW at 38.95')

The distance measured between the corners I-5 & J-5 in 1890 by Moses Middleton, Co. Surveyor, and the distance measured between the same two corners in 1974, 1978, and 1988 by Rowe Engineering, Inc. are very comparable (differing from the 1890 measurement by 0.92', 0.66', and 0.60' respectively). Also, the distance between the corners I-5 & I-4 is nearly identical. I conclude that the stone recovered during the 1995 remonumentation program is the same stone that has been there, and dates back to 1890 in the old County Surveyor notes, and accept the shapely (peaked) stone in a mon. box as a faithful and careful perpetuation of the position of the original corner.

Ratified by Genesee County Peer Group, Nov. 15, 1995.

C. Description of monument for corner and accessories established to perpetuate locating the position of the corner:

ACCESSORIES:

- N35°E 46.73' Fnd pk & disc in SSW fc P/P
- N20°W 63.01' Fnd chis "+" in N rim water MH
- N40°W 38.93' Fnd chis "+" in N rim water MH
- S20°W 101.07' Fnd spike & flg in E fc 30" oak
- West 43.92' Set pk & Genesee Co. tag in S fc P/P
- S30°E 79.04' Set pk & Genesee Co. tag in W fc P/P

I set the standard Bernsten monument SS-A-5-BR-30 (3 1/4" D. brass cap stamped "Genesee County Remonumentation Corner 20709, 1995") with 10" x 2 3/8" O.D. stainless steel tube over Stone & Grouted in mon box.

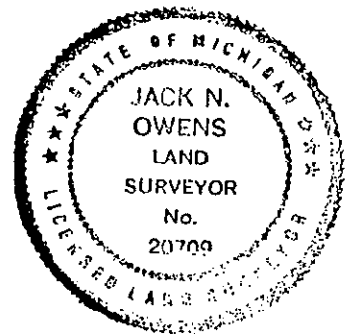

Signed by Jack N. Owens

Date Dec 28 1995

Surveyor's Michigan License No. 20709

SURVEY &
REMONUMENTATION

APR 29 1996

COMMISSION

DEED
NUMBER 2601 PAGE 281

A. Description of original monument and accessories and/or subsequent restoration:

- 1980 REI - Witness card; mon box (stone in mon box held top center and 1 new accessory.
1982 Cert. Survey L 2151 p 597, 1982 Cert. Surv. L 2153 p 386, 1983 Cert. Surv. L 2187 pgs 995-996, all done by an S. Fokens PS21567, 1985 Cert. Surv. L 2236 p 580, 1986 unrecorded survey F-7939-86-8, and 1988 Cert. Surv. L 2333 pgs 766-767, all done by Jack N. Owens PS20709, and finally a 1982 REI witness card; End stone n mon box witnesses to top center of mon box, no new accessories.
1983 REI - field sketch; stone in mon box held top cent. of box, measured between corners I-5 and J-5, no accessories.
1988 REI - Survey Worksheet; no description of corner, measured between corner I-5 and J-5, no accessories.
1988 Cert. Survey L 2342 pgs 37-38 by Paul N. brown PS33134; fnd large (4" x 2") rounded stone in mon. box (held center of mon box) and 2 new accessories.
1989 REI - Field sketch; NE Cor. Sec. 15, rock in mon box, no accessories.
1992 unrecorded survey, Tri-County Surveys, Inc. by Christopher W. Newman PS24607; fnd iron in mon box, no new accessories.