

SURVEY & REMONUMENTATION

MAY 31 2000

SECTION

LAND CORNER RECORDATION CERTIFICATE DEED LIBER 2518 PAGE 933

Filing Requirement of Act 74, Mich. P.A. 1970

(Remonumentation corner under P.A. 345, Michigan P.A. of 1990)

For corners in
Genesee
(County)

Located In: *Franklin*
85

Corner Code #

1. Public Land Survey	T 8N	R 5E	J-3
	T	R	
	T	R	
	T	R	
2. Property Controlling in Section	S	T R	
	S	T R	
3. Miscellaneous Property in Sec.	S	T R	
	S	T R	

74157

RECORDED
REGISTER OF DEEDS
GENESEE COUNTY
FLINT MICHIGAN
JAN 7 3 29 PM '93

Filed & Rec 900
Register of Deeds Stamp & File Number

4. Lot No. _____, Recorded Plat _____
5. Private Claims _____

A	B	C	D	E	F	G	H	I	J	K	L	M
1												
2	6	5	4	3	2	1						
3												
4	7	8	9	10	11	12						
5												
6	18	17	16	15	14	13						
7												
8	19	20	21	22	23	24						
9												
10	30	29	28	27	26	25						
11												
12	31	32	33	34	35	36						
13												

I, Jack N. Owens, Prof. Surveyor, in a field survey on Aug. 5 19 93, do hereby certify that under requirements of P.A. 74, Michigan P.A. of 1970, the corner points mentioned in lines 1 and 2 above were in conformance with regulations and rules therefore as required in the current manual of survey instructions of the United States Department of the Interior, Bureau of Land Management or by a decree of a Court of Law and/or that the corner points mentioned in lines 3, 4 and 5 above were in conformance with the rules of the Michigan Board of Land Surveyors or by a Decree of a Court of Law; established, re-established, monumented, re-monumented, recovered, found as expressed below:

NOTE: Not more than 4 corners, all in the same town and range, may be recorded on this certificate.
1/4 Cor. to Secs. 2 & 11

A. Description of original monument and accessories and/or subsequent restoration:

1821, GLO-R.Ball, Ds. Set post & accessories.
1890, GCSR, M.Middleton, C.S. stake; one accessory.
1920, GCRC-G.H.McVannel, Co.Hwy.Engr. Mt. Morris Rd. plans. Iron pin; shows Maple with RR spike.
1935, GCRC-Mt.Morris Rd plans & Wit.Book. Iron rod; lists 1 accessory from 1920 & 3 new ones.
1969, GCRC-Mt.Morris Rd plans. Fnd. mon. box & 1970 lists 1 accessory from 1935 & 3 new ones.
1972-1984, Cert.Surs.L1827,P299 (1972);L1864,P801(1973), DTRowe,PS11192 and L2030,P153(1978);L2034,P380(1979); L2207,P655(1984),JSFokens,PS21567. Fnd "+" top cntr. mon. box; lists same 1935 accessory, 1 from 1969/70 & 4 new ones.

1990,Cert.Sur. & LCRC L2390,P151-153,PNBrown,PS33134 Set 1/2" rerod/cap 33134 in empty mon. box; lists same 1935 & 1969/70 accessories & 4 new ones; not fnd 4 new 1972-1984 accessories.
1972,Cert.Sur. & L2467,P622,JNOwens,PS20709 Fnd rod & cap in mon. box; lists 5 1990 accessories.

B. Description of corner evidence found and/or method applied in restoring or reestablishing corner:

1993, Gen.Co. Remon. Program
Recovered 1/2" re-rod/cap 33134 in mon. box & 7 accessories from 1935-1992 (includes 36" Oak & 2 houses that match very close).
Distance to I-3 = 2630.68' (39.859 ch.) [cf=2631.00' in 1970, 2631.25' in 1935, 2631.8' in 1920, 39.87 ch. (2631.4') in 1890, 39.875 ch. (2631.8') in 1821, GLO].
Distance to K-3 = 2607.89' (39.514 ch.) [cf = 2607.33' in 1970, 2609.23' in 1935, 2609.5' in 1920, 39.56 ch. (2611.0') in 1890, 39.875 ch. (2631.8') in 1821, GLO].
Angle to S.=181°51'46" (cf=181°51'25" in 1970, 181° 51'30" in 1935; 181°50' in 1920).
I conclude this corner has long been perpetuated, since at least 1890. This corner shows a pattern of recovery & perpetuation by new monumentation by Co. Sur. & GCRC. Since the distance haven't changed in over 100 years, I conclude the unequal half miles

date to the original GLO measurements to set the cor. indicating a 0.50 ch. shortage error in the incremental measurement of the E'ly half mile. The corrected GLO measurements actually measured would be 39.875 for the W 1/2 mile & 39.375 for the E 1/2 mile; meaning the mile was only 79.25 ch. (5230.5') compared to EDM dist. of 5238.57' (73.372 ch.). A proportionate position would be only 8 links different. (e.g. -W 1/2 = x: 79.372 ch.=39.875 GLO; 79.25 ch. GLO; x=39.936 ch. prop. E 1/2 = y: 79.372 ch.=39.375 GLO; 79.25 ch. GLO; y=39.436 ch. prop.) This supports monumented position. I accept the 1/2" rerod as a faithful & careful perpetuation of the position of the original corner.

Ratified by Genesee Peer Group Dec. 1, 1993.

C. Description of monument for corner and accessories established to perpetuate locating the position of the corner:

Accessories:
S45W, 78.77' Fnd nail/tag 11192 NW fc. 36" W. Oak (center of tree=80.0') (1935 accessory)
N55E, 121.99' Fnd SW Cor. house (1970 acc.)
N05E, 69.59' Fnd NW Cor. hse #8259 (DO)
N10W, 42.70' Fnd nail/(disc gone) S. fc. p. pole & 42.94' Set spike/GCRemon. tag E. DO
S45E, 86.09' Set spike/GCRemon. tag SW fc. 20" Pine (& Fnd overgrown nail W. fc.)
South, 29.32' Fnd "+" top cntr. W. end 12" cmp
East, 273.93' Fnd pk on sec. line

I set the standard Bersten monument SS-A-5-BR-30 (3 1/4" d. brass cap stamped "Genesee County Remonumentation Corner, 20709, 1993" with 24" x 2 3/8" O.D. stainless steel tab) over 1/2" rerod/cap #33134 in mon. box in c/1 pavement.

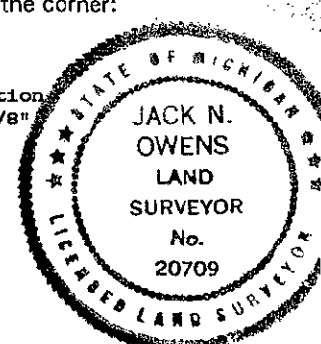

Signed by *Jack N. Owens*

Date Dec. 6, 1993

Surveyor's Michigan License No. 20709

94