

SURVEY & REMONUMENTATION

MAY 31 2000

LAND CORNER RECORDATION CERTIFICATE

Filing Requirement of Act 74, Mich. P.A. 1970

2522 PAGE

84

SECTION (Remonumentation corner under P.A. 345, Michigan P.A. of 1990)

For corners in
Genesee
(County)

Located In:

Corner Code #

Flushing Twp

- 1. Public Land Survey T 8N R 5E L-3
- T R
- T R
- T R
- 2. Property Controlling S T R
- in Section S T R
- 3. Miscellaneous S T R
- Property in Sec. S T R
- 4. Lot No. _____, Recorded Plat _____
- 5. Private Claims _____

RECORDED
REGISTERED
JUN 6 8 02 AM '94
GENESEE COUNTY
FLINT MICHIGAN

Register of Deeds Stamp & File Number

H 900 FILED & RECORDED

1	A	B	C	D	E	F	G	H	I	J	K	L	M
2	6	5	4	3	2	1							
3													
4	7	8	9	10	11	12							
5													
6	18	17	16	15	14	13							
7													
8	19	20	21	22	23	24							
9													
10	30	29	28	27	26	25							
11													
12	31	32	33	34	35	36							
13													

I, Jack N. Owens, Prof. Surveyor, in a field survey on August 5 19 93, do hereby certify that under requirements of P.A. 74, Michigan P.A. of 1970, the corner points mentioned in lines 1 and 2 above were in conformance with regulations and rules therefore as required in the current manual of survey instructions of the United States Department of the Interior, Bureau of Land Management or by a decree of a Court of Law and/or that the corner points mentioned in lines 3, 4 and 5 above were in conformance with the rules of the Michigan Board of Land Surveyors or by a Decree of a Court of Law, established, re-established, monumented, re-monumented, recovered, found as expressed below:

NOTE: Not more than 4 corners, all in the same town and range, may be recorded on this certificate.

A. Description of original monument and accessories and/or subsequent restoration:
 1821, GLO-H.Ball,D.S. Set post & accessories
 1906, GCSR-WRMiddleton, C.S. Fnd. stone, no accessories or measurements to other cors.
 1920, GCRC-GHMcVannel, Co.Hwy.Engr., Mt. Morris Rd. plans. Identifies as 1/4 cor., not describe, no accessories, on occupied fences.
 1935, GCRC-Mt. Morris Rd. Plans & Wit. Book. 1" sq. iron rod & 7 accessories.
 1969/70, GCRC-Mt. Morris Rd. Plans. Fnd. mon. box, not describe monumentation, list 2 1935 accessories & 1 new one.
 REI Sur. Records-DTRowe, PS11192(1973); Cert. Surv. - L1988, P268(1976), L2003, P716(1978), L2176, P73(1983) & LCRC's-L2034, P373 & 383(1979), JSFokens, PS 21567.

Fnd. 1" sq. iron bar (or sq. head bolt) in mon. box, lists 3 of 1935 accessories & 6 new ones.
 1983, Cert.Sur.-L.2172,P308,MLVanRaendonck, PS24622.
 Fnd. iron in mon. box, lists 1 of 1973 accessories & 3 new ones.
 1993, Cert.Sur.-L2504, P596, JNOWens, PS20709. Fnd 1" sq. bar in mon. box, lists 4 new accessories.

B. Description of corner evidence found and/or method applied in restoring or reestablishing corner:
 1993, Gen. Co. Remon. Program.
 Recovered 1" square bar in mon. box & 8 accessories (18" Hickory & the 2 houses to NE & NW from 1935; W. end CMP from 1983, san. MH's to SE & NE, cor. fnc. post to N. & rero in shoulder to SW from 1993).
 Distance to K-3=2643.75' EDM (cf=2644.10' in 1970; 2644.45' in 1935; 2643.4 in 1920; 2659.8' [40.30 chs.] in 1821, GLO).
 Distance to M-3=2666.12' EDM (cf=2665.57' in 1970, 2666.50' in 1935; 2668.7' in 1920; 2659.8' [40.30 chs.] in 1821, GLO). Total mile constant = 5309.87' EDM (cf 5309.67' in 1970; 5310.95' in 1935; 5312.1' in 1920; 5319.6' [80.60 chs.] in 1821, GLO).
 Angle to S=181°53'33" (cf=181°53'45" in 1970; 181°53'30" in 1935; 181°52' in 1920). These are nearly identical. I conclude the corner has been long perpetuated and doesn't seem to have changed since 1920 at least. The stone recovered in 1906 & the

1920 distances are nearly the same showing it has been long perpetuated. The 1" sq. bar set in 1935 is still in place & 3 1935 accessories were recovered. As with other corners along Mt. Morris Rd., it shows a pattern of recovery by the Co. Sur. & GCRC followed by perpetuation by a new monument and the 1920 paving centering the 20 ft. wide conc. pvmt. on the sec. line making it a good accessory. I accept the 1" sq. bar as a faithful and careful perpetuation of the position of the original corner.

Ratified by Genesee County Peer Group. Dec. 7, 1993

C. Description of monument for corner and accessories established to perpetuate locating the position of the corner:
 Accessories:
 North, 118.86' S. face 18" Hickory (1935 acc.)
 N25E, 91.35' SW cor. conc. fndtn Hse #7260(1935)
 N30W, 96.57' SE cor. Main part Hse #7265(1935)
 N60E, 86.88' W. end 12" CMP (1983)
 S25E, 79.02' Fnd. chis "+" N. rim san. MH (1993)
 N30E, 41.98' DO S. DO
 North, 50.11' S.Fc. cor. post ch-link fnc (1993)
 S45W, 28.73' Fnd 1/2" rero/cap 20709 in shldr.
 S40W, 81.83' Set spike/GCRemon tag W. fc. 10" Basswood

I set the standard Bersten monument SS-A-5-BR-30 (3 1/4" d. brass cap stamped "Genesee County Remonumentation Corner, 20709, 1993" with 24" x 2 3/8" O.D. stainless steel tube) over 1" sq. bar in mon. box 1.8 ft. S. of c/l pavement.

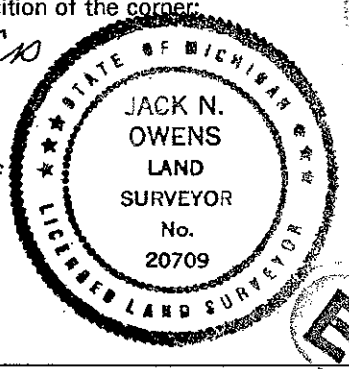

Signed by *Jack N. Owens* 1055
 Surveyor's Michigan License No. 20709

Date Dec. 7, 1993

96