

SURVEY & REMONUMENTATION 1996 REMONUMENTATION PROGRAM
LAND CORNER RECORDATION CERTIFICATE
 Filing Requirement of Act 74, Mich. P.A. 1970

MAY 20 1997

For corners in **COMMISSION**

RECORDED
 RECEIVED
 Dec 30 2 29 PM '96

Genesee Located in: _____ Corner Code # _____
 (County)

1. Public Land Survey T 8N R 7E A-4
 T _____ R _____
 T _____ R _____
 T _____ R _____
2. Property Controlling S _____ T _____ R _____
 In Section S _____ T _____ R _____
3. Miscellaneous S _____ T _____ R _____
 Property In Sec. S _____ T _____ R _____

83699

Register of Deeds Stamp & File Number

*11.00
 [Signature]*

4. Lot No. _____, Recorded Plat _____
 5. Private Claims _____

I, Jack N. Owens, P.S., in a field survey on November 26, 19 96, do hereby certify that under requirements of P.A. 74, Michigan P.A. of 1970, the corner points mentioned in lines 1 and 2 above were in conformance with regulations and rules therefore as required in the current manual of survey instructions of the United States Department of the Interior, Bureau of Land Management or by a decree of a Court of Law and/or that the corner points mentioned in lines 3, 4 and 5 above were in conformance with the rules of the Michigan Board of Land Surveyors or by a Decree of a Court of Law; established, re-established, monumented, re-monumented, recovered, found as expressed below:

NOTE: Not more than 4 corners, all in the same town and range, may be recorded on this certificate.

	A	B	C	D	E	F	G	H	I	J	K	L	M
1													
2	6	5			4			3		2			1
3													
4	7	8			9			10		11			12
5													
6	18	17			16			15		14			13
7													
8	19	20			21			22		23			24
9													
10	30	29			28			27		26			25
11													
12	31	32			33			34		35			36
13													

A. Description of original monument and accessories and/or subsequent restoration:

- Not a GLO corner.
 - 1908, ROD - County Atlas shows S. line Village of Mt. Morris is E-W 1/4 line Sec 7.
 - 1909, ROD - Plat of Brays Addition, PL.4, P.15, C.I. Auten, Surveyor. Not show corner but shows "S. corporation line" at 25.7' S. of plat.
 - 1911, GCRC - N. Saginaw Rd. Plan 798, Geo A. Meade, Co. Surveyor. Shows corner, no description, not identify if A-4 (or M-4, T8N-R6E), no accessories. Cor. at "S. Corporation Line" of Mt. Morris. Also shows Cor. A-5, but actually M-5, T8N-R6E. Measured between corners M-5 & A-4.
 - 1927, ROD - Plat of Orchard Hills, PL.15, P.8, Robert B. McFarlan, Surveyor. Not show corner, no accessories. Shows Corner A-5, actually M-5, T8N-R6E. Labeled S. line Sec. 7 "as occupied" indicating not sure actual line or corner.
- (Cont'd on back)

B. Description of corner evidence found and/or method applied in restoring or reestablishing corner:

Did not find position for corner preserved by any monumentation. Re-established corner position from the 1952 Consumer Power company survey by recovering corners on N. line of Parcel 14 of that survey which matched record very closely. From these I re-establish S. 1/8 corner on W. line Sec. 7 per CPCo survey. Then held their distance of 1302.53 ft. from 1/8 line and set the position on line between Standard Corners A-5 and A-4, T8N-R6E, Mt. Morris Twp. (already ratified this year by Genesee County Peer Review Committee), the Township line as defined by the Standard Corners.

The GLO notes state the closing corners A-3 and A-5 are North of the Standard Corners M-3 and M-5 on the W. line of T8N-R7E. If a so-called "short-cut" procedure had been used - that of taking the mean of the two closing "jog" distances and measuring from the Standard 1/4 Corner of the adjacent township in the same direction as the "jogs" - then Corner A-4 would have been north of Corner M-4. However, the only available records indicate Corner A-4 is south. Closing Corner A-3 was re-established in the 1994 Genesee County Remonumentation Program and was shown to have been south (recorded as such as far back as an 1867 plan in Mt. Morrish, "Plat of Dover") and that the GLO record erred in stating the direction. I conclude, therefore that Closing Corner A-5 was also south and that Corner A-4 was established by the proper procedure of the mean or midpoint of the distance from Corner A-3 to A-5 which placed it south of Corner M-4. I conclude that the corner was probably established by a County Surveyor no longer in office as have many corners. It was most likely long before the County

(Cont'd on back)

C. Description of monument for corner and accessories established to perpetuate locating the position of the corner:

- North 79.26' Cor M-4, T8N-R6E, Fnd 1996 Gen Co Remon Monument
- N89E 367.74' Fnd 1/2" rerod nearly on 1/4 line
- N89E 384.29' Fnd steel fence post, woven wire fence Gen Co Remon
- N20E 141.59' Fnd Gen Co Remon tag SE face P.Pole
- N80E 32.38' Fnd Gen Co Remon tag SW face P.Pole
- S30W 94.14' Fnd 3/4" pipe, NE cor. block
- S35W 64.41' Dn Gould Engr PK/tag in collns

Ratified by Genesee County Peer Group December 11, 1996. I cut hole in pavement and installed a monument box and set the Standard Berntsen SS-A-5 (3 1/4" D. Brass cap stamped Genesee County Remonumentation Corner 20709, 1996") with 3/4" x 5/8" rerod.

Ratified by Peer Group in accordance with P.A. 345, 1996

Co. Rep. [Signature]
 Date 12-11-96
 Date 12-27-96

Signed by Jack N. Owens
 Surveyor's Michigan License No. 20709

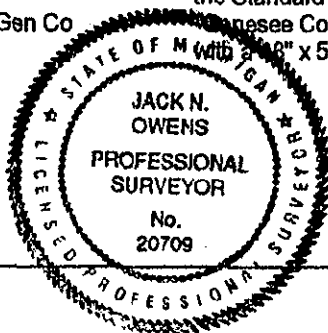

REGISTER OF DEEDS }
 GENESEE COUNTY, MICHIGAN } ss.

I DO HEREBY CERTIFY, That the within and foregoing, is a true copy of the
 Record of a LAND CORNER
 as recorded on Page 257-258 of
 Liber 3437 of MASTER LIBER in the
 Office of Register of Deeds of Genesee County, Michigan. That I have
 compared the same with the said Record and the same is a true copy.

Rebecca Orzoff
 DEPUTY Register of Deeds for Genesee County
 Flint, Michigan 48502

SURVEY &
 REMONUMENTATION

MAY 20 1997

COMMISSION

Issued 12-30-96
 PPGC 1103

A. Continued

- 1939, Gould Engineering - Unrecorded plat of "Churchill Downs", Ora F. Gould, RLS 989. Shows corner, no description, no accessories. S. line is N. line Orchard Hills & N. line is S. village limits Mt. Morris. Gives distance from S. line plat to Corner A-4 along E. R/W Saginaw.
- 1952, CPCo - Survey Dwg P14753-A, Frank A. Fisher, RLS 3102. Shows Corner A-4, no description, no accessories. Describes S. line plat Churchill Downs S'ly 1/8 line Sec. 7 "as occupied". Measured between from S'ly 1/8 line.

B. Continued

Surveyor recovered it in 1911. The County Surveyor records for Sec. 6 to the north, done in 1870, show he used proper procedures for a closing 1/4 corner at a proportionate location in Section 6, an even more complicated situation than Sec. 7. This shows they had detailed knowledge of such procedures well over 100 years ago. The 1911 GCRC record shows there was an established, known position for the corner which is only 3 feet north of the midpoint, a reasonable difference for measurements 110 to 140 years ago. Also, it is interesting to note that Geo. Meade listed himself as County Surveyor, Highway Engineer and Superintendent on the 1911 plans. He definitely knew where to look for section corners and what type of monumentation as well as County Surveyor. Meade is known to have been County Surveyor, starting in 1897, replacing Moses Middleton who became Register of Deeds. Do not know how long he held the office other than he signed the 1911 survey as County Surveyor.

We traversed around Section 7 in a retracement survey as part of our Remonumentation procedures. This clearly indicated the monumented corners along the township line, which are long-known positions for M-3, M-4 and M-5 (an 1867 and two 1916 plats, respectively), are the Standard Corners. The GLO distance from M-5 to M-4 had a half-chain error and the proportionate position based on this conclusion is as follow:

X:40.50ch(GLO):(2680.21' + 2652.24' meas.):(40.50ch + 40.00ch, GLO);
 X:40.50ch(GLO):(5332.50' meas.):(80.50ch, GLO);
 X = 2682.81' proportionate distance.

This is only 2 1/2 feet different from the actual distance of 2680.21' (40.61 ch.). This helps support the conclusion that Corner A-4 was set properly when first established. The distance from Corner A-4 to A-3 is reasonable as well, 2656.83 feet. This shows that the 1939 Gould unrecorded plat of "Churchill Downs" (the name was used by CPCo and is not stated as such on Gould's plat which has no name) had recovered the position. The 1952 CPCo survey was very accurate and tied into their 1950 survey in Section 7 referenced in the Corner Report for Corner C-4 ratified earlier this year. That survey showed a difference of only 0.15 to 0.20 feet per half mile between taped distances compared to our EDM distances and an angle at the SE Corner only 18" different than ours. Therefore, I concluded the position for Corner A-4 could most carefully be re-established from the 1/8 line they surveyed using their distance since it would be less than 0.10 of a foot.

The plat of Orchard Hills is shown since it shows that the "occupied 1/8 line" was long perpetuated. The plat of Brays Addition implied it retraced the E-W 1/4 line but the position would be 40.18 feet north of Corner M-4 or 119.44 feet north of the re-established position of corner A-4. It is not clear what line that plat retraced but it did not have the E-W 1/4 line. I conclude it does not provide any evidence for verifying the location of Corner A-4. The 1911 record shows the plat surveyor didn't have the corner since the County Surveyor had it only two years later.

Lastly, the found 1/2" rod 367.74 feet east of the corner and the W. end of the cyclone fence 16 feet east of it are only 0.6 and 0.7 of a foot N. of the straight line from Corner A-4 to C-4. This supports the conclusion that the position was long known and used in surveys along the E-W 1/4 line. The fence diverges from the 1/4 line, being 4.2 S at 1050 feet E., but is not unreasonable for 1/4 line fences in the late 1800's. I accept the above described position as a careful and faithful re-establishment of the position of the original corner.

Sig
 Sur