

SURVEY & REMONUMENTATION

MASTER LIBER 3437 PAGE 272

MAY 20 1997

COMMISSION

**1996 REMONUMENTATION PROGRAM
LAND CORNER RECORDATION CERTIFICATE**
Filing Requirement of Act 74, Mich. P.A. 1970

GENESEE COUNTY REGISTER

Dec 30 2 29 PM '96

REGISTERED

RECORDED

For corners in

Genesee Located In: Corner Code #
(County)

1. Public Land Survey T 8N R 7E C-5
T _____ R _____
T _____ R _____
T _____ R _____

2. Property Controlling S _____ T _____ R _____
In Section S _____ T _____ R _____

3. Miscellaneous S _____ T _____ R _____
Property in Sec. S _____ T _____ R _____

83616
Register of Deeds Stamp & File Number

Handwritten signature and initials

4. Lot No. _____ Recorded Plat _____
5. Private Claims _____

I, Jack N. Owens, P.S., in a field survey on Sept 23, 19 96, do hereby certify that under requirements of P.A. 74, Michigan P.A. of 1970, the corner points mentioned in lines 1 and 2 above were in conformance with regulations and rules therefore as required in the current manual of survey instructions of the United States Department of the Interior, Bureau of Land Management or by a decree of a Court of Law and/or that the corner points mentioned in lines 3, 4 and 5 above were in conformance with the rules of the Michigan Board of Land Surveyors or by a Decree of a Court of Law; established, re-established, monumented, re-monumented, recovered, found as expressed below:

	A	B	C	D	E	F	G	H	I	J	K	L	M
1													
2		6	5	4	3	2	1						
3													
4		7	8	9	10	11	12						
5													
6		18	17	16	15	14	13						
7													
8		19	20	21	22	23	24						
9													
10		30	29	28	27	26	25						
11													
12		31	32	33	34	35	36						
13													

NOTE: Not more than 4 corners, all in the same town and range, may be recorded on this certificate.

A. Description of original monument and accessories and/or subsequent restoration:

- 1821, GLO - H. Ball DS, set post and 2 accessories.
- 1924, GCRC - Field notes & plans; stone, measured between corners C-6 & C-5, and 3 new accessories
- 1934, GCRC - Field notes & plans; no description of monument, measured between corners B-5 & C-5, and D-5 & C-5, no accessories
- 1920's-1930's, GCRC - witnesses; stone, and 7 new accessories
- 1950, CPCo - Survey; Fnd stone & iron, and 2 new accessories, Frank A. Fisher, RLS 3102, measured between corners B-5, C-5 & C-4.
- 1955, CPCo - Survey; Fnd stone & iron pipe, and 1 new accessory (cont'd on back)

B. Description of corner evidence found and/or method applied in restoring or reestablishing corner:

1996 - Fnd 1/2' rod in monument box, and 1 accessory from 1920's - 1930's (P/P to NE at 64.5'), and 4 accessories from 1962 (tag in P/P to NW at 59.32', and tag in P/P to NE at 64.66', and tag in P/P to SE at 58.57', and tag in P/P to SW at 62.20').

In 1924 the GCRC while performing a survey noted a stone at C-5. At that time they referenced the leg of a steel tower to the SW at 49.67'. The GCRC was once again at C-5 ten years later when in 1934 they measured between the corners B-5 and C-5 2659.87' (40.30 ch.), and D-5 and C-5 2683.06' (40.65 ch.). We also have witnesses that were more than likely taken by the Road Commission surveyors during their 1934 survey in which they report still finding a stone. Once again they referenced the leg of the tower along with numerous other witnesses including a power pole to the NE at 64.5' and a 26" Oak to the SW at 61.95'. In both 1950 & 1955 CPCo while performing surveys reported finding a stone & iron (50), or a stone & iron pipe (55). Both Consumers surveys reference the Ely leg of the same tower to the SW at 49.7'. also noteworthy is the fact that the 1/2 mile distance between the corners B-5 and C-5 as shown in the 1955 Consumers survey only differs by 1.14' or 2 links from the 1934 measurement by the GCRC. Once again in 1960 the GCRC in a survey along Stanley Road measured the (cont'd on back)

C. Description of monument for corner and accessories established to perpetuate locating the position of the corner:

N20W 59.30' Fnd Nail & Gould Eng. Tag in SE face Guy Pole
N40E 64.77' Fnd Nail & Gould Eng. Tag in SW face P/P
S30W 62.19' Fnd Nail & Gould Eng. Tag in NE face P/P
S30E 58.53' Fnd Nail & Tag in NW face Guy Pole

Ratified by Genesee County Peer Group October 23, 1996.
I set the Standard Berntsen Monument SS-A-5-BR-30 (3 1/4" D. brass cap stamped "Genesee County Remonumentation Corner 20709, 1996") with 30" x 2 3/8" O.D. Stainless steel tube over the (cont'd on back)

Ratified by Peer Group in accordance with P.A. 345, 1990

Co. Rep. Carl Larson
Date 10-23-96

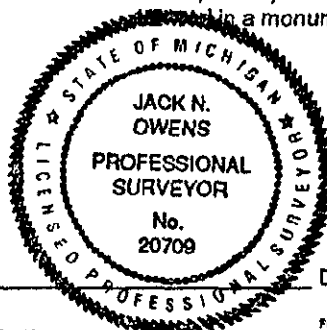

Signed by Jack N. Owens
Surveyor's Michigan License No. 20709

Date 12-26-96

REGISTER OF DEEDS }
GENESEE COUNTY, MICHIGAN } SS.

I DO HEREBY CERTIFY, That the within and foregoing, is a true copy of the
Record of a LAND CORNER
as recorded on Page 272-273 of
Liber 3437 of MASTER LIBER in the
Office of Register of Deeds of Genesee County, Michigan. That I have
compared the same with the said Record and the same is a true copy.

Richard M. [Signature]
DEPUTY Register of Deeds for Genesee County
Flint, Michigan 48502

Issued 12-30-96
PPGC 1103

- A. **Continued**
1960, GCRC - Field notes; no description of monument, measured between corners D-5 & C-5, no accessories
1962, Gould Engineering - Witnesses; Fnd old iron 4' deep, set rod, and 4 new accessories
1968, CPCo - Survey; mon box, no accessories
1975 - 1988, Cert. Surveys & LCRC - Fnd 1/2" rod in mon box; L.1929, Pgs 357-358 by Lyal H. Howison RLS 1840, L.2146, P.776 by
A.F. Miller RLS 12021, L.2328, P.307 by Carl H. Carlson RLS 9189, no new accessories
1982, Gould Engineering - Witnesses; Fnd 1/2" rod in mon. box, no new accessories.
1989, GCRC - Road plans; existing monument box, measured between corners C-4 & C-5, no accessories

B. **Continued**
distance between the corners D-5 and C-5 at which time they measured 2682.67' (40.65 ch.). This 1/2 mile measurement only differs by 0.39' from the 1934 GCRC measurement. Consumers Power Company measured 2658.73' from B-5 to C-5, only 0.16' longer than my EDM distance; 2669.00' from C-5 to C-4, only 0.20' shorter than my EDM distance; and their angle at C-5 was only 18" different. All show the corners have not moved. In 1962 while performing a survey Gould Engineering in their witnesses reported finding an "old" iron 4' deep, and raised the position with a rod. I believe that the iron found in 1962 by Gould was the same iron or iron pipe found with a stone in the 1950 and 1955 CPCo surveys. The reason that the iron was so deep can be explained by the road being graded in preparation for pavement being laid down, which explains why the GCRC would have been there working 2 years previous. After grading the position of the "old" iron with a rod Gould referenced the rod with 6 new witnesses, 4 of which we found during our field inspection of C-5. Two of Gould's 1962 witnesses are to the same objects used by the GCRC in 1934 (P/P to Ne at 64.5' vs. 64.66' & an Oak to SW at 61.95' vs. 61.88'). The power pole to the NE and the oak tree to the SW demonstrate that the "old" iron found 4' deep, raised with a rod is in the same relative position as the stone found in the 1934 GCRC survey, which was probably set by a County Surveyor during the late 1800's although no record of a County Surveyor ever visiting that corner exists. The rod set by Gould Engineering in 1962 was later described as a 1/2" rod in a Monument cover or box, which is what we recovered during our field inspection of C-5. The old Gould witnesses set in 1962 that we found demonstrate that the position of the found 1/2" rod in a monument box is in the same position as the rod set by Gould Engineering after raising the position of the found "old" iron 4' deep which through common witnesses can be said to be in the same location as the stone found in 1934 by the Road Commission, which was most likely set during the late 1800's by a County Surveyor. I accept the position of the 1/2" rod in a monument box as a careful and faithful perpetuation of the position of the original corner.

SURVEY &
REMONUMENTATION

MAY 20 1997

COMMISSION