

Ratified by Peer Group in accordance with P.A. 345, 1990

1996 REMONUMENTATION PROGRAM

Co. Rep. Jack N. Owens  
Date 12-4-96

LAND CORNER RECORDATION CERTIFICATE  
Filing Requirement of Act 74, Mich. P.A. 1970

RECORDED  
DEC 30 2 29 PM '96  
REGISTERED  
GENESEE COUNTY  
SURVEYOR  
MAY 20 1987  
COMMISSION

For corners in

Genesee (County)	Located In:	Corner Code #
1. Public Land Survey	T <u>8N</u> R <u>7E</u> <u>I-5</u>	
	T _____ R _____	
	T _____ R _____	
	T _____ R _____	
2. Property Controlling in Section	S _____ T _____ R _____	
	S _____ T _____ R _____	
3. Miscellaneous Property in Sec.	S _____ T _____ R _____	
	S _____ T _____ R _____	

83655  
Register of Deeds Stamp & File Number

*Handwritten: 11.10 filed for*

- 4. Lot No. \_\_\_\_\_ Recorded Plat \_\_\_\_\_
- 5. Private Claims \_\_\_\_\_

I, Jack N. Owens, P.S., in a field survey on September 19 1996, do hereby certify that under requirements of P.A. 74, Michigan P.A. of 1970, the corner points mentioned in lines 1 and 2 above were in conformance with regulations and rules therefore as required in the current manual of survey instructions of the United States Department of the Interior, Bureau of Land Management or by a decree of a Court of Law and/or that the corner points mentioned in lines 3, 4 and 5 above were in conformance with the rules of the Michigan Board of Land Surveyors or by a Decree of a Court of Law; established, re-established, monumented, re-monumented, recovered, found as expressed below.

NOTE: Not more than 4 corners, all in the same town and range, may be recorded on this certificate.

	A	B	C	D	E	F	G	H	I	J	K	L	M
1													
2	6	5	4	3	2	1							
3													
4	7	8	9	10	11	12							
5													
6	18	17	16	15	14	13							
7													
8	19	20	21	22	23	24							
9													
10	30	29	28	27	26	25							
11													
12	31	32	33	34	35	36							
13													

A. Description of original monument and accessories and/or subsequent restoration:

- 1821, GLO - H. Ball DS, set post, measured between corners and 2 accessories.
- 1871, Genesee County Surveyor Records - S.R. Billings SC, Fnd stake & brick, US corner, measured between corners I-5 & I-6 and I-5 & J-5, and no accessories.
- 1912, GCRC - Plans, Fnd stone, measured between corners I-5 & I-6 and no accessories.
- 1920, GCRC - Field notes, Fnd stone & brick and 4 accessories.
- 1939, GCRC - Plans & field notes, no description of monument, measured between corners I-5 & I-7, I-5 & I-6 a I-5 & I-4 and no accessories.

(Cont'd on back)

B. Description of corner evidence found and/or method applied in restoring or reestablishing corner:

1996 - Fnd 3/4" rod in mon. Box, and no accessories.

In 1871, S.R. Billings C.S. reported having a stake & brick monumenting the corner I-5. He also indicated in his notes that he had the US (G.L.O.) Corner, it is unclear as to what evidence he had to determine this (possibly bearing trees). S.R. Billings measured between the corners I-6 and I-5, and J-5 & I-5. Mr. Billings measurements were 20 links and 3 links, respectively, from what the G.L.O. claimed to have measured. Also worth mentioning is that S.R. Billings claimed to have found the original G.L.O. (US) corners at I-6 and J-5 as well. In 1912, the GCRC had found a stone at I-5. The route description on the plans for what is now Genesee Road South of Stanley Road says that the first course from the stone at I-5 is South, 2640' to I-6 which would still only be 20 links different than what S.R. Billings measured 40 years earlier. In a 1920 survey by the GCRC the object found monumenting I-5 was a stone & brick. Four (4) witnesses were noted one of which being a Sycamore tree to the NE which was used until 1972. In 1939 the GCRC measured between the corners I-6 and I-5, and I-4 and I-5. The distance they measured between I-6 and I-5 was 1.45' (2 links) different than the 1912 GCRC, 18 links different than the 1871 County Surveyor, and 2 links different than the G.L.O. measurement. The distance they measured between I-4 and I-5 was 5 links different than what the G.L.O. measured. We measured this same 1/2 mile as part of our field procedure for this project as 2635.62' (39.93 ch.) which is only 2 links different than the 1939 GCRC and 7 links from what the G.L.O. had measured. IN 1945, George H. McKonnie, PE #662, recorded the plat of "Capt's Acres". Recorded on this plat was the 1/2 mile measurement between the corners I-6 and I-5. This measurement was 0.65' (1 link) different than the 1939 GCRC, 0.80' (1 link) different than the 1912 GCRC, 19 links different than the 1871 County Surveyor, and 1 link different than the G.L.O. measurement. In a 1972 survey by the GCRC a 3/4" iron pin in a monument box was found at I-5. This is the same object we recovered in the field for this project. Four (4) witnesses were noted (none of which we were able to recover) including the same Sycamore tree (now removed) to the NE that first appeared in the 1920 GCRC field notes. The 1972 Road Commission surveyors measured between the corners I-7 & I-5, and I-6 & I-5, and I-4 & I-5. They measured 5281.58' (80.02 ch.) between I-7 and I-5, which was

(Cont'd on back)

C. Description of monument for corner and accessories established to perpetuate locating the position of the corner:

- N40E 82.22' Set spike & Genesee County tag in NW face cor. Split rail fence post
  - N60W 75.16' Set spike & Genesee County tag in NE face 14" Aspen
  - S45W 56.40' Set Pk & Genesee County tag in NW face P/P
  - S60E 64.00' Set Pk & Genesee County tag in NE face P/P
- Ratified by Genesee County Peer Group Dec 4, 1996  
I set the Standard Berntsen Monument SS-A-5-BR-30 (3 1/4" D. brass cap stamped "Genesee County Remonumentation Corner 20709, 1996") with 30 x 2 3/8" O.D. stainless steel tube on top of 1" rod in mon. box.

Signed by Jack N. Owens  
Surveyor's Michigan License No. 20709

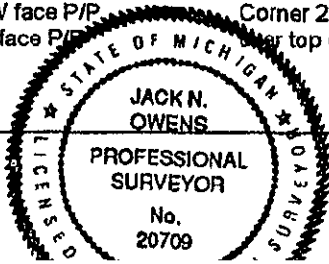

Date 12-27-96

SURVEY & REMONUMENT

MAY 20 1987

A. Continued

- 1945, Recorded plat - L.20, P.6 - by George H. McKonnel, PE 662, no description of monument, measured between corners I-5 & I-6, and no accessories.
- 1955, Recorded plat - L.27, P.75 - by Richard C. West, RLS 6100, no description of monument, and no accessories.
- 1970, GCRC - Bridge Plans, by Ayres, Lewis, Norris & May, no description of monument, and no accessories.
- 1972, GCRC - Plans & field notes, fnd 3/4" iron pin in monument box, measured between corners I-5 & I-7, I-5 & I-6, and I-5 & I-4, and 3 accessories.
- 1972, Cert. Survey - L.1816, Pgs.67-69, by John M. Budzick RLS 18982, fnd stone, and no accessories.
- 1977, LCRC - L.1977, P.808, by David T. Rowe 11192, fnd stone, and no accessories.

B. Continued

1 link different than the 1939 GCRC measurement, and 2 links different than the GLO. They measured 2640.51' (40.0 ch.) between I-6 & I-5, which was 0.29' different than the 1945 measurement by George H. McKonnel, 0.06' different than the 1939 GCRC, 0.51' different than the 1912 GCRC; 19 links different than the 1871 County surveyor and 1 link different than the GLO. The measurement that the 1972 GCRC observed between the corners I-4 and I-5 appears to be erroneous. We measured 2635.62' (39.93 ch.) between the corners I-4 and I-5. This measurement differs from the 1972 GCRC by 49.77', but only differs by 0.09' from the 1939 GCRC, and by only 7 links from the GLO. In 1972 a certified survey was recorded by John M. Budzick RLS #18982, and in 1977 an LCRC was recorded by David T. Rowe RLS #11192. On both of these documents were the 1920 GCRC witnesses, in which the object monumenting the corner was a stone. These witnesses appear to have been copied from the GCRC witness book. Upon review of the above stated evidence, I conclude that the 3/4" rod in a monument box we recovered is the same 3/4" iron pin in a monument box that was found in 1972 by the GCRC, and by similar measurements between I-5 and the surrounding corners appears to have remained in the same position since it was originally set by the GLO. I accept the position of the 3/4" rod in a monument box as a careful and faithful perpetuation of the position of the original corner.

REGISTER OF DEEDS } ss.  
GENESEE COUNTY, MICHIGAN }

I DO HEREBY CERTIFY, That the within and foregoing, is a true copy of the Record of a LAND CORNER as recorded on Page..... 290-291..... of Liber..... 3437..... of MASTER LIBER..... in the Office of Register of Deeds of Genesee County, Michigan. That I have compared the same with the said Record and the same is a true copy.

*Richard M. ...*  
DEPUTY Register of Deeds for Genesee County  
Flint, Michigan 48502