

SURVEY & REMONUMENTATION

MASTER LIBER 4355 PAGE 113

MAR 23 2000

**1999 GENESEE COUNTY REMONUMENTATION PROGRAM
LAND CORNER RECORDATION CERTIFICATE
Filing Requirement of Act 74, Mich. P.A. 1970**

SECTION

For corners in

Genesee (County)	Located In: Richfield	Corner Code #
1. Public Land Survey	T8N R8E	E-6
	T R	
	T R	
	T R	
2. Property Controlling in Section	S T R	
	S T R	
3. Miscellaneous Property in Sec.	S T R	
	S T R	
4. Lot No. _____, Recorded Plat _____		
5. Private Claims _____		

GENESEE COUNTY REGISTER OF DEEDS
DEC 21 3 10 PM '99
109081
Filed & Rec 900
Register of Deeds Stamp & File Number

I, Kevin B. Cleaver, in a field survey on December 1, 1999, do hereby state that under requirements of P.A. 74, Michigan P.A. of 1970, the corner points mentioned in lines 1 and 2 above were in conformance with regulations and rules therefore as required in the current manual of survey instructions of the United States Department of the Interior, Bureau of Land Management or by a decree of a Court of Law and/or that the corner points mentioned in lines 3, 4 and 5 above were in conformance with the rules of the Michigan Board of Land Surveyors or by a Decree of a Court of Law; established, re-established, monumented, recovered, found as expressed below:

1	A	B	C	D	E	F	G	H	I	J	K	L	M
2		6		5		4		3		2		1	
3													
4		7		8		9		10		11		12	
5													
6		13		17		16		15		14		13	
7													
8		19		20		21		22		23		24	
9													
10		30		29		28		27		26		25	
11													
12		31		32		33		34		35		36	
13													

NOTE: Not more than 2 corners, all in the same town and range, may be recorded on this certificate.

A. Description of original monument and accessories and/or subsequent restoration:

- 1822 General Land Office (GLO) fieldnotes: set post w/two accessories.
- Undated Genesee County Road Commission Records (GCRC): corner post w/four accessories.
- Undated GCRC Records: iron-pin w/three accessories.
- 1935 GCRC Plans: half-mile measurement.
- 4/20/1974 Land Corner Recordation Certificate (LCRC), Liber 1891, Page 389: pipe w/three accessories.
- 4/29/1974 P.A. 132 Certified Survey, Liber 1891, Page 388: pipe w/three accessories, measurements to section corner, and half-mile measurement.
- Undated Rowe Incorporated Records: iron-pin w/three accessories.
- 11/7/1990 P.A. 132 Certified Survey, Liber 2425, Page 143: 1.5" pipe w/three accessories

B. Description of corner evidence found and/or method applied in restoring or reestablishing corner:

- GLO corner and accessories not found.
- Recovered corner from undated GCRC records.
- Recovered corner and three accessories from undated GCRC records.
- Confirmed within acceptable tolerance 1935 GCRC half-mile measurement.
- Recovered corner and three accessories from 1974 LCRC
- Recovered corner, three accessories, and confirmed half-mile distance and measurements to section corner from 1974 certified survey.
- Recovered corner and three accessories from undated Rowe Incorporated records.
- Recovered corner and three accessories from 1990 certified survey.

The monument found was ratified by the Genesee County Remonumentation Peer Review Committee on November 24, 1999.

C. Description of monument for corner and accessories established to perpetuate locating the position of the corner:

Set in concrete the standard Bernsten monument SS-A-5BR-30 with 3 1/4" brass cap stamped "Genesee County Remonumentation Ratified by Peer Group in accordance with P.A. 345, 1990

- S 34° E 43.55' set Genesee County witness tag in northeast face 18" pine
- S 85° E 56.06' set Genesee County witness tag in north face 30" oak
- N 18° E 68.35' set Genesee County witness tag in west face 12" pine
- N 40° W 78.01' set Genesee County witness tag in southwest face power pole
- S 78° W 56.98' set Genesee County witness tag in southeast face power pole

Co. Rep. Callahan
Date 11-24-99

Signed by Kevin B. Cleaver
Surveyor's Michigan License No. _____

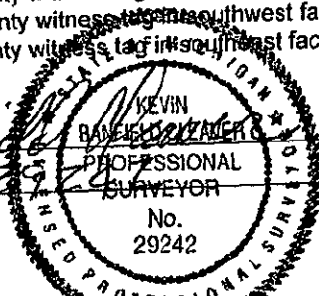

Date 12/20/99