

SURVEY & REMONUMENTATION

MAR 23 2000

SECTION

**1999 GENESEE COUNTY REMONUMENTATION PROGRAM
LAND CORNER RECORDATION CERTIFICATE
Filing Requirement of Act 74, Mich. P.A. 1970**

MASTER LIBER 4355 PAGE 108

Dec 21 3 10 PM '99

109076

Filed & Rec 9.00
Register of Deeds Stamp & File Number

For corners in

Genesee <small>(County)</small>	Located In: Richfield	Corner Code #
1. Public Land Survey	T8N R8E	1-6
	T R	
	T R	
	T R	
2. Property Controlling in Section	S T R	
	S T R	
3. Miscellaneous Property in Sec.	S T R	
	S T R	
4. Lot No. _____, Recorded Plat _____		
5. Private Claims _____		

A	B	C	D	E	F	G	H	I	J	K	L	M
1												
2	6		5		4		3		2		1	
3												
4	7		8		9		10		11		12	
5												
6	18		17		16		15		14		13	
7												
8	19		20		21		22		23		24	
9												
10	30		29		28		27		26		25	
11												
12	31		32		33		34		35		36	
13												

I, Kevin B. Cleaver, in a field survey on December 1, 1999, do hereby state that under requirements of P.A. 74, Michigan P.A. of 1970, the corner points mentioned in lines 1 and 2 above were in conformance with regulations and rules therefore as required in the current manual of survey instructions of the United States Department of the Interior, Bureau of Land Management or by a decree of a Court of Law and/or that the corner points mentioned in lines 3, 4 and 5 above were in conformance with the rules of the Michigan Board of Land Surveyors or by a Decree of a Court of Law; established, re-established, monumented, recovered, found as expressed below:

NOTE: Not more than 2 corners, all in the same town and range, may be recorded on this certificate.

- A. Description of original monument and accessories and/or subsequent restoration:**
- 1822 General Land Office (GLO): set post w/two accessories
 - 9/21/1847 Genesee County Survey Notes: measurement to 1/16th line
 - Undated Genesee County Road Commission (GCRC) Plans: half-mile measurement
 - 8/5/1965 Consumers Power Survey Drawing: T-Iron w/three accessories and half-mile measurements
 - Undated GCRC Records: T-Iron w/three accessories
 - 3/1972 Gould Engineering, Inc. (GEI) Records: T-Iron in error, set rod w/five accessories
 - 2/20/1974 P.A. 132 Certified Survey, Liber 1895, Pages 582-585: set T-Iron w/three accessories and half-mile measurement
 - 5/15/1974 P.A. 132 Certified Survey, Liber 1890, Pages 616-617: unspecified w/four accessories, half mile measurement
 - 7/19/1974 P.A. 132 Certified Survey, Liber 1898, Page 128: set T-Iron w/three accessories, half-mile measurement and measurements to section corner
 - 2/10/1975 Land Corner Recordation Certificate (LCRC), Liber 1997, Page 209: rod w/four accessories
 - 1/1978 Rowe Incorporated Records: T-Iron w/three accessories
 - 10/27/1981 LCRC, Liber 2125, Page 124: rod w/four accessories
 - 9/28/1982 LCRC, Liber 2205, Page 356: re-rod w/two accessories
 - 9/28/1982 LCRC, Liber 2276, Page 379: re-rod w/two accessories
 - 12/19/1985 Flint Surveying and Engineering survey: Unspecified, measurement to section corner
- B. Description of corner evidence found and/or method applied in restoring or reestablishing corner:**
- GLO corner and accessories not found.
 - Confirmed measurement to 1/16th line (half-mile split) from 1847 Genesee County Survey notes.
 - Confirmed within acceptable tolerance undated GCRC half-mile measurement.
 - Unable to recover corner and accessories; confirmed half-mile measurement from 1965 drawing.
 - Unable to recover corner and accessories from undated GCRC records..
 - Recovered corner and one accessory from 1972 GEI records.
 - Unable to recover corner and accessories from 2/20/1974 certified survey.
 - Recovered corner, one accessory and confirmed half-mile distance and measurements to section corner from 5/15/1974 certified survey.
 - Unable to recover corner and accessories from 1974 LCRC.
 - Recovered corner and one accessory from 1975 LCRC.
 - Unable to recover corner and accessories form 1978 records.
 - Recovered corner and one accessory from 1981 LCRC.
 - Recovered corner and one accessory from 1982 LCRC.
 - Recovered corner and one accessory from 1982 LCRC.
 - Confirmed measurement to section corner from 1985 survey.
 - This monument found was ratified by the Genesee County Remonumentation Peer Review Committee on November 24, 1999.
- C. Description of monument for corner and accessories established to perpetuate locating the position of the corner:**
- Set the standard Bernsten monument SS-A-5BR-30 with 3 1/4" brass cap stamped "Genesee County Remonumentation Corner, 1999, #29242" over re-rod.
 - N 61° E 35.81' set Genesee County witness tag in south face 18" maple
 - S 85° E 147.44' set Genesee County witness tag in north face power pole
 - S 36° W 60.81' set Genesee County witness tag in south face 9" elm
 - N 88° W 51.02' set Genesee County witness tag in north face power pole

RATIFIED BY PEER REVIEW COMMITTEE IN ACCORDANCE WITH P.A. 345, 1990
Co. Rep. Paul Carlson
Date 11-24-99

Signed by Kevin B. Cleaver
Surveyor's Michigan License No. _____

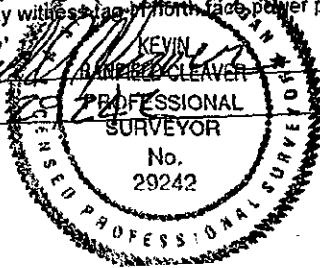

Date 12/20/99